

City of Surrey
PLANNING & DEVELOPMENT REPORT

File: 7916-0127-00

Planning Report Date: June 13, 2016

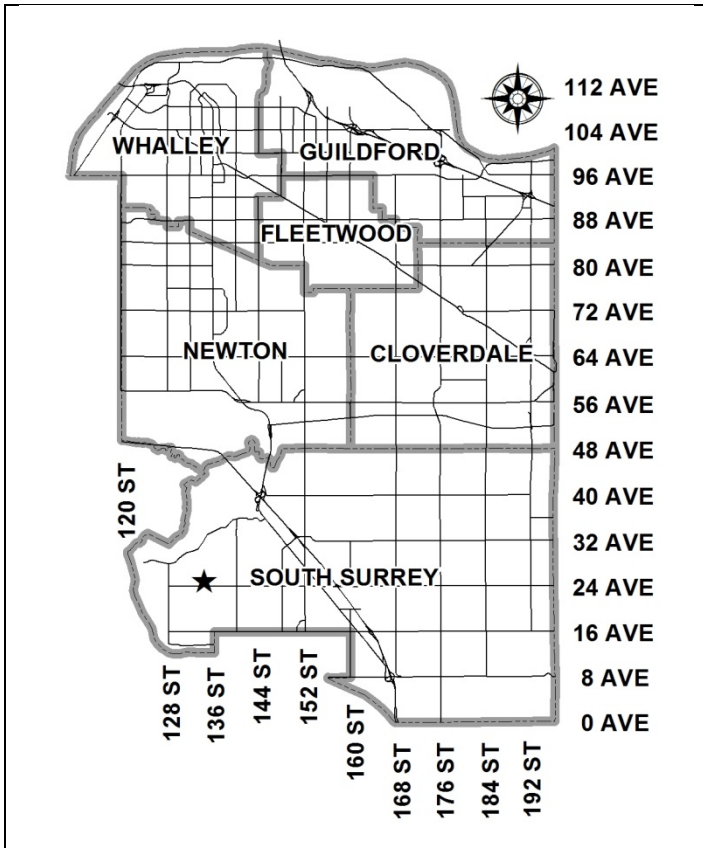

PROPOSAL:

- Terminate Land Use Contract No. 483

to permit the existing underlying RA-G Zone to come into effect.

LOCATION: 25 Avenue between 134 Street and 136 Street

LUC AND UNDERLYING ZONING: LUC No. 483
 (RA-G Zone underlying)

OCP DESIGNATION: Suburban

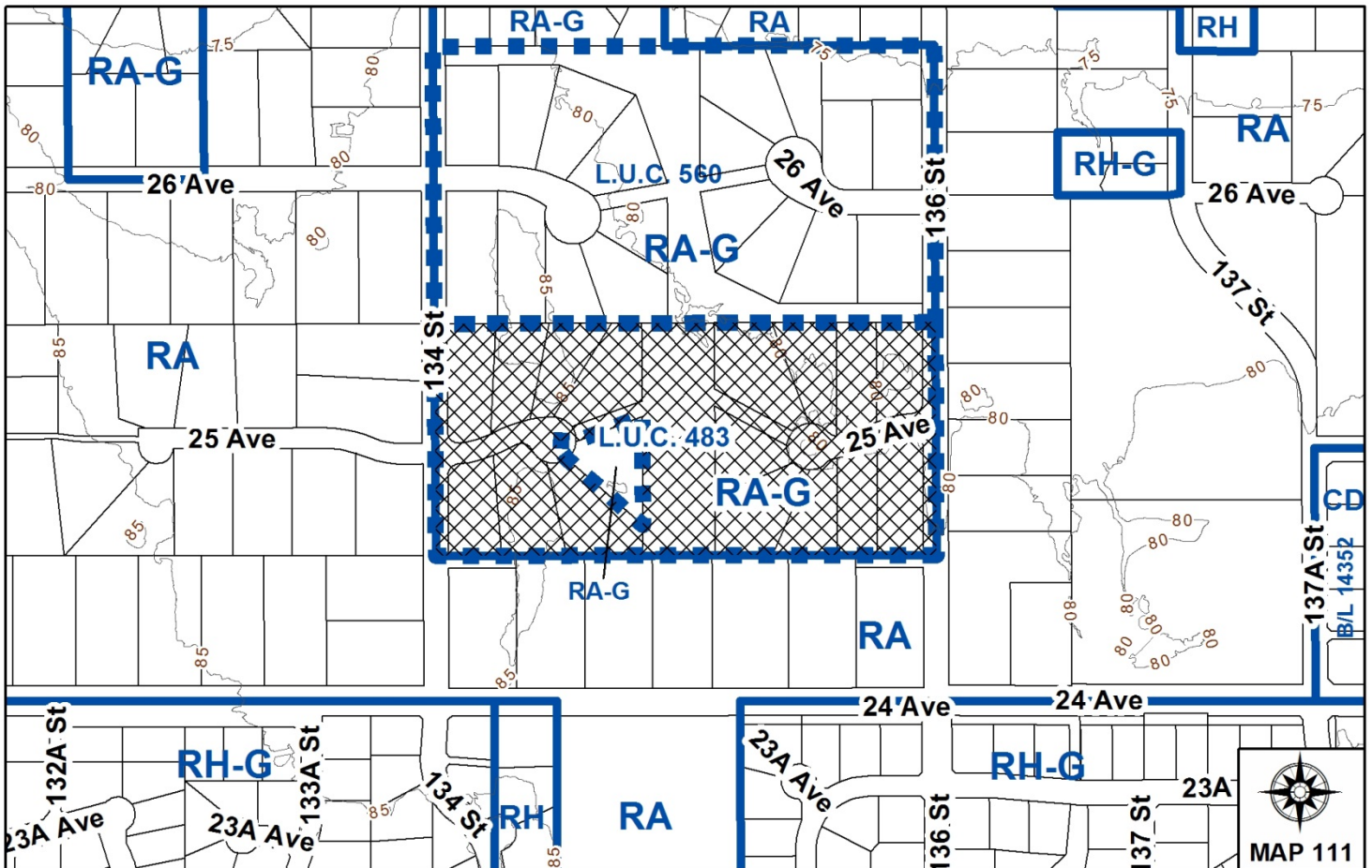

RECOMMENDATION SUMMARY

- By-law Introduction and set date for Public Hearing to terminate LUC No. 483.

DEVIATION FROM PLANS, POLICIES OR REGULATIONS

- None

RATIONALE OF RECOMMENDATION

- In 2014, the Provincial Government adopted changes to the *Local Government Act* that terminate all Land Use Contracts (LUCs) in the Province on June 30, 2024. However, the legislation also permits municipalities to undertake early termination of LUCs in advance of 2024.
- On June 15, 2015, City Council endorsed the recommendations in Corporate Report No. R122, which outlined a process with respect to the early termination of LUCs in Surrey.
- In accordance with recent legislative changes, the LUC Termination By-law must include an effective date that is no less than one year from adoption of the by-law, resulting in a grace period.
- City staff are now moving forward with LUCs to be terminated, in accordance with the approved process described in Corporate Report No. R122, which prioritizes based on business development or the simplicity of the termination.
- LUC No. 483 was adopted by By-law No. 5664, on January 8, 1979.
- LUC No. 483 permits single family dwelling uses and uses customarily accessory thereto.
- Once LUC No. 483 is terminated and the one-year grace period ends, the current underlying “Acreage Residential Gross Density Zone (RA-G)” will come into effect and will regulate the subject lots.
- It is now in order for LUC No. 483 to be considered for early termination.

RECOMMENDATION

The Planning & Development Department recommends that a By-law be introduced to terminate Land Use Contract No. 483 and a date be set for Public Hearing.

BACKGROUND

- In the early 1970s the Provincial Government adopted changes to the *Municipal Act* (now called the *Local Government Act*) that allowed local governments to enter into Land Use Contracts (LUCs) with land owners and/or developers that incorporated zoning, development control and servicing issues into one document. As a result, on lands within an LUC, the LUC became the governing land use control and, in some instances, the subdivision and development control as well.
- Although LUCs are an agreement between the City and land owners/and developers, all LUCs were adopted by By-law. The first LUC in Surrey was adopted by City Council by By-law on August 7, 1972.
- In the late 1970s the Provincial Government adopted changes to the *Municipal Act* (now called the *Local Government Act*), eliminating the ability of municipalities to enter into LUCs.
- Approximately 370 LUCs were adopted in Surrey, most of which remain in effect.
- In 2014, the Provincial Government adopted changes to the *Local Government Act* that terminate all Land Use Contracts (LUCs) in the Province on June 30, 2024. However, the legislation also permits municipalities to undertake early termination of LUCs in advance of 2024, should they choose to do so.
- On June 15, 2015, Council approved the recommendations in Corporate Report No. R122, which outlined a proposed process with respect to the early termination of LUCs in Surrey, which prioritizes based on business development or the simplicity of the termination.
- As a result, City staff are now moving forward with the termination of LUC No. 483 in accordance with the approved process.

PUBLIC NOTIFICATION

Early termination of LUCs is a Council-initiated project that does not require the consent of landowners within the LUC being terminated. A Development Proposal Sign has not been installed and no pre-notification letters have been mailed.

However, the LUC Termination By-law is required to have its own Public Hearing. As a result, the Public Hearing Notice will be delivered to all owners and tenants of properties within LUC No. 483, informing them that Council is considering terminating the LUC. Notice of the Public Hearing will also be delivered to adjoining property owners and tenants within 100 metres (or 3-lot depth, whichever is greater) of the boundaries of LUC No. 483. In addition, the Public Hearing notice will be published in two consecutive issues of the Peace Arch News.

DISCUSSION

- LUC No. 483 was adopted by LUC Authorization By-law, 1978, No. 5664 on January 8, 1979.
- LUC No. 483 currently regulates 16 single family lots and one lot which is owned by the City of Surrey. The subject area is located in South Surrey, on 25 Avenue between 134 Street and 36 Street.
- The subject site is designated Suburban under the Official Community Plan and has an underlying “One-Acre Residential Gross Density Zone (RA-G)” under Surrey Zoning By-law, 1993, No. 12000, as amended.
- The subject site is bordered to the north, east, south and west by single family dwellings.
- LUC No. 483 permits single family dwelling uses and uses customarily accessory thereto.
- LUC No. 483 permitted the original site to be subdivided into a maximum of 17 single family lots and one lot that was to be transferred to the City for municipal purposes.
- In 2011, LUC No. 483 was discharged from the lot at 13462-25 Avenue, under LUC Partial Discharge By-law, 2011, No. 17380 with the result that this lot is no longer regulated by LUC No. 483.
- In accordance with the recent legislative changes, the LUC Termination By-law must include an effective date that is no less than one year from adoption of the by-law, resulting in a grace period. The subject Termination By-law has a one-year grace period.
- Once LUC No. 483 is terminated and the one-year grace period ends, the current underlying “Acreage Residential Gross Density Zone (RA-G)” will come into effect and will regulate the use of the land.
- The “Acreage Residential Gross Density Zone (RA-G)” permits single family dwellings, including one secondary suite, as well as a bed and breakfast operation and the keeping of boarders or lodgers as accessory uses.

INFORMATION ATTACHED TO THIS REPORT

The following information is attached to this Report:

Appendix I. Copy of Part 13 “Acreage Residential Gross Density Zone (RA-G)” of Surrey Zoning By-law, 1993, No. 12000, as amended.

INFORMATION AVAILABLE ON FILE

- Land Use Contract No. 483.

original signed by Ron Hintsche

Jean Lamontagne
General Manager
Planning and Development

CRL/dk

\\file-server1\net-data\csdc\generate\areaproduct\save\12650911034.doc
KD 6/8/16 2:02 PM



Acreage Residential Gross Density Zone

Part 13 - RA-G, Acreage Residential Gross Density Zone

Part 13

RA-G

A. Intent

This zone is intended for single family housing on large *suburban lots*, with substantial public *open space* set aside within the subdivision. This Zone shall only be considered if there are special characteristics on the *lot*, such as mature vegetation, watercourses, ravines, heritage *buildings* or other features worthy of preservation and/or there will be a significant contribution to a park designated in the *Official Community Plan*.

B. Permitted Uses

Amendments: 14101, 09/18/00; 17290, 12/13/10; 17471, 10/03/11

Land and *structures* shall be used for the following uses only, or for a combination of such uses:

1. One *single family dwelling* which may contain 1 *secondary suite*.
2. The following uses are permitted within the *open space* set aside pursuant to Section D.2 of this Zone, provided that these uses do not infringe upon the quality of the features being preserved and are for the enjoyment of the residents within the subdivision and do not constitute a commercial undertaking:
 - (a) Tennis court, swimming pool, play ground, fitness trail, baseball diamond, picnic area, putting green and pitch and putt course provided that the enclosed or covered portion of the said facility does not exceed 5% of the total *open space* set aside; and
 - (b) Equestrian facilities, both open and covered, provided however, that the enclosed or covered portion of this facility does not exceed 10% of the total *open space* set aside.
3. Where the minimum *lot area* is 2,800 square metres [30,000 sq.ft.], the keeping of 1 horse is permitted, provided that:
 - (a) The portion of the *lot* in which the horse is kept is securely fenced at a height of not less than 1.2 metres [4 ft.]; and

- (b) That the *lot* in question abut, or provide direct access to *open space* suitable for equestrian activities.
4. *Accessory uses* including the following:
- (a) *Bed and breakfast* use in accordance with Section B.2, Part 4 General Provisions, of this By-law; and
 - (b) The keeping of *boarders* or *lodgers* in accordance with Section B.2, Part 4 General Provisions, of this By-law.

C. Lot Area

The minimum *site area for subdivision* shall be 1 hectare [2.5 acres], except in the case of a remainder *lot*, where the *lots* including the remainder *lot* which were created by the same plan of subdivision are zoned RA-G.

D. Density

Amendments: 14101, 09/18/00

1. For the purpose of subdivision:
- (a) In Neighbourhood Concept Plan and Infill Areas as described and outlined on the maps attached as Schedule F of this By-law, the maximum *density* shall not exceed 1.2 *dwelling units* per hectare [0.5 u.p.a.] calculated on the basis of the entire *lot*. The maximum *density* may be increased to 2 *dwelling units* per hectare [0.8 u.p.a.] calculated on the basis of the entire *lot*, if amenities are provided in accordance with Schedule G of this By-law.
 - (b) In areas other than the ones in Sub-section D.1.(a) of this Zone, the maximum *density* shall not exceed 2 *units* per hectare [0.8 u.p.a.] calculated on the basis of the entire *lot*.
2. The maximum *density* may be increased from 2 *units* per hectare [0.8 u.p.a.] to 2.5 *dwelling units* per hectare [1.0 u.p.a.], both calculated on the basis of the entire *lot*, provided that:
- (a) *Open space* in an amount of not less than 15% of the *lot* area is preserved in its natural state or retained for park and recreational purposes;

- (b) The said *open space* shall contain natural features such as a stream, ravine, stands of mature trees or other land forms worthy of preservation, and/or contain heritage *buildings* or features, and/or contribute to a park designated in the *Official Community Plan*; and
 - (c) The said *open space* shall be accessible by the public from a *highway*.
- 3. *Undevelopable areas* may be included in the *open space* set aside in Sub-section D.2(a), however, this *undevelopable area* shall be discounted by 50%.
- 4. (a) For the purpose of this Section and notwithstanding the definition of *floor area ratio* in Part 1 Definitions of this By-law, all covered areas used for parking shall be included in the calculation of; and
 - (b) For *building* construction within a *lot* the *floor area ratio* shall not exceed 0.25, provided that, of the resulting allowable floor area, 67 square metres [720 sq.ft.] shall be reserved for use only as a garage or carport, and 28 square metres [300 sq.ft.] shall be reserved for use only as *accessory buildings* and *structures*.

E. Lot Coverage

The maximum *lot coverage* shall be 20%.

F. Yards and Setbacks

Amendments: 13093, 05/12/97; 17471, 10/03/11; 18414, 03/23/15

Buildings and structures shall be sited in accordance with the following minimum setbacks:

Use	Setback	Front Yard	Rear Yard	Side Yard	Side Yard on Flanking Street
<i>Principal Building</i>		7.5 m. [25 ft.]	7.5 m. [25 ft.]	4.5 m. [15 ft.]	7.5 m. [25 ft.]
<i>Accessory Buildings and Structures Greater Than 10 square metres [108 sq.ft.] in Size</i>		18.0 m. [60 ft.]	1.8 m [6 ft.]	1.0 m [3 ft.]	7.5 m [25 ft.]
<i>Other Accessory Buildings and Structures</i>		18.0 m [60 ft.]	0.0 m	0.0 m.	7.5 m. [25 ft.]
<i>Buildings and Structures for Uses Permitted Under Sec. B.2 of this Zone</i>		7.5 m. [25 ft.]	30.0 m. [100 ft.]	15.0 m [50 ft.]	7.5 m [25 ft.]
<i>Buildings and Structures for Uses Permitted Under Sec. B.3 of this Zone</i>		36.0 m. [120 ft.]	7.5 m. [25 ft.]	7.5 m. [25 ft.]	36.0 m [120 ft.]

Measurements to be determined as per Part 1 Definitions, of this By-law.

G. Height of Buildings

Amendments: 12239, 04/18/94

Measurements to be determined as per Part 1 Definitions, of this By-law:

1. *Principal building*: The *building height* shall not exceed 9 metres [30 ft.].

2. *Accessory buildings and structures*: The *height* shall not exceed 4 metres [13 ft.] except that where the roof slope and construction materials of an *accessory building* are the same as that of the *principal building*, the *building height* of the *accessory building* may be increased to 5 metres [16.5 ft.]

H. Off-Street Parking and Loading/Unloading

Amendments: 13774, 07/26/99

1. Resident *parking spaces* shall be provided as stated in Table C.6 of Part 5 Off-Street Parking and Loading/Unloading of this By-law.
2. Outside parking or storage of *campers*, boats and *vehicles* including cars, trucks and *house trailers* ancillary to the residential use shall be limited as follows:
 - (a) A maximum of 2 cars or trucks;
 - (b) *House trailers*, *campers* or boats, provided that the combined total shall not exceed 2; and
 - (c) The total amount permitted under (a) and (b) shall not exceed 4.

I. Landscaping

Amendments: 12333, 07/25/94; 14101, 09/18/00

1. All developed portions of the *lot* not covered by *buildings*, *structures* or paved areas shall be landscaped including the retention of mature trees. This *landscaping* shall be maintained.
2. The *open space* set aside pursuant to Section D.2.(a) of this Zone shall be improved with a basic level of *landscaping* work including brushing and seeding of the ground, limbing of low branches on trees, and providing and constructing paths for public passage, wherever appropriate.

J. Special Regulations

Amendments: 17290, 12/13/10

1. A *secondary suite* shall:
 - (a) Not exceed 90 square metres [968 sq.ft.] in floor area; and
 - (b) Occupy less than 40% of the habitable floor area of the *building*.

K. Subdivision

Amendments: 14101, 09/18/00

1. For subdivision of the land in Neighbourhood Concept Plan and Infill Areas as described and outlined on maps attached as Schedule F of this By-law:
 - (a) Where amenities are not provided in accordance with Schedule G of this By-law, the *lots* created shall conform to the minimum standards prescribed in Sub-section K.1 of Part 12 One-Acre Residential Zone RA of this By-law; and
 - (b) Where amenities are provided in accordance with Schedule G of this By-law, the *lots* created shall conform to the minimum standards prescribed in Sub-sections K.2 or K.3 of this Zone.
2. *Lots* created through subdivision shall conform to the minimum standards prescribed in Sub-section K.3 of Part 12 One-Acre Residential Zone RA of this By-law.
3. *Lots* created through subdivision in accordance with Section D.2 of this Zone, shall conform to the following minimum standards:

	<i>Lot Size</i>	<i>Lot Width</i>	<i>Lot Depth</i>
Regular Standard <i>Lots</i>	2,800 sq. m. [30,000 sq.ft.]	40 metres [130 ft.]	40 metres [130 ft.]
Permissible Reduction as set out below*	2,230 sq. m [24,000 sq.ft.]	35 metres [115 ft.]	40 metres [130 ft.]

Dimensions shall be measured in accordance with Section E.21, Part 4 General Provisions, of this By-law.

- * Permissible reduction for up to 50% of the *lots* within a plan of subdivision where 15% or more of the lands subdivided are set aside as *open space* pursuant to Section D.2 of this Zone.

L. Other Regulations

Amendments: 13657, 03/22/99; 13774, 07/26/99

In addition, land use regulations including the following are applicable:

1. Prior to any use, lands must be serviced as set out in Part 2 Uses Limited, of this By-law, in accordance with the "Surrey Subdivision and Development By-law".
2. General provisions on use are as set out in Part 4 General Provisions, of this By-law.
3. Additional off-street parking and loading/unloading requirements are as set out in Part 5 Off-Street Parking and Loading/Unloading of this By-law.
4. Subdivisions shall be subject to the "Surrey Development Cost Charge By-law" and the "Tree Preservation By-law".
5. *Building* permits shall be subject to the "Surrey Building By-law".
6. Sign regulations are as provided in Surrey Sign By-law No. 13656.
7. Special *building setbacks* are as set out in Part 7 Special Building Setbacks, of this By-law.

This page left intentionally blank