



PROCUREMENT SERVICES

**CITY OF SURREY, SURREY CITY HALL
13450 – 104 Avenue, Surrey, B.C., V3T 1V8
Tel: 604-590-7274
E-mail: purchasing@surrey.ca**

ADDENDUM No. 1

REQUEST FOR QUOTATIONS No.: 1220-040-2024-085
TITLE: Fire Hall #1 and #2 Dorm Renovations
ADDENDUM ISSUE DATE: November 29, 2024
DATE: PREFER TO RECEIVE SUBMISSION ON OR BEFORE DECEMBER 12, 2024

INFORMATION FOR CONTRACTORS

Contractors are advised that Addendum No. 1 to 1220-040-2024-085 is hereby issued by the City. This addendum shall form part of the contract documents and is to be read, interpreted and coordinated with all other parts. The following information is provided to answer questions raised by Contractors for the above-named project, to the extent referenced and shall become a part thereof. No consideration will be allowed for extras due to the Contractors or any sub-contractor not being familiar with this addendum. This Addendum No. 1 contains two (2) pages.

ADDITIONAL INFORMATION

FIRE HALL 2 – STRUCTURAL REVIEW

Contractor to retain a structural engineer registered in the province of British Columbia to review the weights and location of the new condensing unit and provide signed and sealed documents complete with letters and assurance.

QUESTIONS AND ANSWERS:

- Q1.** Please confirm if F1 and B1 refer to the floor finish and wall base or if they are two flooring options. If they are options, kindly provide the wall base details and height.

CODE	MATERIAL	MANUFACTURER / SUPPLIER	COLLECTION / FINISH REFERENCE	REMARKS	REV.
F1	RESILIENT SHEET FLOORING	ARMSTRONG FLOORING	COLLECTION: FLEXSTEP VALUE PLUS CODE: G2825 COLOUR: Slate Run Design: Stone Hollow SIZE: 12' wide	PROVIDE SAMPLE FOR DESIGN CONSULTANT REVIEW & APPROVAL PRIOR TO PROCEEDING WITH ANY ORDERS. OWNER RESERVES THE RIGHT TO CHANGE THE COLOUR AT NO ADDITIONAL COST	
B1	RESILIENT SHEET FLOORING	ARMSTRONG FLOORING	COLLECTION: FLEXSTEP VALUE PLUS CODE: G2825 COLOUR: Slate Run Design: Stone Hollow SIZE: 12' wide	PROVIDE SAMPLE FOR DESIGN CONSULTANT REVIEW & APPROVAL PRIOR TO PROCEEDING WITH ANY ORDERS. OWNER RESERVES THE RIGHT TO CHANGE THE COLOUR AT NO ADDITIONAL COST	

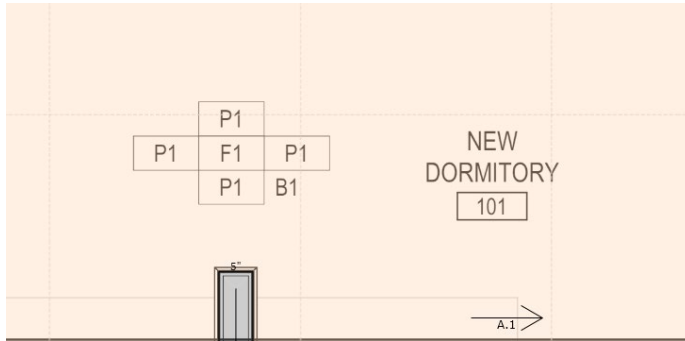

A1. F1 and B1 refer to the new resilient flooring and integral cover base respectively. Base height to match existing adjacent. Provide on both sides of new walls.

All Addenda will become part of the Contract Documents.

- END OF ADDENDUM -