



PROCUREMENT SERVICES

**CITY OF SURREY, SURREY CITY HALL
13450 – 104 Avenue, Surrey, B.C., V3T 1V8
Tel: 604-590-7274
E-mail: purchasing@surrey.ca**

ADDENDUM No. 1

REQUEST FOR QUOTATIONS (RFQ) No.: 1220-040-2020-013
TITLE: DON CHRISTIAN – CHILDCARE MODULAR BUILDING
ADDENDUM ISSUE DATE: JUNE 24, 2020
REVISED DATE: PREFER TO RECEIVE QUOTATIONS ON OR BEFORE JULY 9, 2020.

INFORMATION FOR CONTRACTORS

Contractors are advised that Addendum No. 1 to 1220-040-2020-013 is hereby issued by the City. This addendum shall form part of the contract documents and is to be read, interpreted and coordinated with all other parts. The following information is provided to answer questions raised by Contractors for the above-named project, to the extent referenced and shall become a part thereof. No consideration will be allowed for extras due to the Contractors or any sub-contractor not being familiar with this addendum. This Addendum No. 1 contains six (6) pages.

REVISED CLOSING DATE:

The City would prefer to receive Quotations on or before July 9, 2020.

CLARIFICATIONS:

1. Please refer to Attachment 1 Architectural Addendum and Attachment 2 Information Meeting / Site Tour Attendance Sheet.

ATTACHMENT NO. 1 – ARCHITECTURAL ADDENDUM



Project: Don Christain Daycare (Prefabricated Daycare Building Sub-Project)

6220-184th Street, Surrey BC

Owner City of Surrey

P. Manager Carlos Aller

604-590-7202

ACAI Proj # 19SUR02

Issued: June 22, 2020

No. Pages: 4

Architectural Addendum

#1

This addendum and referenced attachments form part of the contract documents and is to be read, interpreted and coordinated with all other parts of the Contract Documents. The cost of all the work contained herein is to be included in the Contract Sum/Price Quotation. These revisions supersede the information contained in the original drawings and specifications issued for the above named project to the extent referenced and shall become part thereof.

1. Drawing PF-A001

- a) Refer to note 'Prefabricated Daycare Building Sub-project General Description'; add the following:
The final mechanical and electrical connections to the premanufactured daycare building m/e rough-in will be by others (by Site Improvements Contractor).
- b) Refer to 'List of Tender Drawings'; revise the following text:
add Drawing A002 Existing Overall Site Plan
- c) Refer to 'List of Tender Drawings'; revise the drawing numbers as per the following:
*revise A010 to A100
revise A011 to A101
revise A020 to A102
revise A030 to A103*
- d) Refer to 'Reference Drawings (NIC -Work By Others)'; revise the drawing numbers as per the following:
revise GC-A002 to A002

2. Drawing GC-A002

- a) Refer to title block drawing number reference:
revise drawing number from GC-A002 to A002

3. Drawing PF-A100

- a) Refer to note 'Electrical Scope', add following text:
Include supply and install of 4 exterior wall mounted light fixtures (LPW16 Lytepro LED Small Wall Sconce) cutsheets provided, color to be selected by owner
- b) Refer to note 'Prefabricated Daycare Building Architectural Schematic Design Outline Specifications':
Delete references to spray insulation at u/s of floor, within walls and ceiling in lieu of batt insulation with poly vapour barrier

4. Drawing PF-A101

- a) Refer to detail 1/A101, add following text to General Notes:
Ceiling height to be 8'-0" at u/s of GWB ceilings and 8'-1" at u/s of tbar ceilings.

5. Drawing PF-A103

- a) Refer to note 'R1 Roof Type':
Delete references to spray insulation in lieu of batt insulation with poly vapour barrier
- b) Refer to note 'W1 Exterior Wall Type':
Delete references to spray insulation in lieu of batt insulation with poly vapour barrier
- c) Refer to note 'F1 Floor Type':
Delete references to spray insulation in lieu of batt insulation with poly vapour barrier

6. Confirmed:

- a) As per drawing PF-A001, this project falls under Part 3 of the BC Building Code
- b) As per drawings PF-A001 and PF-A100, Professional Letters of Assurance will be required
- c) As per drawings PF-A101, with the exception of the metal roofing, the entry canopy will be 'by others'.

**PHILIPS
KEENE**

Wall mount

LytePro LED Sconce

LPW16



Project: _____
 Location: _____
 Cat.No: _____
 Type: _____
 Quantity: _____
 Notes: _____

The Philips Keene LytePro LED Wall Sconce LPW16 features outstanding value in a compact, architectural design. This wall sconce features state-of-the-art, long-life and maintenance savings, in a combined discreet LED package with high precision over-optic design. This powerful and precise combination offers outstanding energy savings with excellent photometric performance. LPW16 is ideal for entryways and corridors in addition to wall lighting applications requiring strong lateral spacing and forward pattern projection.

Stocked luminaires – Ordering guide

Catalog Number	Description	Master Pack, Qty	UPC Code
LPW16-78BZ	LPW16, 40W, 700mA, 4000K, 120-277V, Bronze textured paint	6	786034960502
LPW16-78DGY	LPW16, 40W, 700mA, 4000K, 120-277V, Dark gray textured paint	6	786034960489
LPW16-78WH	LPW16, 40W, 700mA, 4000K, 120-277V, White textured paint	6	786034960496

Stocked accessories – Ordering guide (Must be ordered separately)

Catalog Number	Description	Master Pack, Qty	UPC Code
LPWCVRPLT-BZ	LPW Universal wall cover mounting plate, Bronze textured paint	(none)	786034960618

Description of catalog codes

Family	Drive current	Voltage	Finish
LPW16 - LytePro 16 LED Wall Sconce	7 - 700mA drive current	8 - 120-277V 1 - 120V	BZ - Bronze textured paint DGY - Dark gray textured paint WH - White textured paint

LPW16 LytePro LED Small Wall Sconce

Features

LPW16 wall sconce delivers 3,374 lumens at 36W, with an efficacy of 93 lumens per watt.

- LP16W-7, 40W LED may effectively replace 100-150W HID luminaires¹
- 4000K neutral white at 70 CRI (minimum) is standard
- LPW16 offers three in-stock colours on standard units
- 5-year limited warranty, see philips.com/warranties for specific details

Performance/Specifications (LPW 16-7)

Distribution	Type 3
Initial Lumens	3,374
Average Wattage	36
Lumens/Watt	93
BUG Rating*	B1/U0/G1
Luminaire Weight	~ 6lbs (2.7Kg)

Ratings/Approbations/Certifications

Ingress Protection	IP65 Optical
DLC Listed	DLC QPL
cETLUS	Certified for use in wet locations
Rated Ambient Temperature	-40°C (-40°F) to 40°C (104°F)

Fixture Dimensions

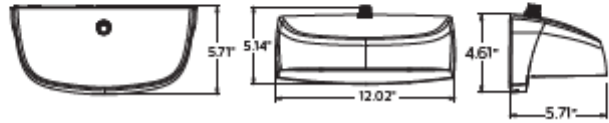

Accessory Dimensions (ordered separately)

LPWCVRPLT-BZ Universal wall cover mounting plate, 0.08\" aluminum, bronze textured paint (used to cover larger pre-existing opening or surfaces, field installed). Offers same J-Box pattern as luminaire or may lagged to wall using (4) knockouts.



Universal junction box mounting hole pattern

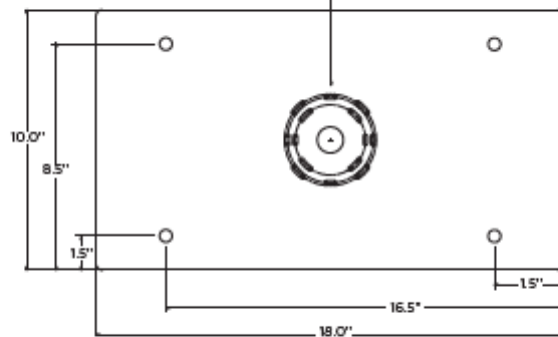

1. Comparable equivalency to HID and other lamp sources depends on multiple criteria including mounting height, fixture spacing, efficiency, performance and classification of the luminaire being replaced and application lighting criteria required for the given project.

Distribution Pattern

LPW16-7 10' MOUNTING HEIGHT			
MOUNTING HEIGHT	8'	10'	12'
MULTIPLIER	1.60	1.0	0.70

- Isolines shown at 2.0, 1.0, 0.5, & 0.2 FC.
- Choose mounting height. Use MULTIPLIER (X) EXISTING FC VALUE = NEW FC VALUE.
- FC values are based on initial lumen output.
- Gridline spacing is in units of chosen mounting height

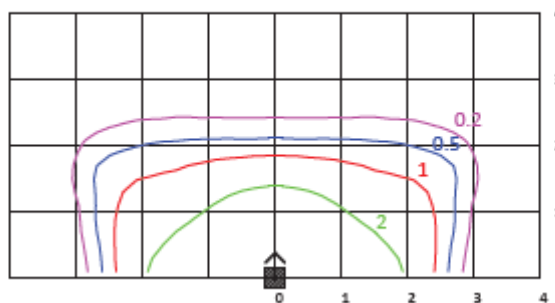

General Description

The Philips Keene LytePro LED Wall Sconce LPW16 combines excellent performance, design and value to meet the needs of the energy and budget conscious. The LPW16 is available for use in downward facing, surface wall mount applications, over recessed J-boxes or where power can be directly fed through back surface, whereby connections splices can be made inside the luminaire housing.

Housing

Die-cast housing houses both the LED and driver assemblies. Design incorporates an integrated heat sink to maximize thermal performance and reliability. Backplate is corrosion free, composite polycarbonate, with built-in level bubble, offers integral interlocking hook and mount design for easy installation.

Mounting

Easy interlocking hook and mount housing/backplate design for easy installation. Mounts over 3.5", 4" octagonal J-boxes and single gang switch boxes or can be directly lagged to surface. Ensure proper steps for gasket/sealing luminaire to surface.

IP Rating

Optical compartment is IP65 rated.

LED Board and Array

Provides up to 93 lm/W at the system level. Standard colour temp is 4000K +/- 250K, minimum 70 CRI.

Electrical

Driver efficiency (>90% standard). 120-277V. Temp range: -40°C (-40°F) to 40°C (104°F). Open/short circuit protection. Inherent surge protection up to (4KVA). RoHS compliant.

Listings

Product is cETLus listed suitable for Wet Locations. Suitable for use in ambients from -40°C to 40°C (-40°F to 104°F). DesignLights Consortium® qualified.

Finish

Each luminaire receives a fade and abrasion resistant, electrostatically applied, thermally cured, triglycidal isocyanurate (TGIC) textured polyester powdercoat finish. Three standard colours are available: Dark Grey, Bronze and White. Specific options are only available in bronze.

Warranty

LPW16 luminaires, the LED arrays, and the drivers are all covered by a 5-year limited warranty. See philips.com/warranties for details.

LED Performance:

PREDICTED LUMEN DEPRECIATION DATA ^{2,4}			
Ambient Temp. °C	Calculated L70 hrs ³	Reported L70 Per TM-21 ⁴	Calculated Lumen Maint. % @60,000 hrs
up to 40°C	>200,000 hrs	>60,000 hrs	94.0%

2. Calculated performance derived from LED manufacturer's data and engineering design estimates, based on IESNA LM-80 methodology. Actual experience may vary due to field application conditions.

3. L70 is the predicted time when LED performance depreciates to 70% of initial lumen output.

4. Reported per IESNA TM21-11. Published L70 hours limited to 6 times actual LED test hours.



© 2014 Koninklijke Philips N.V. All rights reserved. Philips reserves the right to make changes in specifications and/or to discontinue any product at any time without notice or obligation and will not be liable for any consequences resulting from the use of this publication. philips.com/luminaires



Philips Lighting North America Corporation
200 Franklin Square Drive, Somerset, NJ 08873
Tel. 855-486-2216

Imported by: Philips Lighting,
A division of Philips Electronics Ltd.
281 Hillmount Rd, Markham, ON, Canada L6C 2S3
Tel. 900-668-9008

ATTACHMENT NO. 2 – INFORMATION MEETING/SITE TOUR ATTENDANCE SHEET

Project Title: Don Christian Recreation Centre-Childcare Modular Building

Project Reference No.: 1220-020-2020-013

Information Meeting / Site Tour Date: Tuesday, June 16th, 2020

Information Meeting / Site Tour Address: 6220 184 Street, Surrey, B.C.

Time: 10:00 a.m.

Staff in Attendance:

Staff Name	Signature	Staff Name	Signature
1) Carlos Aller		2) Clayton Welch	
3) Arielle Patterson		4) Martin Alberto	

Consultant(s) in Attendance:

Consultant's Company Name	Representative Name	Signature
1) Art Cader Architect	Art Cader	
2)		

Contractors in Attendance:

#	Company Name	Representative Name	Signature
1)	Atco	1) Tommy Pham	
		Rob Brechin	
2)	Freeport	1) Jason Fresen	
3)	Fort Modular	1) Ryan Depedrina	
4)			

All Addenda will become part of the Contract Documents.

- END OF ADDENDUM -