

NO: **R040**

COUNCIL DATE: **MARCH 23, 2015**

## REGULAR COUNCIL

TO: **Mayor & Council**

DATE: **March 2, 2015**

FROM: **General Manager, Engineering**

PROJECT FILE: **1213-002/11**

SUBJECT: **Award of Contract M.S. 1213-002-11  
Distribution Water Mains Construction Package W02/13**

## RECOMMENDATIONS

The Engineering Department recommends that Council:

1. Award Contract M.S. 1213-002-11 to Pedre Contractors Ltd. in the amount of \$1,956,118.50, including GST, for construction of distribution water mains and at various locations; and
2. Set the expenditure authorization limit for Contract M.S. 1213-002-11 at \$2,250,000, including contingency and GST.

## SCOPE OF WORK

The construction package related to this Contract consists of installation of distribution water mains at the locations listed in the following table and illustrated on the map attached as Appendix I. The major components of the contract includes construction of distribution water mains in Cloverdale.

Map Reference Number	Project #	Description	Location
1	1299-3040-00	47m of 250mm dia. water main	Lane East of 176A Street: North of 56A Avenue
2	1212-3050-00	286m of 250mm dia. water main	Lane West of 176A Street: 56A Avenue - 58 Avenue
3	1212-3060-00	131m of 250mm dia. water main 93m of 250 mm dia. water main	57A Avenue: 176A Street - 177B Street
4	1212-3110-00	822m of 300mm dia. water main	20 Avenue: 176 Street - 180 Street
5	1212-3140-00	802m of 300mm dia. water main	64 Avenue: 184 Street - 188 Street
6	1212-3210-00	124m of 250mm dia. water main	178 Street: 65A Avenue - 66 Avenue

Map Reference Number	Project #	Description	Location
7	1215-3200-00	Install Joint Restraints on 66m of existing 500mm dia. water main	176 Street at 68 Avenue

The contract work is expected to start in April, 2015 and be completed by the end of July, 2015.

## TENDER RESULTS

Tenders for the subject contract were opened on February 26, 2015, with the following results:

<i>Contractor</i>	<i>Tendered Amount with GST</i>	<i>Corrected Amount</i>
1. Pedre Contractors Ltd.	\$1,956,811.50	\$1,956,118.50
2. Hyland Excavating Ltd.	\$2,001,673.80	No Change
3. Richco Contracting Ltd.	\$2,012,900.40	No Change
4. Sandpiper Contracting LLP	\$2,269,390.20	No Change
5. B&B Contracting Ltd.	\$2,319,030.00	No Change
6. Capilano Highway Services Co.	\$2,918,571.60	\$2,604,076.65
7. B. Cusano Contracting (2007) Inc.	\$3,167,850.00	\$3,167,640.00
8. Tybo Contracting Ltd.	\$3,382,140.00	\$3,359,732.25

The Engineer's pre-tender estimate was \$2,315,166.00 including GST.

## EVALUATION

The City's consultant reviewed the tender submissions for accuracy and completeness. Of the eight tenders, four of them contained minor arithmetic errors that had no bearing on the outcome of the tender process. All submissions included the required 10% bid bond, and were signed and sealed on the Tender Form and Summary Sheet of the Schedule of Quantities and Prices.

The low bidder, Pedre Contractors Ltd., has provided a Consent of Surety for a Performance Bond and a Labour & Materials Bond, and agreed to complete the work within 80 working days as stipulated in the contract. Pedre Contractors Ltd. past performance on similar work has been satisfactory. They have no outstanding legal claims against the City. It is recommended that Pedre Contractors Ltd. be awarded Contract M.S. 1213-002-11.

## SUSTAINABILITY CHARTER/CONSIDERATIONS

The work of this contract will minimize operational and maintenance costs and facilitates the development and servicing of the adjacent property. In particular, the project supports the following Sustainability Charter Scope actions:

- EC3: Sustainable Infrastructure Maintenance and Replacement; and
- EN8: Sustainable Engineering Standards and Practice.

## FUNDING

Funding for the subject contract is available in the 2015 Budget.

Fraser Smith, P.Eng., MBA  
General Manager, Engineering

SBN/HL/GKC/clr

Appendix I – Map of Location – Contract M.S. 1213-002-11

g:\wp-docs\2015\admin\cr\02230931-gkc.docx  
CLR 3/9/15 10:37 AM

# APPENDIX I

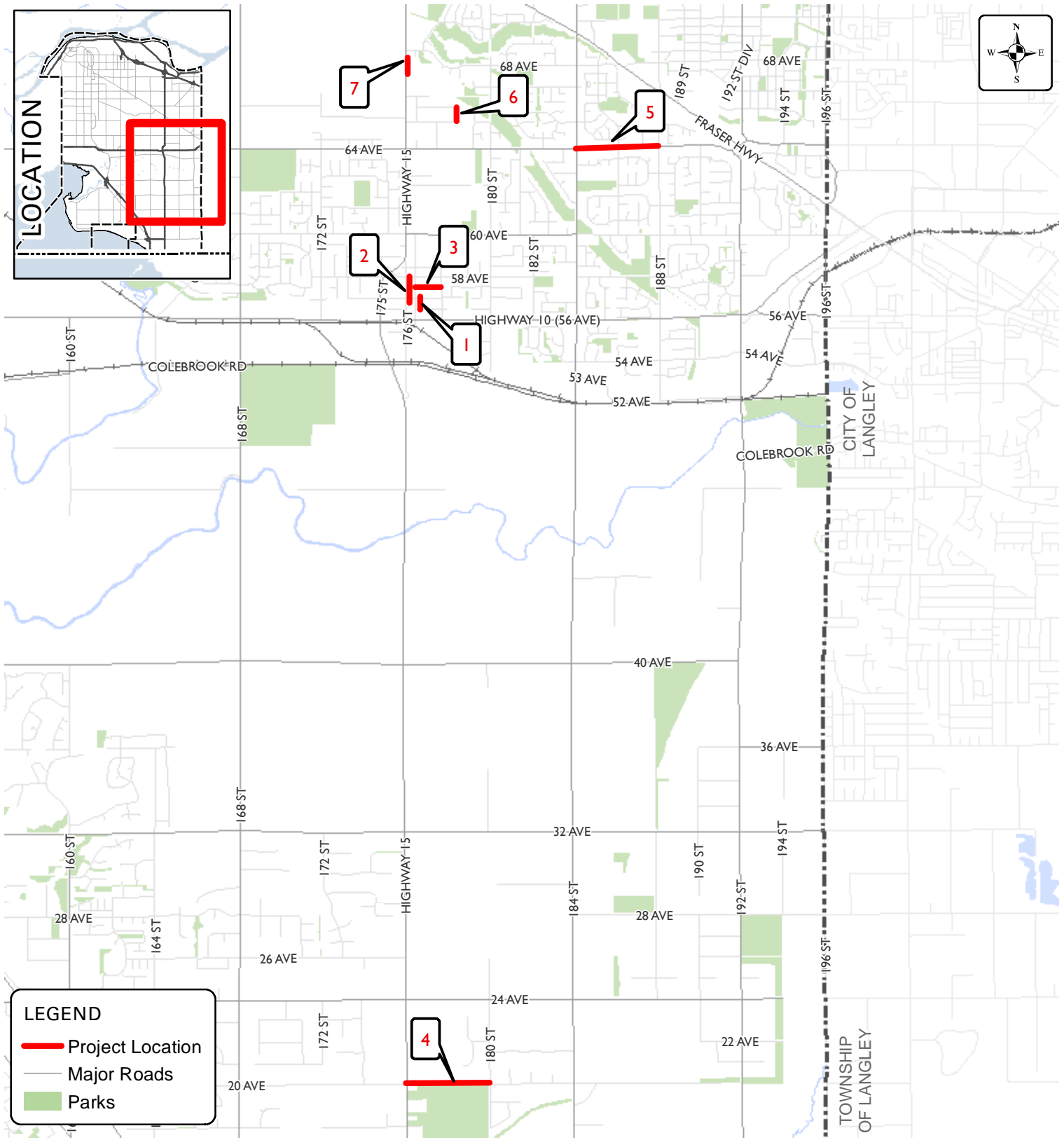
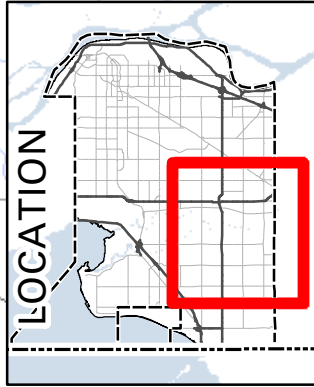

**LEGEND**

- Project Location
- Major Roads
- Parks

Produced by GIS Section: 04-Mar-2015, EM9



**CONTRACT MS 1213-002-11**  
**Watermain Distribution**  
**Upgrades and Replacements**

**ENGINEERING**  
**DEPARTMENT**

The data provided is compiled from various sources and IS NOT warranted as to its accuracy or sufficiency by the City of Surrey.  
 This information is provided for information and convenience purposes only.  
 Lot sizes, Legal descriptions and encumbrances must be confirmed at the Land Title Office.