

NO: R012

COUNCIL DATE: **FEBRUARY 3, 2014**

---

## REGULAR COUNCIL

TO: **Mayor & Council**

DATE: **January 30, 2014**

FROM: **Acting General Manager, Engineering**

FILE: **0910-30/184  
7911-0173-00**

SUBJECT: **Approval of the Sale of Closed Portions of Road Allowance  
adjacent to 6321 King George Boulevard (Step 2)**

---

## RECOMMENDATION

The Engineering Department recommends that Council authorize the sale of a 516.6 m<sup>2</sup> (5,561 ft<sup>2</sup>) area and a 22.6 m<sup>2</sup> (243 ft<sup>2</sup>) area of closed road allowance adjacent to 6321 King George Boulevard under previously approved terms for this closure and sale as outlined in Corporate Report No. R160; 2013, a copy of which is attached to this report as Appendix I.

## DISCUSSION

On September 9, 2013, Council authorized the Engineering Department (Resolution No. R13-1884 related to Corporate Report No. R160) to proceed with the closure and sale of portions of redundant road allowance having an area of 516.6 m<sup>2</sup> (5,561 ft<sup>2</sup>) area and an area of 22.6 m<sup>2</sup> (243 ft<sup>2</sup>) for the purpose of allowing consolidation and development with the property known as 6321 King George Boulevard. Council's approval of the sale of these portions of closed road is now required to complete the final step in the road closure process as stipulated by the Community Charter.

The Community Charter requires that Council's approval to close and sell roads be obtained on two separate occasions. The first such approval is at the beginning of the closure process when Council is requested to authorize the "cancellation of highway" for the portion of road to be closed and consolidated. The second such approval is at the end of the process when Council's authorization is required to formally dispose of the closed portion of road after all the statutory requirements have been met. In accordance with Section 40 of the Community Charter, all the necessary requirements to dispose of these redundant portions of road allowance have been met and it is now in order for Council to authorize this last step in the road closure and sale process.

## CONCLUSION

It is recommended that Council approve the sale of closed portions of road allowance adjacent to 6321 King George Boulevard under the previously approved terms for this Closure and Sale as outlined in the attached Corporate Report No. R160; 2013.

Gerry McKinnon  
Acting General Manager, Engineering

ML/amg/ras

Appendix I: Corporate Report No. R160; 2013

g:\wp-docs\2014\admin\cr\01131300-ml (md).docx  
R 1/30/14 2:05 PM

NO: R160

COUNCIL DATE: **SEPTEMBER 9, 2013**

---

## REGULAR COUNCIL

TO: **Mayor & Council**

DATE: **September 4, 2013**

FROM: **General Manager, Engineering**

FILE: **0910-30/184  
7911-0173/00**

SUBJECT: **Closure of Road Allowance Adjacent to 6321 King George Boulevard**

---

## RECOMMENDATION

The Engineering Department recommends that Council authorize the City Clerk to bring forward a by-law to close and remove the dedication as highway of each of a 516.6 m<sup>2</sup> (5,561 ft.<sup>2</sup>) area and a 22.6 m<sup>2</sup> (243 ft.<sup>2</sup>) area of road allowance located adjacent to the property at 6321 King George Boulevard, all as generally illustrated in Appendix I attached to this report.

## BACKGROUND

### 1. **Property Description**

The 516.6 m<sup>2</sup> (5,561 ft.<sup>2</sup>) area of road allowance proposed for closure is an unopened lane on the west side of the privately-held property located at 6321 King George Boulevard. The 22.6 m<sup>2</sup> (243 ft.<sup>2</sup>) road allowance area is a portion of King George Boulevard at the frontage of 6321 King George Boulevard. The road allowance areas are not required by the City if the site at 6321 King George Boulevard is developed.

### 2. **Zoning, Plan Designations, and Land Uses**

The areas of road allowance proposed for closure and the adjacent lot at 6321 King George Boulevard are zoned Highway Commercial Industrial (CHI) Zone and are designated as "Urban" in the Official Community Plan and "Retail Commercial" in the Newton Local Area Plan.

## DISCUSSION

### 1. **Purpose of Road Closure**

The areas of road proposed for closure are intended to be consolidated and rezoned with the adjacent private property located at 6321 King George Boulevard under Development Application No. 7911-0173-00. This development application is seeking approval to develop a 3-storey commercial building on the consolidated site, as illustrated in Appendix II attached to this report. The related rezoning by-law was granted third reading by Council on May 6, 2013.

The proposed road closure has been circulated to all potentially concerned City Departments for review and all are supportive of the closure.

As required under Section 40 (4) of the Community Charter, all utility companies potentially affected by the proposed road closure have been consulted and none has expressed any objection. Parts of the road closure areas are impacted by City utilities. These utilities will be protected by the registration of statutory rights-of-way where necessary.

## 2. Land Value

The applicant has agreed to provide compensation to the City equivalent to the market value of the road closure areas as determined by a staff appraiser.

All area calculations contained in this report are approximate and subject to final survey.

## SUSTAINABILITY CONSIDERATIONS

The proposed road closure and sale support the Surrey Sustainability Charter goal of using the City's land base efficiently as the road allowance areas proposed for closure will not be required for road purposes upon development of the adjacent private property at 6321 King George Boulevard and are to be consolidated and developed with that adjacent property in support of planned and orderly development in Newton.

## CONCLUSION

The areas of road allowance proposed for closure are surplus to the City's needs. The terms of the agreement related to the disposition of the road closure areas are considered reasonable. It is recommended that Council authorize staff to bring forward an appropriate by-law to close the subject road allowance areas in preparation for their sale and consolidation as generally described in this report.

Vincent Lalonde, P.Eng.  
General Manager, Engineering

AW/ce

g:\wp-docs\2013\admin\cr\08120934-aw (md).docx  
BRB 9/5/13 3:56 PM

Appendix I: Aerial Photograph of 6321 King George Boulevard and proposed Road Closures

Appendix II: Proposed Development Layout for 6321 King George Boulevard

# APPENDIX I AERIAL PHOTOGRAPH OF SITE



Produced by GIS Section: 19-Aug-2013, aw6

Date of Aerial Photography: March 30, 2013



**CLOSURE OF ROAD  
ALLOWANCE ADJACENT TO  
6321 KING GEORGE BOULEVARD**

**ENGINEERING  
DEPARTMENT**

The data provided is compiled from various sources and IS NOT warranted as to its accuracy or sufficiency by the City of Surrey.  
This information is provided for information and convenience purposes only.  
Lot lines, legal descriptions and encumbrances must be confirmed at the Land Title Office.

Source: G:\MAPPING\GIS\MapaCo\reports\Mapa\Ready\AWR\roadCo\areaAdj\6321-K-GB-AP.mxd

# APPENDIX II DEVELOPMENT SITE LAYOUT

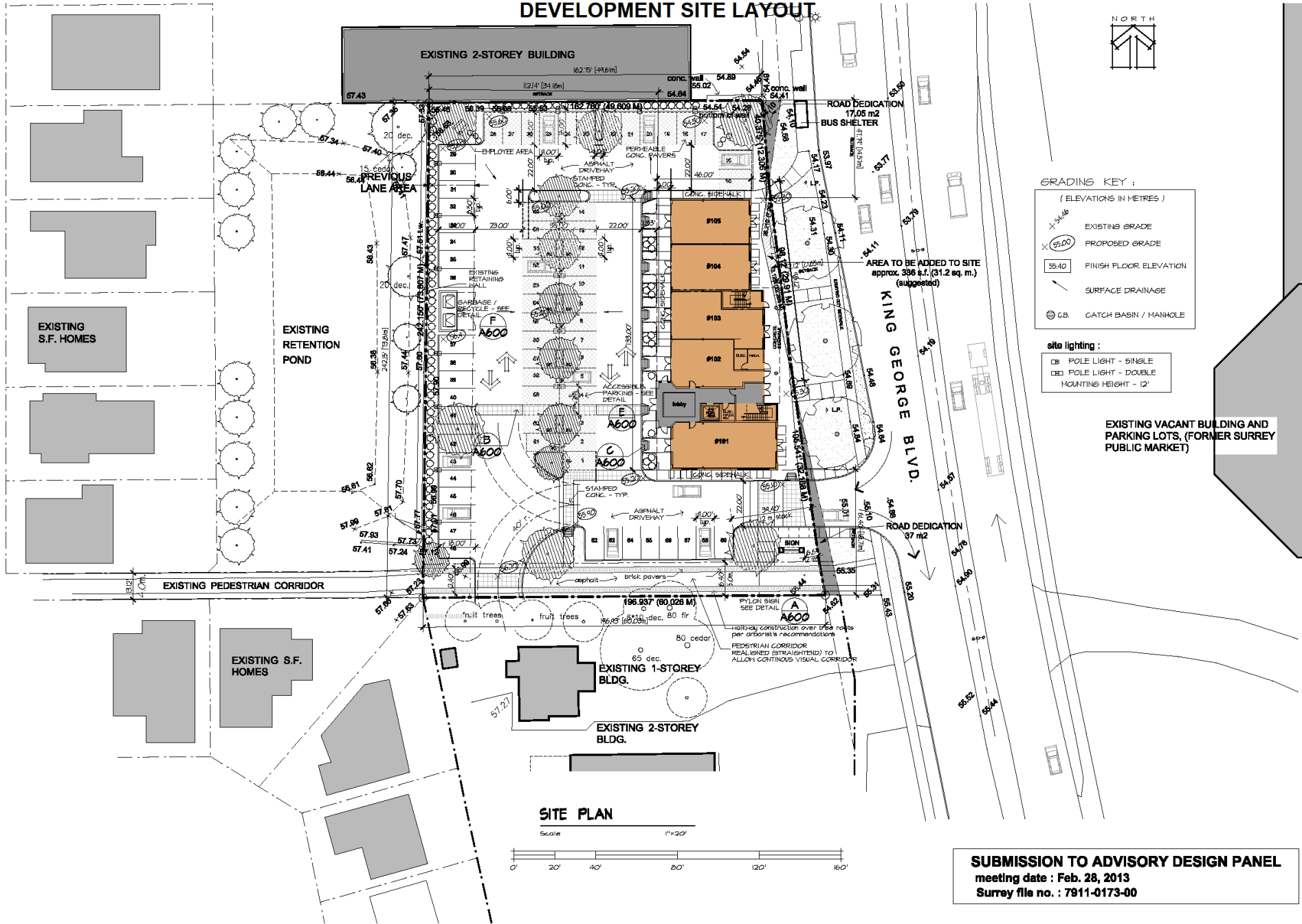

**GRADING KEY :**  
(ELEVATIONS IN METRES)

- EXISTING GRADE
- PROPOSED GRADE
- FINISH FLOOR ELEVATION
- SURFACE DRAINAGE
- C.B. CATCH BASIN / MANHOLE

**site lighting :**

- POLE LIGHT - SINGLE
- POLE LIGHT - DOUBLE

Mounting Height = 12'

EXISTING VACANT BUILDING AND  
PARKING LOTS, (FORMER SURREY  
PUBLIC MARKET)

AREA TO BE ADDED TO SITE  
approx. 396 s.f. (31.2 sq. m.)  
(suggested)

**SITE PLAN**  
Scale 1" = 20'

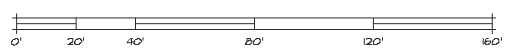

**SUBMISSION TO ADVISORY DESIGN PANEL**  
meeting date : Feb. 28, 2013  
Surrey file no. : 7911-0173-00

Rev.	Date	Description
01	2-21-13	SUBMIT FOR A.D.P.

**Ionic Architecture Inc.**  
architect - member a.i.a.c.  
2044411 some Street  
Surrey B.C. V3R 6R8  
Tel: 778 871-8888  
Fax: 778 871-8889  
www.ionicarchitect.com

**SITE PLAN**  
Project Title  
**MASKEEN PROFESSIONAL CENTRE**  
6321 KING GEORGE BLVD.  
SURREY - B.C.

Sheet	of	A101
Scale	1" = 20'	
Date	02.28.2013	
Revision	01	12-1279