

NO: **R041**

COUNCIL DATE: **March 12, 2012**

---

## REGULAR COUNCIL

TO: **Mayor & Council**

DATE: **March 8, 2012**

FROM: **General Manager, Engineering**

FILE: **4711-903**

SUBJECT: **Local Area Service – Sanitary Sewer Extension along Abbey Drive from the westerly property line of 17386 Abbey Drive to 174A Street and in the 174 Street cul-de-sac off the south side of Abbey Drive**

---

## RECOMMENDATIONS

The Engineering Department recommends that Council:

1. Approve the establishment of a Local Area Service (LAS) to allow a sanitary sewer main extension along Abbey Drive from the westerly property line of 17386 Abbey Drive through to 174A Street and in the 174 Street cul-de-sac running south off Abbey Drive, all as illustrated on the map attached to this report as Appendix I, at an estimated total cost of \$206,000, which costs will be fully recovered by Local Area Service charges and will be apportioned based on final costs to the benefiting lots on a frontage basis all in accordance with City policy; and
2. Authorize the City Clerk to bring forward the necessary LAS By-law for the required readings.

## INTENT

The purpose of this report is to advise Council of a petition that has been received by the City for the installation of a sanitary sewer main extension as a Local Area Service and to seek Council approval to proceed with an LAS to allow construction of the sanitary sewer main on the basis of an LAS.

## DISCUSSION

The owners of properties fronting Abbey Drive from the westerly property line of 17386 Abbey Drive through to 174A Street and fronting the 174 Street cul-de-sac that runs south off Abbey Drive (all as illustrated on the map attached as Appendix I to this report) have petitioned the City to extend a sanitary sewer main to provide sanitary sewer service to the fronting properties. The petition has been certified as being “sufficient” in accordance with the requirements of the *Community Charter*. A copy of the City Clerk’s Certificate of Sufficiency is attached to this report as Appendix II.

The costs of the sanitary sewer main extension have been estimated at \$206,000 and will be shared by the properties within the benefiting area based on the frontage of each property as documented in the Engineer’s Report, a copy of which is attached to this report as Appendix III. This is consistent with the City’s LAS Policy.

Funding for the sanitary sewer main extension is available in the approved Sanitary Sewer Capital LAS Program with costs to be recoverable over time based on the LAS charges that will be collected from the benefiting properties.

## **SUSTAINABILITY CHARTER/CONSIDERATIONS**

The sanitary sewer main extension as described in this report will provide sanitary sewer service to the benefiting lots. The sanitary sewer extension will assist in achieving the objectives of the City's Sustainability Charter; more particularly, the following action items:

- EC3: Sustainable Infrastructure Maintenance and Replacement;
- EN16: Land, Water and Air Quality Management; and
- EN8: Sustainable Engineering Standards and Practices.

## **CONCLUSION**

Based on the above discussion, it is recommended that Council:

- Approve the establishment of a Local Area Service (LAS) to allow a sanitary sewer main extension along Abbey Drive from the westerly property line of 17386 Abbey Drive through to 174A Street and in the 174 Street cul-de-sac running south off Abbey Drive, all as illustrated on the map attached to this report as Appendix I, at an estimated total cost of \$206,000, which costs will be fully recovered by Local Area Service charges and will be apportioned based on final costs to the benefiting lots on a frontage basis all in accordance with City policy; and
- Authorize the City Clerk to bring forward the necessary LAS By-law for the required readings.

Vincent Lalonde, P.Eng.  
General Manager, Engineering

JA/GKC/brb

Appendix I - Site Map  
Appendix II - City Clerk's Certificate of Sufficiency  
Appendix III - Engineer's Report

# APPENDIX I PROJECT 4711-903

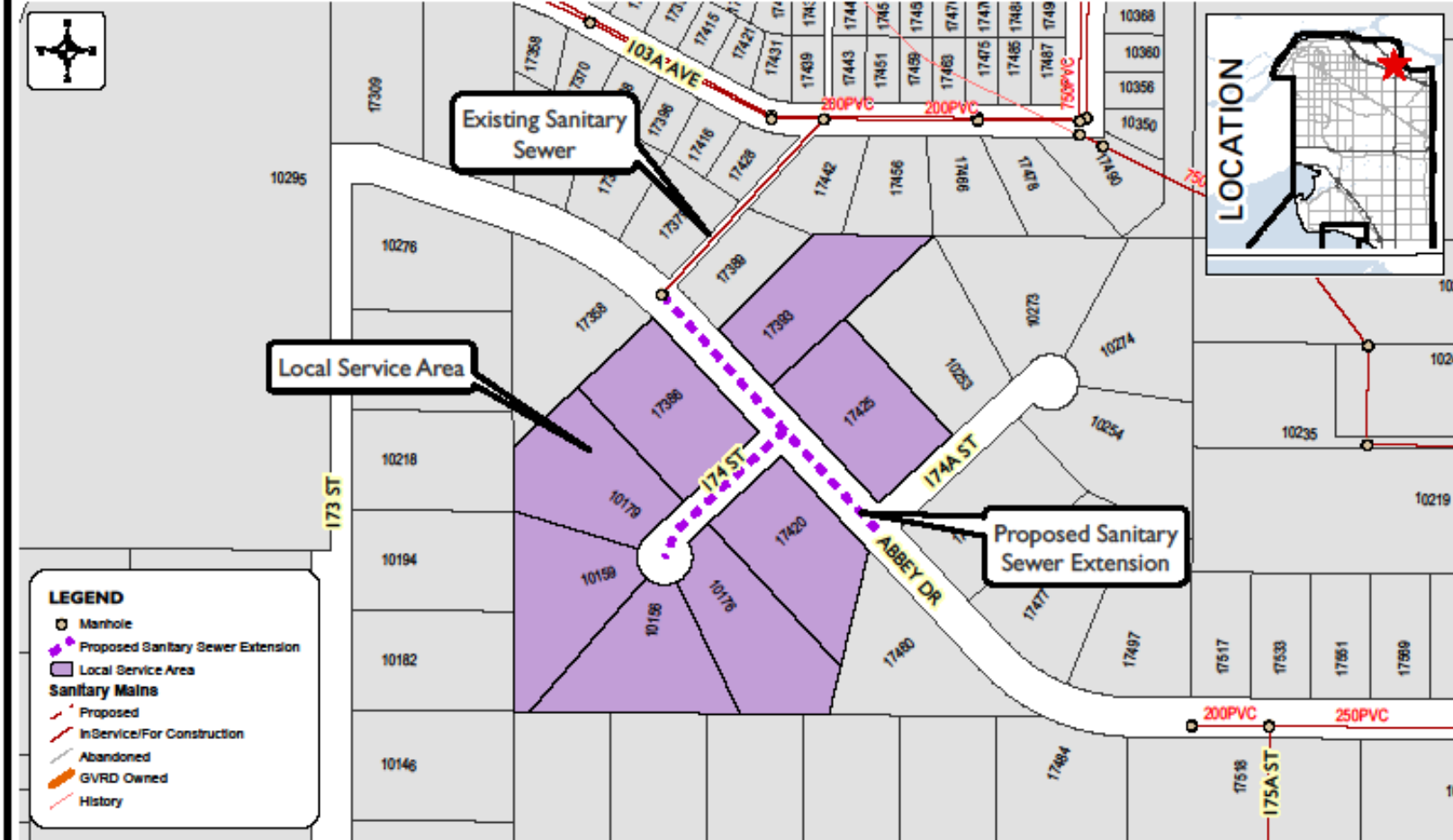

Produced by GIS Section: December 13, 2011, AWB



## SANITARY SEWER EXTENSION ON ABBEY DR FROM 17386 TO 174A ST AND IN THE 174 ST CUL-DE-SAC

ENGINEERING  
DEPARTMENT

The data provided is compiled from various sources and IS NOT warranted as to its accuracy or sufficiency by the City of Surrey.  
This information is provided for information and convenience purposes only.  
Lot sizes, legal descriptions and encumbrances must be confirmed at the Land Title Office.

G:\Mapping\GIS\Map\Corporal\partial\Eng-Utilities\AW-SanitarySewerExtensionAbbeyDr-A.mxd



**Certificate of Sufficiency**  
a formal petition for Local Area Service

---

Pursuant to Section 212, SBC Chap. 26 of the *Community Charter, I, Jane Sullivan*, the City Clerk for City of Surrey, British Columbia certify that a formal petition for undertaking the following work as a Local Area Service agreement has been received and is determined to be sufficient.

General Description of the Work: *Local Area Service*  
*Sanitary Sewer Extension on*  
*Abbey Drive from 17386 to*  
*174A Street and on*  
*174 Street cul-de-sac*

The Council may, by bylaw, undertake the work described above.

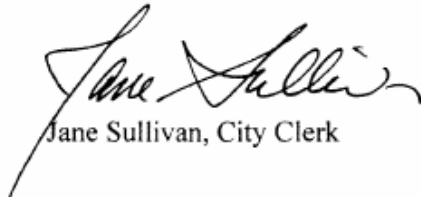
  
Jane Sullivan, City Clerk

Date: February 2, 2012

**CITY OF SURREY**  
**ENGINEER'S REPORT (\*)**  
**LOCAL AREA SERVICE – SANITARY SEWER MAIN EXTENSION**  
**By FORMAL PETITION**

Pursuant to Section 212 of the Community Charter, I wish to advise in regard to the following work resolved to be undertaken as a Local Area Service.

---

Location: Sanitary Sewer Main Extension along Abbey Drive from the western property line of #17386 to 174A Street and in the 174 Street cul-de-sac, as shown in Appendix I.

---

Total Estimated Cost	\$ 206,000(*)
Estimated Service connection Cost per property	\$4,000(*)
Total Frontage of the Properties in the Local Service Area	431.70 m
Cost Per Linear Metre for the LAS Cost Share	\$403.06(*)
Amortization Period	15 years
Annual Interest Rate	5.75%(*)

---

**Cost Distribution**

Address			Adjusted Frontage (m)	Total Costs Per Lot	Annual payment over 15 years
House	Road	PID			
17386	Abbey Drive	002-128-161	51.70	\$ 24,838.08	\$ 2,515.79
10179	174 Street	002-129-094	50.00	\$ 24,152.88	\$ 2,446.39
10159	174 Street	002-128-489	50.00	\$ 24,152.88	\$ 2,446.39
10156	174 Street	002-128-667	50.00	\$ 24,152.88	\$ 2,446.39
10176	174 Street	000-514-438	50.00	\$ 24,152.88	\$ 2,446.39
17420	Abbey Drive	002-128-594	50.00	\$ 24,152.88	\$ 2,446.39
17393	Abbey Drive	000-622-427	50.00	\$ 24,152.88	\$ 2,446.39
17425	Abbey Drive	002-127-695	80.00	\$ 36,244.61	\$ 3,671.13
			<b>431.70</b>	<b>\$ 206,000.00</b>	

(\*) All costs are estimates only. A revised Engineer's Report with the actual final cost and the appropriate interest rate for amortization will be prepared upon completion of the work.