



# Corporate Report

NO: R189

COUNCIL DATE: September 11, 2006

---

## REGULAR COUNCIL

TO: **Mayor & Council** DATE: **September 7, 2006**  
FROM: **Acting General Manager, Planning and Development** FILE: **3900-20-16100**  
SUBJECT: **New Tree Protection Bylaw**

---

## RECOMMENDATION

It is recommended that Council:

1. Receive this report as information; and
2. Endorse the addition of several provisions to the new Surrey Tree Protection Bylaw, 2006, No. 16100 (the "new Bylaw"), as described in this report; and
3. Authorize the City Clerk to bring forward the proposed new Bylaw, attached as Appendix I to this report, for consideration of the required readings and adoption by Council.

## INTENT

This report summarizes the main features and provisions of the new Bylaw, outlines recommended additional housekeeping provisions, and provides a comparison between the provisions of the current Tree Preservation Bylaw, 1996, No. 12880 (the "current Bylaw") and the provisions of the new Bylaw, based on recommendations adopted by Council on July 25, 2005 (Corporate Report No. R185) and on February 20, 2006 (Corporate Report No. C003) and further amendments, as documented in this report.

## BACKGROUND

The current Bylaw was adopted 10 years ago, on July 29, 1996. Due to the rapid and sustained growth and development that has occurred in the City since that time, some weaknesses in the current Bylaw have become evident, primarily in relation to addressing issues generally arising from the conflicting objectives of tree preservation and economic development. Corporate Report No. R185, outlined the issues and suggested various ways to improve the administrative and enforcement capability of the City to preserve

and protect existing trees without unduly compromising development potential of property. After an extensive consultative process involving the Agricultural Advisory Committee, the Environmental Advisory Committee, the Heritage Advisory Commission, the Development Advisory Committee, Surrey Environmental Partners, Friends of Semiahmoo Trail, over 40 other groups and community associations, and the general public in the City, to discuss and obtain input on the proposed bylaw amendments, a second Corporate Report, No. C003, was presented to Council with recommendations for additional bylaw provisions and improvements. Council approved all recommendations contained in the two Corporate Reports for improvement to the current Bylaw. Council has also authorized the City Clerk to bring forward the necessary amendment bylaw for the required readings.

The new Bylaw has been drafted, based on the recommendations previously approved by Council.

## **DISCUSSION**

### **Objectives of the New Tree Protection Bylaw**

The objectives of the new Bylaw, as described in Corporate Report No. R185, are:

- To provide incentives to encourage the retention and replacement of trees;
- To provide flexibility to better facilitate retention and replacement of trees;
- To clarify and identify the trees to be protected and for replacement;
- To increase incentives for successful tree retention and replacement;
- To clarify and improve the administration and enforcement of the new Bylaw; and
- To identify and prescribe practice standards for tree retention and replacement.

### **Main Features of the New Bylaw**

The new Bylaw contains 75 Sections in 12 Parts and 6 Schedules. The attached Appendix II outlines all these Sections and compares them with the current Bylaw and the recommendations approved by Council under Corporate Report Nos. R185 and C003. Additional recommended sections not previously considered by Council and recommended housekeeping sections related to administration and/or enforcement purposes are also listed in Appendix II.

The main elements of the new Bylaw are briefly described below:

- **Part 1 - Introductory Provisions**

The Definitions Section is expanded significantly. It now contains 28 terms, including "tree survey" and "specimen quality tree", to provide greater clarification and certainty in the interpretation of the new Bylaw (Section 2).

- **Part 2 - Application and Exemptions**

The new Bylaw applies only to protected trees. (Protected trees are defined in the new Bylaw to include any tree 30 centimetres or more in diameter at breast height (DBH), replacement trees, a tree planted or retained as a condition of development approval, a tree located within an Environmentally Sensitive Area, a specimen quality tree, a significant tree, a tree with evidence of nesting, and nine specific species of trees as listed in the new Bylaw) (Section 3).

The new Bylaw does not apply to trees located on parkland, utility rights-of-way, and roads (Sections 4-5).

- **Part 3 - Prohibitions**

No person is allowed to cut or remove a protected tree without a permit, except as otherwise permitted in the new Bylaw (Section 6).

A person may cut a protected tree without having obtained a permit if it poses an imminent danger (Section 7).

An arborist who assesses a tree and submits a report to the City recommending the removal of a tree cannot also cut that same tree (Section 9).

- **Part 4 - Offences**

The fine for violating the new Bylaw is set at \$50 minimum and \$10,000 maximum; and each violation and each day a violation is permitted to exist constitute a separate offence (Sections 10-11).

- **Part 5 - Penalties**

In addition to the fines prescribed in Part 4, an offender of the new Bylaw shall be subject to the penalties imposed in the new Bylaw and shall plant replacement trees as required by the new Bylaw. The penalties are \$1,000 for a protected tree, \$10,000 for a significant tree and \$2,000 for a specimen quality tree (Sections 12-15 and 20).

If a tree is removed that was identified as a tree to be retained in an approved tree preservation plan, a replacement tree shall be planted at the exact location as the tree that was removed without authorization (Section 12(b)).

If the offender refuses to plant replacement trees, the City may enter the property to plant the required trees at the owner's expense, and use the related security to cover the costs or, alternatively, add the costs to the property taxes for the property on which the replacement trees are planted (Sections 17-19).

- **Part 6 - Significant Trees**

A significant tree cannot be removed unless it has been removed from the Schedule of Significant Trees (Section 23).

A significant tree cannot be pruned without a permit. No fee is required for such a permit (Section 22).

- **Part 7 - Tree Cutting Permit**

A permit is required to cut or remove a protected tree, and the permit shall identify the number, size, species and location of replacement trees and the required security. A notice of the tree cutting permit must be posted on the lot, prior to commencement of tree removal on the lot (Sections 25-26).

Pruning of a protected tree must be in accordance with sound arboricultural practice, and excessive lift pruning, exceeding one-third of the height of the tree, is not permitted (Section 27).

A tree cutting permit may be issued only in certain circumstances, including: hazardous trees, as certified by an arborist, trees impairing or interfering with utilities, trees at the locations that would cause undue hardship to development, and tree removal necessary for agricultural uses (Section 29).

A tree cutting permit may be issued if the General Manager is satisfied with a report and the reasons in the report that the tree is inappropriate for its location (Section 30).

The General Manager may require that a tree survey and/or preliminary lot grading and servicing plan accompany the tree cutting permit application (Section 32), and may require an independent arborist report, which may be at the applicant's expense if the report submitted by the applicant is found incomplete or inaccurate (Section 34).

- **Part 8 - Permit Fees and Securities**

Application fees for a tree cutting permit are being increased by 10%, except for lands within the Agricultural Land Reserve (the "ALR") for which the fees will remain unchanged, and a permit amendment fee of \$60 is being introduced (Sections 36-40).

Securities for replacement trees are required and the amount of security is based on the size of the replacement trees (i.e., \$300 and \$600 for 5 centimetre and 8 centimetre calliper trees, respectively (Sections 42-45).

Securities for the trees to be retained in a proposed development are \$10,000, \$5,000, and \$3,000 for each significant tree, specimen quality tree and protected tree, respectively, and a maximum security for a development is set at \$100,000 (Section 46).

- **Part 9 - Replacement Trees**

Replacement trees shall be required on each lot from which any protected tree is cut, removed or damaged (Section 50). Replacement trees must be provided within a specific period of time (generally 90 days) and planted in accordance with sound arboricultural practice. (Sections 51-56).

The number of required replacement trees shall be two for each protected tree removed or damaged. If the lot cannot accommodate the required number of replacement trees the owner shall pay cash-in-lieu at a rate of \$300 for each replacement tree (Section 57). The total amount of cash-in-lieu of replacement trees shall not exceed \$15,000 per acre of the lot from which the trees are removed (Section 59).

Up-sizing of a replacement tree may be required if the required number of replacement trees cannot be accommodated on a lot. The security for an upsized replacement tree will be \$600 per tree (Sections 58 and 61).

The minimum number of replacement trees for each of several different sizes of single family lots is prescribed (Section 60).

A retained tree that is not a protected tree may be considered as a credit to reduce the required number of replacement trees (Section 62).

- **Part 10 - Tree Protection**

A tree protection barrier must be installed and maintained around trees that are to be retained within a development site, in accordance with the requirements of the new Bylaw, if the drip line of the protected tree is within 4 metres of any excavation, construction, or engineering works, and site disturbance within the area defined by the tree protection barrier is prohibited (Sections 63-67).

- **Part 11 - Inspection and Assessment**

In addition to specific City staff, a qualified expert retained by the General Manager is also authorized to enter into a property for inspection of potential violations of the new Bylaw and/or to assess any tree or tree remains on the property (Section 68). **(This bylaw provision is expanded to also authorize a City engaged expert to enter the property to conduct tree assessments).**

Removal of the trunks, limbs and/or remains of any cut or damaged tree is prohibited until an investigation and assessment by the General Manager is completed and the removal is authorized (Section 69). **(This is a new bylaw provision to prohibit removal of the illegally cut trees from the property while City investigation is still underway).**

Once replacement trees are planted, the owner may either request that City staff inspect the trees to confirm that they are installed properly or, alternatively, engage a landscape architect to submit an inspection report to the City (Section 70). A re-inspection fee of \$75 is imposed if re-inspection is required (Section 71).

- **Part 12 - General Provisions**

The new Bylaw takes effect immediately on the date of final adoption, except that a grace period of 12 months is provided for in-stream development applications,

including rezoning, subdivision, development permit and building permit applications for which the current Bylaw still applies (Section 72). **(The recommendation approved by Council under Corporate Report No. C003 provides a grace period for in-stream development permit and building permit applications only. This new Bylaw section has expanded the provision to include in-stream rezoning and subdivision applications as well.)**

- **Schedules**

Schedule "A" shows the Environmentally Sensitive Areas in which all trees are defined as protected trees under the new Bylaw.

Schedule "B" provides an updated and augmented list of significant trees.

Schedule "B1" shows the Semiahmoo Trail Tree Protection Areas in which all the trees are defined as significant trees under the new Bylaw.

Schedule "C" is the tree cutting permit application form and provides the standard format for a tree survey and arborist report.

Schedule "D" is the standard tree cutting permit.

Schedule "E" provides a list of acceptable replacement trees.

Schedule "F" provides the detail for a standard tree protection barrier.

### **Legal Services Review**

Legal Services has reviewed this report and the proposed new Bylaw and have no concerns.

### **CONCLUSION**

The preparation of the new Bylaw, attached as Appendix I to this report, has involved a long and meticulous process, following a very extensive consultation process involving various committees, the development industry, other interest groups, and the general public. The new Bylaw is considered to represent a balanced approach that attempts to maximize tree protection without unduly restricting land development or property rights. Enforcement provisions have been enhanced and improved in the new Bylaw. For example, for those who cut, remove or damage existing trees without a permit, the new Bylaw imposes tougher fines and penalties, and required planting of replacement trees at the same location where the protected trees are illegally removed.

While a vast majority of the sections were drafted on the basis of the recommendations presented in the previous Corporate Reports approved by Council, a few new provisions aimed at further improving enforcement capability have been added, together with some necessary housekeeping sections. These sections have been specifically highlighted in this report and in Appendix II. It is recommended that Council endorse these new sections and authorize staff to bring forward the new Bylaw for the necessary readings.

How Yin Leung  
Acting General Manager  
Planning and Development

HYL:saw

Attachments:

Appendix I      Surrey Tree Protection Bylaw, 2006, No. 16100  
Appendix II     Summary and Comparison Table

Appendix I  
Surrey Tree Protection Bylaw, 2006, No. 16100  
(next page)



# City of Surrey



**SURREY**  
CITY OF PARKS

## **"Surrey Tree Protection Bylaw, 2006 No. 16100"**

**A Bylaw to regulate and prohibit the cutting, removal and damage of trees, the setting of fees and issuance of permits for the same and the requirement for replacement trees and of security for their provision and maintenance.**

# INDEX

<b>PART 1</b> .....	<b>1</b>
INTRODUCTORY PROVISIONS .....	1
<b>PART 2</b> .....	<b>5</b>
APPLICATION AND EXEMPTIONS .....	5
<b>PART 3</b> .....	<b>5</b>
PROHIBITIONS .....	5
<b>PART 4</b> .....	<b>6</b>
OFFENCES .....	6
<b>PART 5</b> .....	<b>6</b>
PENALTIES .....	6
<b>PART 6</b> .....	<b>8</b>
SIGNIFICANT TREES .....	8
<b>PART 7</b> .....	<b>8</b>
TREE CUTTING PERMITS .....	8
<b>PART 8</b> .....	<b>11</b>
PERMIT FEES AND SECURITIES .....	11
<b>PART 9</b> .....	<b>15</b>
REPLACEMENT TREES .....	15
<b>PART 10</b> .....	<b>17</b>
TREE PROTECTION .....	17
<b>PART 11</b> .....	<b>17</b>
INSPECTION AND ASSESSMENT .....	17
<b>PART 12</b> .....	<b>18</b>
GENERAL PROVISIONS .....	18
<b>SCHEDULE "A"</b> .....	<b>A1</b>
ENVIRONMENTALLY SENSITIVE AREAS .....	A1
<b>SCHEDULE "B"</b> .....	<b>B1</b>
SIGNIFICANT TREES .....	B1
<b>SCHEDULE "B1"</b> .....	<b>B10</b>
SEMIAHMOO TRAIL .....	B10
<b>SCHEDULE "C"</b> .....	<b>C1</b>
APPLICATION FOR TREE CUTTING PERMIT .....	C1

**SCHEDULE "D" ..... D1**  
    TREE CUTTING PERMIT ..... D1

**SCHEDULE "E" ..... E1**  
    ACCEPTABLE REPLACEMENT TREES ..... E1

**SCHEDULE "F" ..... F1**  
    TREE PROTECTION BARRIER DETAIL ..... F1

CITY OF SURREY

BYLAW NO. 16100

A Bylaw to regulate and prohibit the cutting, removal and damage of trees, the setting of fees and issuance of permits and the requirement for replacement trees and of security for their provision and maintenance.

.....

- (a) WHEREAS pursuant to Sections 8(3)(c) and 50 to 52 of the *Community Charter*, S.B.C. 2003, c. 26, a city may, by bylaw, exercise certain powers to preserve and protect trees within the city, regulate the cutting and removal of trees and require their replacement;
- (b) AND WHEREAS Council considers it is in the public interest to provide for the protection and preservation of trees, the regulation of their cutting and removal and their replacement;

Under its statutory powers, including Sections 8(3)(c) and 50 to 52 of the *Community Charter*, S.B.C. 2003, c. 26, the Council of the City of Surrey, in open meeting assembled, enacts the following provisions:

**Part 1**  
**Introductory Provisions**

**Title**

- 1. This Bylaw may be cited as "Surrey Tree Protection Bylaw, 2006, No. 16100".

**Definitions**

- 2. In this Bylaw,

**"agricultural use"**

means the use of land for the growing of crops or the raising of livestock as permitted under the Zoning Bylaw.

**"arborist"**

means an arborist who:

- (a) is certified by the International Society of Arboriculture; and

(b) has had training and experience in tree hazard assessment.

**"City"**

means the City of Surrey.

**"City Landscape Architect"**

means a person employed by the City and designated by the General Manager as the City's landscape architect.

**"Council"**

means the municipal Council of the City of Surrey.

**"cut"**

means to cut down a tree and shall include to pull up, push or pull over or otherwise fall a tree. **"Cutting"** shall have the corresponding meaning.

**"damage"**

means any action which will cause a tree to die or to decline, including, but not limited to, ringing, poisoning, burning, excessive pruning, excessive crown lifting, or pruning in a manner not in accordance with "American National Standards Institute Publication A300-1995" and the companion publication "Best Management Practices – Tree Pruning, 2002". **"Damaged"** and **"damaging"** shall have the corresponding meaning.

**"D.B.H."**

means the diameter of a tree at roughly breast height or 1.4 metres [4.6 feet] above the highest point of the natural grade of the ground measured from the base of a tree. For multi-stemmed trees, each stem shall be measured 1.4 metres [4.6 feet] above the highest point of the natural grade and the D.B.H. of the tree shall equal the cumulative total of the D.B.H. of all stems.

**"drip line"**

means a horizontal line on the ground encircling a tree corresponding to the furthest extension of the branches of a tree.

**"engineer"**

means a person registered or licensed as a professional engineer pursuant to the provisions of the *Engineers and Geoscientists Act*, R.S.B.C. 1996, c. 116, as amended.

**"General Manager"**

means the person appointed by Council as the General Manager of Planning and Development or the duly authorized representative.

**"landscape architect"**

means a landscape architect registered with the British Columbia Society of Landscape Architects.

**"Landscape Technician"**

means the person employed by the City and designated by the General Manager as the City's landscape technician.

**"lot"**

means land designated as a separate and distinct parcel on a legally recorded subdivision plan or description filed in the records of the Land Title Office.

**"natural causes"**

means death or decline of a tree as a result of natural diseases, pests, climactic conditions, inherent structural defects, or senescence.

**"owner"**

means the registered owner in fee simple of a lot upon which a tree is located.

**"protected tree"**

means:

- (a) any tree, including multi-stemmed trees, within the City, regardless of species, having a D.B.H. of 30 centimetres [11.8 inches] or more;
- (b) a replacement tree;
- (c) a tree planted or retained as a requirement of a subdivision application, development permit, development variance permit, building permit or demolition permit;
- (d) a tree located within a high sensitivity area as identified on the "City of Surrey Environmentally Sensitive Areas Map" described in SCHEDULE "A";
- (e) a specimen quality tree;
- (f) a significant tree;

- (g) a tree with evidence of nesting or use by:
  - (i) raptors as defined in the *Wildlife Act*, R.S.B.C. 1996, c. 488,
  - (ii) osprey, or
  - (iii) a heron colony;
- (h) the following tree species of any size:
  - (i) Arbutus (*Arbutus menziesii*),
  - (ii) Garry Oak (*Quercus garryana*),
  - (iii) Pacific Dogwood (*Cornus nutalii*),
  - (iv) Pacific Yew (*Taxus brevifolia*),
  - (v) Coast Redwood (*Sequoia sempervirens*),
  - (vi) Dawn Redwood (*Metasequoia glyptostroboides*),
  - (vii) Giant Redwood (*Sequoiadendron giganteum*),
  - (viii) Maidenhair Tree (*Ginkgo biloba*), and
  - (ix) Monkey Puzzle Tree (*Araucaria araucana*).

**"replacement tree"**

means a tree required to be planted to replace a tree cut, removed or damaged in accordance with this Bylaw.

**"remove"**

means to cut a tree and to remove it from the lot where it exists. **"Removed"**, **"removal"** and **"removing"** shall have the corresponding meaning.

**"significant tree"**

means a tree listed in SCHEDULE "B" and SCHEDULE "B1".

**"sound arboricultural practice"**

means tree planting, pruning and maintenance practices endorsed by the International Society of Arboriculture.

**"specimen quality tree"**

means a tree of any size which an arborist, a landscape architect, or the General Manager deems to be of exceptional value because of its species, condition, form, age or size but which has not been designated by Council to be a significant tree.

**"tree cutting permit"**

means the written authority granted by the General Manager pursuant to this Bylaw for the cutting or removal of a specified tree or trees.

**"tree protection barrier"**

means a barrier constructed around a tree in accordance with SCHEDULE "F" of this Bylaw to protect the tree from damage during site work or construction.

**"Tree Protection Bylaw Administrator"**

means a person employed by the City and designated by the General Manager to oversee the implementation of this Bylaw.

**"tree protection zone"**

means the area within a tree protection barrier.

**"tree survey"**

means a survey plan prepared by an engineer or by a surveyor registered as a British Columbia land surveyor, that illustrates the location of trees in relation to the property lines of a lot, along with the size and species of each tree, plus any other information required by the General Manager for the purpose of assessing a tree cutting permit application.

**"Zoning Bylaw"**

means Surrey Zoning Bylaw, 1993, No. 12000, as may be amended or replaced from time to time.

**Part 2  
Application and Exemptions**

3. This Bylaw applies to protected trees and to no other trees.
4. This Bylaw does not apply to protected trees, that are cut, removed or damaged, pursuant to the *Hydro and Power Authority Act*, R.S.B.C. 1996, c. 212 or the *Pipeline Act*, R.S.B.C. 1996, c. 364.
5. This Bylaw does not apply to trees on City-owned property or highways that are cut or removed by the City or its authorized agents in accordance with approved City operations.

**Part 3  
Prohibitions**

6. No person shall cut, remove or damage any protected tree or cause, suffer or permit any such tree to be cut, removed or damaged, except where permitted by and in accordance with the terms of this Bylaw.
7. In the event that a protected tree is in imminent danger of falling and injuring persons or property due to natural causes, and it is not possible to obtain a tree cutting permit prior



to the tree falling, the owner may cut the tree or have it cut, but shall report the cutting of the tree to the General Manager within the next business day. The owner shall not remove the tree from the lot until the City has visited the lot and confirmed that the tree was in imminent danger of falling and injuring persons or property. If the City determines that the tree was not in imminent danger, or was in imminent danger, but due to reasons other than natural causes, the City may impose a penalty on the owner in accordance with Part 5.

8. No person shall fail to comply with the terms and conditions of a tree cutting permit issued pursuant to this Bylaw.
9. An arborist or arboricultural firm that declared a tree to be hazardous under Part 7, Section 29(a), or any arborist or arboricultural firm that submitted any report to the City as a requirement of this Bylaw, cannot also cut, remove or damage that same tree that the arborist or firm assessed.

#### **Part 4 Offences**

10. Every person is guilty of an offence against this Bylaw and is liable to a fine of not less than FIFTY (\$50.00) DOLLARS and not more than TEN THOUSAND (\$10,000.00) DOLLARS per offence, who:
  - (a) cuts, removes or damages a tree contrary to this Bylaw or contrary to the terms and conditions of a tree cutting permit;
  - (b) violates any of the provisions of this Bylaw or a tree cutting permit;
  - (c) suffers or permits any act or thing to be done in contravention or violation of any provision of this Bylaw or a tree cutting permit; or
  - (d) omits to do or refrains from doing anything required to be done by any of the provisions of this Bylaw or a tree cutting permit.
11. For the purposes of this Bylaw, each tree cut, removed or damaged in violation of this Bylaw and each day that a violation of this Bylaw is caused or permitted to exist by any person, shall constitute a separate offence.

#### **Part 5 Penalties**

12. In addition to any prosecution pursuant to Part 4 of this Bylaw, where an owner cuts, removes or damages, or suffers or permits any tree to be cut, removed or damaged, in contravention of this Bylaw, or in excess of any permission, or in violation of any terms and conditions of a tree cutting permit issued pursuant to this Bylaw, the owner shall pay the penalties imposed under this Part 5 and:

- (a) shall plant on the same parcel of land the number, size and species of replacement trees required by this Bylaw, as determined by the General Manager in accordance with this Bylaw; and, in addition,
  - (b) where the tree cut, removed or damaged is identified in a tree preservation plan approved by the City as a tree to be retained or protected, then the General Manager may require the owner to plant the replacement trees at the exact location as the tree that has been cut, removed or damaged and may require that any building or structure shall not be located within the drip line of the replacement trees at full growth.
- 13. The penalty for cutting, removing or damaging a protected tree, other than a significant tree or a specimen quality tree, is ONE THOUSAND (\$1,000.00) DOLLARS per tree, or the loss of any securities provided to the City to ensure protection and preservation of the tree, whichever amount is greater. The size, number, species and location of replacement trees and amount of securities required to ensure the planting and maintenance of replacement trees, is to be determined by the General Manager, based on the size, condition, species and location of the tree cut, removed or damaged in contravention of this Bylaw.
- 14. The penalty for cutting, removing or damaging a significant tree is TEN THOUSAND (\$10,000.00) DOLLARS per tree. The size, number, species and location of replacement trees, and amount of securities required to ensure the planting and maintenance of replacement trees, is to be determined by the General Manager based on the size, condition, species and location of the tree cut, removed or damaged in contravention of this Bylaw.
- 15. The penalty for cutting, removing or damaging a specimen quality tree is TWO THOUSAND (\$2,000.00) DOLLARS per tree, or the loss of any securities provided to the City to ensure protection and preservation of the tree, whichever amount is greater. The size, number, species and location of replacement trees and amount of securities required to ensure the planting and maintenance of replacement trees is to be determined by the General Manager, based on the size, condition, species and location of the tree cut, removed or damaged in contravention of this Bylaw.
- 16. The size, number, species and location of replacement trees required as a penalty under this Part 5 and the amount of securities required to ensure their planting and maintenance will be determined by the General Manager and is dependent upon the value of the tree removed and conditions of the lot where the replacement trees are to be planted. Where upsized replacement trees are required by this Bylaw, the amount of the securities will reflect the value of the upsized trees and the related planting and maintenance costs.
- 17. Except as specified in Section 48, if the owner fails or refuses to plant the required number, size and type of replacement trees in the specified locations within four (4) months of receiving written direction from the General Manager to do so, the City may use the security collected to either have the trees planted onto the owner's lot or use the securities to plant trees elsewhere on City-owned property.

18. If an owner fails or refuses to plant the required number, size and type of replacement trees in the specified locations after receiving written direction from the General Manager to do so, the City, by its employees or other persons, at reasonable times and in a reasonable manner, may enter the owner's lot and fulfill the requirement by planting the replacement trees at the expense of the owner.
19. In the event that the owner of the lot described in Section 18 fails to pay the costs of compliance before the 31<sup>st</sup> day of December in the year following the year that the compliance was effected by the City, the costs shall be added to and form part of the taxes payable on the lot as taxes in arrears.
20. Prosecution of a person pursuant to Part 4 of this Bylaw does not exempt the person from the provisions of Part 5 of this Bylaw.

### **Part 6 Significant Trees**

21. The owner of a significant tree shall maintain or cause to maintain the tree in accordance with sound arboricultural practice.
22. No person shall prune the branches or roots of a significant tree without first obtaining a tree cutting permit to do so in accordance with Part 7. There is no fee for such a permit.
23. A significant tree shall not be cut, removed or damaged in any way unless it is first removed from SCHEDULE "B" by an amendment to this Bylaw.
24. The General Manager, with the consent of the owner of the significant tree, may direct that a plaque or marker, that provides information about the significant tree, be placed near the significant tree.

### **Part 7 Tree Cutting Permits**

25. A person wishing to cut or remove a protected tree shall apply to the General Manager for a tree cutting permit to cut or remove the tree. A tree cutting permit application shall be substantially in the form of SCHEDULE "C". The tree cutting permit shall be substantially in the form of SCHEDULE "D". The tree cutting permit shall determine the number, size, species and location of replacement trees and required security.
26. Notice of the tree cutting permit shall be posted on the lot for which a tree cutting permit has been issued in a location visible to the public, prior to the commencement of any cutting or removal of a protected tree and shall remain posted on the lot until the completion of all work related to the cutting or removal of protected trees on the lot. The notice shall include a copy of the tree cutting permit, identify by species and location the trees which are to be cut or removed and provide a contact number for the permit holder and the City.
27. A tree cutting permit is not required for the pruning of a protected tree, other than a significant tree, in accordance with sound arboricultural practice. The pruning and

treatment of diseased trees in accordance with sound arboricultural practice, shall be practiced where possible and practical as an alternative to the cutting or removal of a protected tree. Sound arboricultural practice shall not include the lift pruning of lower limbs to the extent that the branches on the bottom thirty percent (30%) of the total height of the protected trees are pruned or removed, and shall not include the topping of protected trees, except where the trees have previously been topped.

28. The fee for the tree cutting permit shall be determined as set out in Part 8 and shall be paid upon application for the permit. No fee is required for a tree cutting permit issued:
  - (a) pursuant to Part 7, Section 29(a);
  - (b) pursuant to Part 7, Section 29(b); or
  - (c) pursuant to Part 7, Section 31.
  
29. Subject to Part 7, Section 35, a tree cutting permit to cut or remove a protected tree, other than a significant tree, may be issued by the General Manager only in the following circumstances:
  - (a) where an arborist provides a report to the satisfaction of the General Manager that a tree is an unreasonable hazard to the safety of persons or property, or where the applicant has otherwise demonstrated to the satisfaction of the General Manager that the tree is hazardous, dead, damaged, diseased or in decline beyond expectation of recovery;
  - (b) where the General Manager, or his or her duly authorized representative, or an engineer employed by any public utility or an arborist certifies that in his or her opinion a tree is impairing, interfering with, or presents a risk or hazard to the operation of sewers, drains, water lines, septic fields, electrical lines, poles or other similar equipment and appurtenances and that the impairment, interference or risk cannot be reduced or removed in any way other than the removal of the tree;
  - (c) where the tree prevents the owner of the lot on which the tree is located from developing or using a lot in a manner permitted under the Zoning Bylaw, and the development or use cannot be modified to accommodate the tree without causing the owner undue hardship as determined by the General Manager;
  - (d) where the tree is situated within two (2) metres of an existing building foundation wall permitted pursuant to the Zoning Bylaw, or where a building permitted under the Zoning Bylaw is proposed and the building shape cannot be modified to accommodate the tree without causing the owner undue hardship as determined by the General Manager;
  - (e) where the tree is situated on a lot within the Agricultural Land Reserve, which is zoned to permit agricultural use and the application is accompanied by a sworn declaration of the owner declaring that the tree is to be cut or removed to permit agricultural use, that the agricultural use cannot be located elsewhere on the lot so

as to accommodate the tree, and that the owner agrees in writing that no application for subdivision, rezoning, or development of that lot will be accepted by the City for a period of five (5) years commencing on the date of issuance of the tree cutting permit; or

- (f) where the tree is situated on a lot outside the Agricultural Land Reserve, which is zoned to permit agricultural use and the application is accompanied by an arborist report and by a sworn declaration of the owner declaring that the tree is to be cut or removed to permit agricultural use, that the agricultural use cannot be located elsewhere on that lot so as to accommodate the tree, and where the owner enters into a restrictive covenant registered on the title of the lot documenting that the owner has agreed not to make application for development of the lot for a period of ten (10) years, and that full replacement trees and all other applicable provisions of this Bylaw, as determined by the General Manager, will apply should the development application be considered for the lot within the ten (10) year period.
30. The General Manager may issue a tree cutting permit for the removal of a protected tree other than a significant tree where the owner submits a report by a landscape architect or an arborist, which documents that the protected tree, by virtue of its size and species, is inappropriate for its location and the reasons that it is deemed to be inappropriate for its location, all to the satisfaction of the General Manager. The General Manager shall determine the number, size, species and location of replacement trees and required securities.
31. A tree cutting permit will be issued for the pruning of a significant tree where the owner submits a report by an arborist, which certifies that the pruning is necessary and where this report is approved by the city landscape architect, the Tree Protection Bylaw Administrator or an arborist chosen by the City, in which case the General Manager may require, as a condition of the tree cutting permit, that all pruning activity be carried out under the on-site supervision of an arborist.
32. The General Manager may, as a condition of any tree cutting permit:
- (a) require that a tree survey, an arborist's report in accordance with SCHEDULE "C", or both, accompany the tree cutting permit application;
  - (b) require that preliminary lot grading and servicing plans accompany the tree cutting permit application;
  - (c) require that the cutting and removal of trees or specific trees be carried out under the supervision of an arborist;
  - (d) recommend the treatment of diseased trees in accordance with sound arboricultural practice as an alternative to the removal of a protected tree; and
  - (e) determine the location, number, species and size of replacement trees required.

33. The General Manager may revoke a tree cutting permit if the terms and conditions of the permit have been breached or the information supplied by the applicant in support of the permit is found by the General Manager to have been inaccurate, incomplete or erroneous.
34. The General Manager may retain the services of an independent arborist to review the report of an arborist that has submitted a report to the City under the provisions of this Bylaw, in support of an application for a tree cutting permit, in instances where the completeness or accuracy of the report are brought into question through a field inspection by the City Landscape Architect, Tree Protection Bylaw Administrator or the Landscape Technician. Where the original arborist report submitted to the City is shown to be incomplete or inaccurate, the cost of the independent arborist's report shall be paid by the owner and collected by the City, prior to the adoption of the related rezoning or the subdivision approval or the issuance of the related tree cutting permit, whichever comes first.
35. The General Manager may refuse to grant a tree cutting permit for trees located with the high sensitivity area as described in SCHEDULE "A".

## **Part 8 Permit Fees and Securities**

### **Permit Fees**

#### **36. Existing Lots Where No Subdivision is Proposed**

On existing lots zoned for residential use where no subdivision is proposed, as well as on lots zoned for commercial, industrial, or institutional use where neither subdivision, consolidation, nor any development requiring a development permit or development variance permit is proposed, the fee for a tree cutting permit shall be a FIFTY-FIVE (\$55.00) DOLLAR base fee plus TWENTY (\$20.00) DOLLARS for every protected tree removed.

#### **37. Proposed Subdivisions for Single Family Residential Lots**

The following table shall be used to calculate the fee for a tree cutting permit for proposed subdivisions involving single family residential lots:

Zone and Lot Size	First 5 Proposed Lots	Second 5 Proposed Lots	Next 10 Proposed Lots	Proposed Lots over first 20 Lots
RF-12, and RF-G, RF-9, RF-12C and RF-9C Lots smaller than 340 m <sup>2</sup>	\$70 per proposed Lot	\$59 per proposed Lot	\$30 per proposed Lot	\$24 per proposed Lot
RF, RF-G Lots greater than or equal to 340 m <sup>2</sup> , RF-SS, R-F(R), R-F(F), R-F(C)	\$95 per proposed Lot	\$84 per proposed Lot	\$41 per proposed Lot	\$35 per proposed Lot
RH, RH-G, R-1, R-H(G)	\$112 per proposed Lot	\$107 per proposed Lot	\$47 per proposed Lot	\$41 per proposed Lot
RA, RA-G, RC, R-S, R-A(G)	\$355 per acre	\$330 per acre	\$296 per acre	\$119 per acre

38. **Proposed Multi-Family Residential Lots, Commercial, Industrial and Institutional Lots (Other than those described in Part 8, Section 36**

The following table shall be used to calculate the fee for a tree cutting permit for sites proposed for multi-family residential, commercial, industrial and institutional use:

Zone Designation	First 5 Acres	Second 5 Acres	Over 10 Acres
RM-D, RM-M, RM-10, RM-15, RM-30, RM-45, RM-70, RM-135, RMC-135, RMC-150, RMS-1, RMS-1A, RMS-2, R-F(D), R-F(M), R-T(1), RM-1, RM-2, RM-3, RM-4, P-P, C-4, C-5, C-8, C8A, C-8B, C-15, C-35, CHI, CG-1, CG-2, CTA, CCR, CPR, CPG, CPM, C-L, C-R(1), CR(2), C-R(3). C-S, C-C, C-H, I-S, C-G(1), C-G(2), C-T(1), C-T(2), P-P(1), P-R, P-D, IB, IL, IH, IS, IA, CD, I-1, I-P(2), I-G, I-T, I-W, I-H, I-W, I-L(S), I-A, PC, PA-1, PA-2, PI	\$355 per acre	\$296 per acre	\$237 per acre

39. **Agricultural Lots**

The following table shall be used to calculate the fee for a tree cutting permit for sites zoned or proposed for agricultural use:

Zone Designation	First 5 Acres	Second 5 Acres	Over 10 Acres
A-1, A-2, A-3	\$296 per acre	\$267 per acre	\$213 per acre
A-2, A-2, A-3 within the ALR	\$269 per acre	\$243 per acre	\$194 per acre

For the purposes of Part 8, Section 39, the number of acres is based on the area to be cleared and not on the area of the entire lot.

- 40. Where a tree cutting permit must be amended to show a change in the number or location of trees to be retained or removed after the tree cutting permit has been issued, the permit holder will be required to pay a non-refundable permit amendment fee in the amount of SIXTY (\$60.00) DOLLARS.
- 41. For the purposes of determining the fees under Part 8, any lot against which a land use contract has been registered shall be deemed to have the zone underlying the applicable land use contract and lots zoned pursuant to Surrey Zoning Bylaw, 1979, No. 5942, as amended, shall be deemed to have the zoning which corresponds to the zone name in Zoning Bylaw, 1979, No. 5942, as amended.

**Securities**

- 42. Where replacement trees or retention of existing trees are required as a condition of a tree cutting permit or as part of a penalty for cutting, removing or damaging protected trees without a tree cutting permit or cutting, removing or damaging trees in excess of the number allowed by the tree cutting permit, the owner or person responsible for the cutting, removal or damage shall provide to the City a security deposit in cash or letter of credit in the amount specified on the tree cutting permit or a penalty notice, for the period and on the terms specified in Part 8 of this Bylaw. No interest shall be paid by the City on security deposits.
- 43. Any letter of credit required to be provided under this Bylaw shall be a clean, unconditional and irrevocable letter of credit drawn from a Canadian financial institution acceptable to the City and in a form acceptable to the City. If, for any reason, the irrevocable letter of credit ceases to be effective security or becomes unenforceable so as to remove or reduce its purpose as full security for the due and proper performance of the requirements of this Bylaw, the owner shall replace it with a further letter of credit acceptable to the City within twenty-one (21) days prior to the expiry of the letter of credit then held by the City. If the owner fails to do so, the City will draw down on the current letter of credit without notice or restriction and hold the monies in lieu thereof.
- 44. If at any time an owner fails to comply with the provisions of this Bylaw relating to requirements for retention of existing trees or replacement trees and their maintenance, the City may by its employees or others under its direction enter upon the lands that are the subject of the requirements to plant replacement trees or maintain protected trees and



for such purposes may draw upon the securities provided and expend the funds to cover all costs and expenses of so doing. Alternatively, the City may use the securities to plant trees elsewhere on any City-owned property.

45. The amount of the security for the provision, installation and maintenance of replacement trees, as may be required by this Bylaw, shall be as follows:
  - (a) THREE HUNDRED (\$300.00) DOLLARS per replacement tree where the replacement tree required is a five (5) centimetre caliper deciduous tree or a three (3) metre tall conifer;
  - (b) SIX HUNDRED (\$600.00) DOLLARS per replacement tree where the replacement tree required is an eight (8) centimetre caliper deciduous tree or a four (4) metre tall conifer;
  - (c) as specified by the General Manager when the replacement tree is other than the sizes listed in 45(a) or 45(b); and
  - (d) where the replacement trees are part of the overall landscaping required under a development permit, development variance permit or subdivision, the security is to be in the amount specified in the approved landscape cost estimate associated with the development permit, development variance permit or subdivision; and
  
46. The amount of security for the trees proposed to be retained as a requirement of a subdivision application, development permit, development variance permit, building permit or demolition permit shall be as follows:
  - (a) TEN THOUSAND (\$10,000.00) DOLLARS per significant tree;
  - (b) FIVE THOUSAND (\$5,000.00) DOLLARS per specimen quality tree;
  - (c) THREE THOUSAND (\$3,000.00) DOLLARS per protected tree other than 46(a) and 46(b) above; and
  - (d) The total amount of security deposited under Section 46 may not exceed ONE HUNDRED THOUSAND (\$100,000.00) DOLLARS for each tree cutting permit or for each subdivision application, development permit, development variance permit, building permit or demolition permit, to be held by the City for a period of two (2) years after final building approval to ensure that the trees are properly protected and maintained in accordance with this Bylaw and the tree cutting permit.
  
47. The amount of security held by the City under Section 45 shall be released in stages as provided in Sections 48 and 49. It will be a condition of the release of any security provided under this Bylaw, that the General Manager be satisfied that the owner has complied with the tree replacement and maintenance requirements of this Bylaw and the tree cutting permit.

48. Subject to Section 47, a security deposit collected to cover the cost and maintenance of a replacement tree, shall be reduced as follows:
- (a) by fifty (50%) percent of the original amount after the planting of replacement trees has been approved by the City in accordance with the inspection requirements as set out in Part 11; and
  - (b) by the balance of the deposit after one year from the date of the first reduction provided that the condition of the replacement trees has been approved by the City in accordance with the inspection requirements as set out in Part 11.
49. Subject to Section 47, a security deposit collected to cover the total costs of the required landscaping, including replacement trees, shall be reduced as follows:
- (a) by ninety (90%) percent of the original amount after the landscaping is completed and approved by the City in accordance with the inspection requirements set out in Part 11; and
  - (b) by the balance of the deposit after one year from the date of the first reduction provided that the landscaping is approved by the City in accordance with the inspection requirements set out in Part 11.

## **Part 9 Replacement Trees**

50. Replacement trees shall be required in accordance with this Bylaw for each lot from which any protected tree is cut, removed or damaged and must be of a species and size as listed in SCHEDULE "E" unless otherwise specified in the tree cutting permit, at the discretion of the General Manager. Replacement trees required pursuant to Part 5, shall be of a size, species and location as determined by the General Manager.
51. Replacement Trees must meet the plant condition and structure requirements set out in the latest edition of the BCSLA/BCLNA "B.C. Landscape Standard" and the CNTA "Canadian Standards for Nursery Stock" to be considered acceptable by the General Manager.
52. Replacement Trees must be planted and maintained in accordance with the requirements set out in the latest edition of the BCSLA/BCLNA "B.C. Landscape Standard".
53. Replacement Trees shall be planted, where possible, on the same lot as the trees that are cut or removed from the lot, to the extent that the lot will accommodate such replacement trees in accordance with sound arboricultural practice.
54. Where no construction or site disturbance is proposed that would affect the planting of replacement trees, the replacement trees must be planted within ninety (90) days of the date of issuance of the tree cutting permit.

55. Where a replacement tree is to be planted pursuant to Part 5 of this Bylaw, it must be planted within ninety (90) days of written notice being delivered to the owner by the City.
56. Where the planting of replacement trees would hinder proposed construction or where proposed construction would jeopardize the survival of replacement trees, the replacement trees must be planted within ninety (90) days of the final occupancy approval for the last building being constructed that would jeopardize the survival of the tree, but in any case, within three (3) years of the date of the issuance of the tree cutting permit when the date of construction completion is not known, except where an extension of time is granted in writing by the General Manager.
57. The number of replacement trees required under Section 50 shall be two (2) replacement trees for each one (1) protected tree that is cut, removed or damaged, except that where the protected tree is an alder or cottonwood tree then one (1) replacement tree shall be required for each alder or cottonwood tree that is cut, removed or damaged. If, in the assessment of the General Manager or landscape architect, the lot cannot accommodate two (2) replacement trees for each protected tree that is cut, removed or damaged without compromising sound arboricultural practices, due to the size or other characteristics of the lot, the owner shall be required to pay cash-in-lieu to the City in the amount of THREE HUNDRED (\$300.00) DOLLARS for each replacement tree that cannot be accommodated.
58. The General Manager may reduce the number of replacement trees required in Section 57 and increase the size of the required replacement trees and increase the amount of securities from THREE HUNDRED (\$300.00) DOLLARS per tree to SIX HUNDRED (\$600.00) DOLLARS per tree where it is required by the General Manager that upsizing is required.
59. The cash-in-lieu described in Section 57 shall not exceed FIFTEEN THOUSAND (\$15,000.00) DOLLARS per acre of land from which trees are removed.
60. The number of replacement trees to be planted on each lot in single-family subdivisions, based on the zoning designation of the lot being created, may not exceed the number as specified below, provided that the requirements of Sections 57, 58 and 59 are met:

<b>Size of Lot Being Created</b>	<b>No. of Replacement Trees Required Per New Lot</b>
RF-12 and RF-G (those RF-G Lots smaller than 340 m <sup>2</sup> )	2
RF, RF-G Lots greater than or equal to 340 m <sup>2</sup> , RF-SS, R-F(R), R-F(F), R-F(C)	3
RH, RH-G, R-1, R-H(G)	5
Larger than RH	To be determined by the General Manager

61. Where the total number of replacement trees required for the subdivision is less than one-half of the total number of protected trees to be removed from the parent lots that are being subdivided, the General Manager may require that the size of the replacement trees be increased and the amount of securities be increased to reflect the larger size of the replacement trees.
62. Where a tree that is not a protected tree, but meets the latest edition of the BCSLA/BCLNA "B.C. Landscape Standard" for condition and structure is proposed to be retained within a proposed subdivision, and where the tree is the same size or larger than the size of the required replacement tree, the retained tree may be considered as one (1) of the replacement trees required for that lot. If the number of trees retained on one (1) lot exceeds the number of replacement trees required for that lot, the extra trees may be credited against other lots. However, this transfer of credits from one (1) lot to another will be limited to a maximum of two (2) credits per lot, provided that a minimum of one (1) tree is planted in the front yard of each new lot.

### **Part 10 Tree Protection**

63. Where the drip line of any protected tree, either on the lot or on an adjacent property is within four (4) metres of any excavation, demolition, construction or engineering works, the owner must install a tree protection barrier around the tree, in accordance with SCHEDULE "F".
64. No demolition permit, building permit or tree cutting permit shall be issued before the tree protection barrier has been installed and approved by either the Landscape Technician or the General Manager or his duly authorized representative, unless otherwise directed by the General Manager.
65. A tree protection barrier must remain in place and in accordance with SCHEDULE "F" until the removal of the tree protection barrier is approved by the General Manager.
66. Site disturbance within the tree protection zone is prohibited including, but not limited to, site grading, deposition or storage of soil or any other any material, disposal of any toxic material, access by any vehicular traffic or heavy equipment, or use of the area as an amenity space during construction.
67. Any work within a tree protection zone must be approved by the General Manager, prior to its commencement and the General Manager may refuse to allow the work or may specify conditions under which the work is to be undertaken.

### **Part 11 Inspection and Assessment**

68. The Landscape Technician, City Landscape Architect, Tree Protection Bylaw Administrator, an arborist or similarly qualified expert retained by the General Manager to provide technical advice to the General Manager, or any Bylaw Enforcement Officer of the City is authorized to enter at all reasonable times without the consent of the owner on any lot that is subject to the Bylaw to ascertain whether the regulations, prohibitions

and requirements of this Bylaw or any tree cutting permit are being met or to assess or inspect any tree or tree remains on the lot.

69. Where a protected tree has been cut or damaged on a lot in violation of this Bylaw, without a tree cutting permit, or in excess of any permission or in violation of any terms and conditions of a tree cutting permit, the trunks, limbs, roots, and remains of the cut or damaged tree shall not be removed from the lot until an investigation and assessment by the General Manager is completed and the removal is expressly authorized by the General Manager.
70. In accordance with Part 8, Section 47, once all replacement trees required under a tree cutting permit have been planted, or once the landscaping requirements of a development permit or building permit have been substantially completed, the owner may either:
  - (a) request that the Landscape Technician conduct a field review to confirm that the replacement trees or landscaping have been provided and installed in accordance with this Bylaw and any related permits, and if a reduction or release of securities is in order; or
  - (b) have a Landscape Architect submit to the City a sealed BCSLA Schedule L-3, provided that the same Landscape Architect has previously submitted to the City, a BCSLA Schedule L-1 and L-2 for the same project and work.
71. A SEVENTY-FIVE (\$75.00) DOLLAR re-inspection fee will be charged for every field review that has been requested and conducted after the first field review for any project where no reasonable attempt has been made by the owner to correct the deficiencies identified during the previous field review. No further field reviews will be conducted until the re-inspection fee has been paid in full.

## **Part 12 General Provisions**

72. Surrey Tree Preservation Bylaw, 1996, No. 12880 and all amendments thereto are hereby repealed, except in the case of applications for rezoning, subdivision, development permit or building permit, which have been submitted to the City and the applicable fees have been paid as of the date of adoption of this Bylaw, in which case Surrey Tree Preservation Bylaw, 1996, No. 12880, as amended, shall apply to such applications for a period of twelve (12) months after the date of adoption of this Bylaw. After the expiration of twelve (12) months, this Bylaw shall apply to all trees in the City of Surrey and Surrey Tree Preservation Bylaw, 1996, No. 12880 and all amendments thereto, shall be wholly repealed.
73. All Schedules referred to herein are attached to and form part of this Bylaw.
74. The provisions of this Bylaw are several and the invalidity of any part of this Bylaw shall not affect the validity of the remainder of this Bylaw.

75. This Bylaw shall come into force on the date of final adoption hereof.

PASSED THREE READINGS on the \_\_\_\_\_ day of \_\_\_\_\_, 2006.

RECONSIDERED AND FINALLY ADOPTED, signed by the Mayor and Clerk and sealed with the Corporate Seal on the \_\_\_\_\_ day of \_\_\_\_\_, 2006.

\_\_\_\_\_  
Mayor

\_\_\_\_\_  
Clerk

<http://surrey.ihostez.com/content/uploaded/57a3e1cd8aff4e8c8ce65b94d2095ad2-08301515-hyL.doc>  
C 7/16/10 3:15 PM

# SCHEDULE "A" Environmentally Sensitive Areas

**Note:** This version of the map is a general guide only. The official detailed version of this map shall be kept in the Building Division of the Planning and Development Department of the City and takes precedence over this general guide for all purposes. For a detailed plan of specific areas, please contact the Tree Protection Bylaw Administrator.

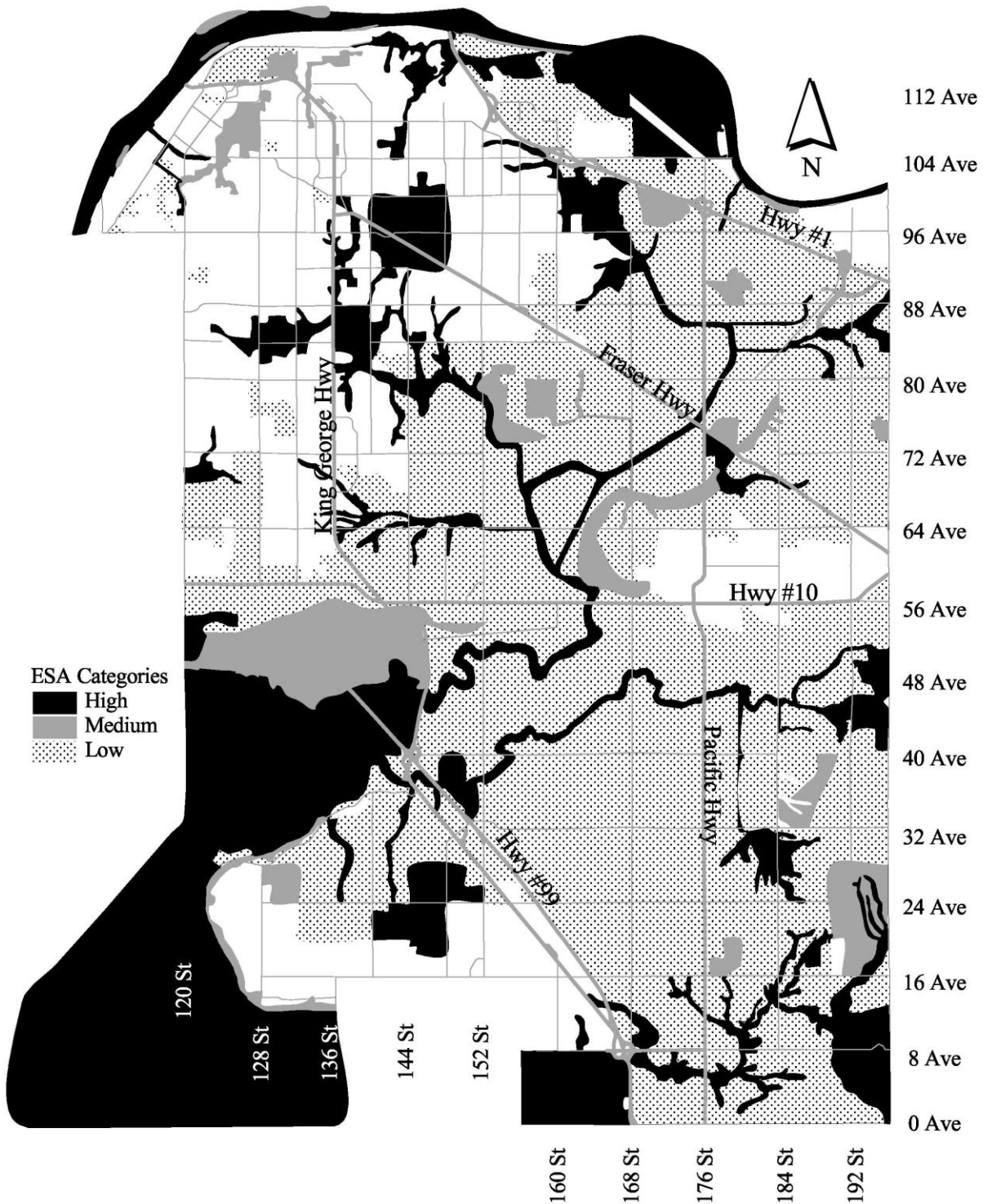

**SCHEDULE "B"**  
**Significant Trees**

<b>Tree No.</b>	<b>Tree Species</b>	<b>Location</b>	<b>Owner</b>	<b>Heritage Plaque Number (if applicable)</b>
1.	English Oak	Road right-of-way in front of 3439 King George Highway	City of Surrey	
2.	English Oak	3427 King George Highway	City of Surrey	
3.	English Oak	3427 King George Highway	City of Surrey	
4.	English Oak	3427 King George Highway	City of Surrey	
5.	English Oak	3427 King George Highway	City of Surrey	
6.	English Oak	3347 King George Highway	City of Surrey	
7.	English Oak	3333 King George Highway	City of Surrey	
8.	English Oak	3333 King George Highway	City of Surrey	
9.	English Oak	3247 King George Highway	City of Surrey	
10.	English Oak	3247/3237 King George Highway	City of Surrey	
11.	English Oak	3189 King George Highway	City of Surrey	
12.	English Oak	3050 King George Highway	City of Surrey	
13.	English Oak	2966 King George Highway	City of Surrey	
14.	English Oak	2901 King George Highway	City of Surrey	
15.	English Oak	15099 – 28 Avenue	City of Surrey	
16.	English Oak	15099 – 28 Avenue	City of Surrey	
17.	English Oak	15133 – 28 Avenue	City of Surrey	
18.	English Oak	15133 – 28 Avenue	City of Surrey	
19.	English Oak	2855 King George Highway	City of Surrey	
20.	English Oak	2845 King George Highway	City of Surrey	
21.	English Oak	2845 King George Highway	City of Surrey	
22.	English Oak	2812 King George Highway	City of Surrey	
23.	English Oak	2619 King George Highway	City of Surrey	
24.	English Oak	2622 King George Highway	City of Surrey	
25.	English Oak	2567 King George Highway	City of Surrey	
26.	English Oak	2205 King George Highway	City of Surrey	
27.	English Oak	2195 King George Highway	City of Surrey	
28.	English Oak	2155 King George Highway	City of Surrey	
29.	English Oak	2120 King George Highway	City of Surrey	
30.	English Oak	2120 King George Highway	City of Surrey	
31.	English Oak	2120 King George Highway	City of Surrey	
32.	English Oak	2120 King George Highway	City of Surrey	
33.	English Oak	2121 King George Highway	City of Surrey	
34.	English Oak	2078 King George Highway	City of Surrey	
35.	English Oak	2093 King George Highway	City of Surrey	
36.	English Oak	3061 King George Highway	City of Surrey	
37.	English Oak	2958 King George Highway	City of Surrey	



<b>Tree No.</b>	<b>Tree Species</b>	<b>Location</b>	<b>Owner</b>	<b>Heritage Plaque Number (if applicable)</b>
38.	English Oak	2515 King George Highway	City of Surrey	
39.	English Oak	2062 King George Highway	City of Surrey	
40.	English Oak	2062 King George Highway	City of Surrey	
41.	English Oak	King George Highway right-of-way behind 1986 Lilac Drive	City of Surrey	
42.	English Oak	King George Highway right-of-way behind 1987 - 158A Street	City of Surrey	
43.	Various	Cloverdale Library 17671 - 56 Avenue	City of Surrey	
44.	Various	St. Helen's Church 10787-128 Street	Synod of the Diocese of New Westminster	
45.	Various	Christ Church and Cemetery 16631 Old McLellan Road	Synod of the Diocese of New Westminster	
46.	Various	Elgin Hall 14250 Crescent Road	City of Surrey	
47.	Various	Elgin Centre 3530-144 Street	City of Surrey	
48.	Various	Pillath Hall/ House 11113-148 Street	City of Surrey	
49.	Various	Crescent Road, which land was designated as a heritage area and is more particularly described in Section 2 of "Surrey Municipal Heritage Site Designation Bylaw, 1983, No. 7716"	City of Surrey	
50.	Various	Steward House/Ward's Marina 13723 Crescent Road	City of Surrey	
51.	Red Cedar Stump	8920 Queen Mary Boulevard	City of Surrey	
52.	Various	Old Anniedale School 9744-176 Street	Surrey School District No. 36	
53.	Royal Oak Tree	16613 Old McLellan Road	City of Surrey	
54.	Douglas Fir	Avenue of Trees 16613 Old McLellan Road	City of Surrey	
55.	Various	5418-184 Street Robert Dougal MacKenzie House	Private	
56.	English Oak	1284 King George Highway	City of Surrey	
57.	English Oak	1278 King George Highway	City of Surrey	
58.	English Oak	1272 King George Highway	City of Surrey	
59.	English Oak	1266 King George Highway	City of Surrey	
60.	English Oak	1260 King George Highway	City of Surrey	
61.	English Oak	1254 King George Highway	City of Surrey	

<b>Tree No.</b>	<b>Tree Species</b>	<b>Location</b>	<b>Owner</b>	<b>Heritage Plaque Number (if applicable)</b>
62.	English Oak	1246 King George Highway	City of Surrey	
63.	English Oak	1242 King George Highway	City of Surrey	
64.	English Oak	1236 King George Highway	City of Surrey	
65.	English Oak	1251 King George Highway	City of Surrey	
66.	English Oak	1232 King George Highway	City of Surrey	
67.	English Oak	1232 King George Highway	City of Surrey	
68.	English Oak	16433-12 Avenue	City of Surrey	
69.	English Oak	16433-12 Avenue	City of Surrey	
70.	English Oak	1199 King George Highway	City of Surrey	
71.	English Oak	1187 King George Highway	City of Surrey	
72.	English Oak	1175 King George Highway	City of Surrey	
73.	English Oak	1163 King George Highway	City of Surrey	
74.	English Oak	16350-14 Avenue	City of Surrey	
75.	English Oak	16350-14 Avenue	City of Surrey	
76.	English Oak	16350-14 Avenue	City of Surrey	
77.	English Oak	16350-14 Avenue	City of Surrey	
78.	English Oak	16350-14 Avenue	City of Surrey	
79.	English Oak	16350-14 Avenue	City of Surrey	
80.	English Oak	16350-14 Avenue	City of Surrey	
81.	English Oak	16350-14 Avenue	City of Surrey	
82.	English Oak	16350-14 Avenue	City of Surrey	
83.	English Oak	1250 King George Highway	City of Surrey	
84.	English Oak	1250 King George Highway	City of Surrey	
85.	English Oak	1250 King George Highway	City of Surrey	
86.	English Oak (2 Trees)	1222 King George Highway	City of Surrey	
87.	English Oak	1210 King George Highway	City of Surrey	
88.	English Oak	1210 King George Highway	City of Surrey	
89.	English Oak	1210 King George Highway	City of Surrey	
90.	English Oak	1210 King George Highway	City of Surrey	
91.	English Oak	1210 King George Highway	City of Surrey	
92.	English Oak	1160 King George Highway	City of Surrey	
93.	English Oak	1160 King George Highway	City of Surrey	
94.	Douglas Fir	5804 Kilkee Drive (Kilkee Park)	City of Surrey	2
95.	Butternut/White Walnut	6272-152 Street (Sullivan Park)	City of Surrey	1
96.	Douglas Fir	15100-22 Avenue	City of Surrey	3
97.	Canadian/Japanese Walnut Cross	1660-168 Street (Darts Hill)	City of Surrey	4
98.	Madrona	12101 Sullivan Street	Private	17
99.	Douglas Fir	1990-134 Street	Private	16

<b>Tree No.</b>	<b>Tree Species</b>	<b>Location</b>	<b>Owner</b>	<b>Heritage Plaque Number (if applicable)</b>
100.	Douglas Fir	9016-164 Street	Private	5
101.	Douglas Fir	19587-0 Avenue	Private	6
102.	Weeping Willow	2865 - 164 Street	Private	15
103.	Sitka Spruce	13398-Vine Maple Drive	Private	7
104.	English Oak	9353-160 Street	City of Surrey	8
105.	Scotch Elm	5418-184 Street	Private	Group 10
106.	Nordmann Fir	1660-168 Street (Darts Hill)	City of Surrey	Group 1
107.	Spanish Fir	1660-168 Street (Darts Hill)	City of Surrey	Group 1
108.	Incense Cedar (3 Trees)	1660-168 Street (Darts Hill)	City of Surrey	Group 1
109.	Corkscrew Hazel	1660-168 Street (Darts Hill)	City of Surrey	Group 1
110.	Sekkan Sugi Japanese Cedar	1660-168 Street (Darts Hill)	City of Surrey	Group 1
111.	Sweet Chestnut	1660-168 Street (Darts Hill)	City of Surrey	Group 1
112.	White Mulberry	1660-168 Street (Darts Hill)	City of Surrey	Group 1
113.	Bigleaf Magnolia	1660-168 Street (Darts Hill)	City of Surrey	Group 1
114.	Medlar	1660-168 Street (Darts Hill)	City of Surrey	Group 1
115.	Antarctic Beech	1660-168 Street (Darts Hill)	City of Surrey	Group 1
116.	Ironwood	1660-168 Street (Darts Hill)	City of Surrey	Group 1
117.	Empress Tree	1660-168 Street (Darts Hill)	City of Surrey	Group 1
118.	Oriental Spruce	1660-168 Street (Darts Hill)	City of Surrey	Group 1
119.	Chinese Elm	1660-168 Street (Darts Hill)	City of Surrey	Group 1
120.	Variegated Hiba Arborv.	1660-168 Street (Darts Hill)	City of Surrey	Group 1
121.	California Bay Tree	1660-168 Street (Darts Hill)	City of Surrey	Group 1
122.	China Fir	1660-168 Street (Darts Hill)	City of Surrey	Group 1
123.	Weep. Giant Sequoia	1660-168 Street (Darts Hill)	City of Surrey	Group 1
124.	Western Red Cedar	10648-127 Street	City of Surrey	
125.	Douglas Fir	19016- 96 Avenue (St. Oswalds)	City of Surrey	Group 2
126.	Douglas Fir	19016-96 Avenue (St. Oswalds)	City of Surrey	Group 2
127.	Douglas Fir	19016-96 Avenue (St. Oswalds)	City of Surrey	Group 2
128.	Douglas Fir	19016-96 Avenue (St. Oswalds)	City of Surrey	Group 2
129.	English Oak	19016-96 Avenue (St. Oswalds Church)	City of Surrey	31
130.	Western Red Cedar	19587-0 Avenue	Private	9

<b>Tree No.</b>	<b>Tree Species</b>	<b>Location</b>	<b>Owner</b>	<b>Heritage Plaque Number (if applicable)</b>
131.	European Beech	Peace Arch Park	Province of BC	Group 3
132.	Western White Pine	Peace Arch Park	Province of BC	Group 3
133.	European Larch	Peace Arch Park	Province of BC	Group 3
134.	Red Japanese Maple	Peace Arch Park	Province of BC	Group 3
135.	Atlas Cedar	Peace Arch Park	Province of BC	Group 3
136.	Crimson King Maple	Peace Arch Park	Province of BC	Group 3
137.	Maidenhair Tree	Peace Arch Park	Province of BC	Group 3
138.	Lawson's Cypress	Peace Arch Park	Province of BC	Group 3
139.	Horse Chestnut (15 Trees)	17857-56 Avenue (Cloverdale Elementary)	Surrey School District No. 36	Group 4
140.	Incense Cedar	17900-20 Avenue (Redwood Park)	City of Surrey	Group 5
141.	Sweet Chestnut	17900-20 Avenue (Redwood Park)	City of Surrey	Group 5
142.	Golden Lawson's Cypress	17900-20 Avenue (Redwood Park)	City of Surrey	Group 5
143.	English Walnut	17900-20 Avenue (Redwood Park)	City of Surrey	Group 5
144.	Dawn Redwood	17900-20 Avenue (Redwood Park)	City of Surrey	Group 5
145.	Red Oak	17900-20 Avenue (Redwood Park)	City of Surrey	Group 5
146.	Giant Sequoia	17900-20 Avenue (Redwood Park)	City of Surrey	Group 5
147.	Hiba Arborvitae (2 trees)	17900-20 Avenue (Redwood Park)	City of Surrey	Group 5
148.	Siberian Elm	17900-20 Avenue (Redwood Park)	City of Surrey	Group 5
149.	Golden Locust	14239 Melrose	Private	
150.	English Oak Grove	140 Street and 96 Avenue (Green Timbers)	City of Surrey	Group 6
151.	Douglas Fir	5480-184A Street	City of Surrey	21
152.	Oriental Plane	4117-152 Street	Private	10
153.	Western Red Cedar	NE Corner of 184 Street and 16 Avenue	Private	13
154.	Sycamore Maple	18537-54 Avenue	Private	14
155.	English Oak	16671 Old McLellan Road	City of Surrey	19
156.	Western Red Cedar	168 Street and 50 Avenue (Mound Farm)	City of Surrey	Group 7

<b>Tree No.</b>	<b>Tree Species</b>	<b>Location</b>	<b>Owner</b>	<b>Heritage Plaque Number (if applicable)</b>
157.	Western Red Cedar	168 Street and 50 Avenue (Mound Farm)	City of Surrey	Group 7
158.	Douglas Fir	168 Street and 50 Avenue (Mound Farm)	City of Surrey	Group 7
159.	Douglas Fir	168 Street and 50 Avenue (Mound Farm)	City of Surrey	Group 7
160.	Douglas Fir	168 Street and 50 Avenue (Mound Farm)	City of Surrey	Group 7
161.	Weep. Norway Spruce	561-172 Street (The Glades)	City of Surrey	Group 8
162.	Kobus Magnolia	561-172 Street (The Glades)	City of Surrey	Group 8
163.	Dove Tree	561-172 Street (The Glades)	City of Surrey	Group 8
164.	Dawn Redwood	561-172 Street (The Glades)	City of Surrey	Group 8
165.	Eastern White Pine	561-172 Street (The Glades)	City of Surrey	Group 8
166.	California Bay St	561-172 Street (The Glades)	City of Surrey	Group 8
167.	Mirbeck's Oak	561-172 Street (The Glades)	City of Surrey	Group 8
168.	Wilson's Magnolia	561-172 Street (The Glades)	City of Surrey	Group 8
169.	Western Red Cedar	561-172 Street (The Glades)	City of Surrey	Group 8
170.	Various - Arboretum	9800-140 Street (Green Timbers)	Province of BC	Group 9
171.	English Oak	13997-90 Avenue (on 140 Street)	Private	11
172.	Butternut	6091-181A Street	City of Surrey	28
173.	Monkey Puzzle	100 metres south of 152 Street and King George Highway	Private	27
174.	Sitka Spruce	Tynehead Regional Park	GVRD	
175.	Sitka Spruce	Tynehead Regional Park	GVRD	
176.	Common Apple	18029 Highway 10	Private	
177.	Horse Chestnut	18029 Highway 10	Private	
178.	English Walnut	18029 Highway 10	Private	
179.	English Walnut	18029 Highway 10	Private	
180.	Black Walnut	18029 Highway 10	Private	
181.	Black Walnut	18029 Highway 10	Private	
182.	Walnut	7572 – 146 Street	Private	18

<b>Tree No.</b>	<b>Tree Species</b>	<b>Location</b>	<b>Owner</b>	<b>Heritage Plaque Number (if applicable)</b>
183.	Douglas Fir	18 Avenue and 136 Street (Bell Park)	City of Surrey	Group 11
184.	Douglas Fir	18 Avenue and 136 Street (Bell Park)	City of Surrey	Group 11
185.	Coulter Pine	12649-25 Avenue	Private	
186.	English Oak	13722-56 Avenue	Private	
187.	Douglas Fir	13600-55A Avenue	City of Surrey	29
188.	Tulip Tree	12976-Old Yale Road	City of Surrey	20
189.	English Walnut	19251-76 Avenue	Private	23
190.	Beech	12691-14 Avenue	Private	
191.	Dead Douglas Fir	South Side of Highway #1 East of 176 Street	Province of B.C.	
192.	English Walnut	7572-146 Street	City of Surrey	
193.	Douglas Fir	14158 Hyland Road	City of Surrey	24
194.	Bigleaf Maple	19184-16 Avenue	City of Surrey	25
195.	Brewer's Weeping Spruce	12731 Becket Road	Private	26
196.	Purple Beech	13275 Colebrook Road	City of Surrey	Group 12
197.	Purple Beech	13275 Colebrook Road	City of Surrey	Group 12
198.	Purple Beech	13275 Colebrook Road	City of Surrey	Group 12
199.	Weeping Linden	13275 Colebrook Road	City of Surrey	Group 12
200.	English Oak	13275 Colebrook Road	City of Surrey	Group 12
201.	Rock Tree	12237 – 91A Avenue	Private	
202.	All trees on Semiahmoo Trail	Various lots (see Schedule B1 for details)	City of Surrey	
203.	Common Beech	19340–88 Avenue (Port Kells Park)	City of Surrey	Group 14
204.	Common Beech	19340–88 Avenue (Port Kells Park)	City of Surrey	Group 14
205.	English Oak	19340–88 Avenue (Port Kells Park)	City of Surrey	Group 14
206.	English Oak	19340–88 Avenue (Port Kells Park)	City of Surrey	Group 14
207.	English Oak	19340–88 Avenue (Port Kells Park)	City of Surrey	Group 14
208.	English Oak	19340–88 Avenue (Port Kells Park)	City of Surrey	Group 14
209.	English Oak	19340–88 Avenue (Port Kells Park)	City of Surrey	Group 14
210.	Hedge Maple	19340–88 Avenue (Port Kells Park)	City of Surrey	Group 14
211.	English Oak	19340–88 Avenue (Port Kells Park)	City of Surrey	Group 14

<b>Tree No.</b>	<b>Tree Species</b>	<b>Location</b>	<b>Owner</b>	<b>Heritage Plaque Number (if applicable)</b>
212.	English Oak	19340-88 Avenue (Port Kells Park)	City of Surrey	Group 14
213.	Hedge Maple	19340-88 Avenue (Port Kells Park)	City of Surrey	Group 14
214.	English Oak	19340-88 Avenue (Port Kells Park)	City of Surrey	Group 14
215.	Hedge Maple	19340-88 Avenue (Port Kells Park)	City of Surrey	Group 14
216.	English Oak	19340-88 Avenue (Port Kells Park)	City of Surrey	Group 14
217.	Hedge Maple	19340-88 Avenue (Port Kells Park)	City of Surrey	Group 14
218.	English Oak	19340-88 Avenue (Port Kells Park)	City of Surrey	Group 14
219.	English Oak	19340-88 Avenue (Port Kells Park)	City of Surrey	Group 14
220.	Hedge Maple	19340-88 Avenue (Port Kells Park)	City of Surrey	Group 14
221.	Common Beech	19340-88 Avenue (Port Kells Park)	City of Surrey	Group 14
222.	English Oak	19340-88 Avenue (Port Kells Park)	City of Surrey	Group 14
223.	English Oak	19340-88 Avenue (Port Kells Park)	City of Surrey	Group 14
224.	English Oak	19340-88 Avenue (Port Kells Park)	City of Surrey	Group 14
225.	English Oak	19340-88 Avenue (Port Kells Park)	City of Surrey	Group 14
226.	Common Beech	19340-88 Avenue (Port Kells Park)	City of Surrey	Group 14
227.	English Oak	19340-88 Avenue (Port Kells Park)	City of Surrey	Group 14
228.	Common Beech	19340-88 Avenue (Port Kells Park)	City of Surrey	Group 14
229.	English Oak	19340-88 Avenue (Port Kells Park)	City of Surrey	Group 14
230.	English Oak	19340-88 Avenue (Port Kells Park)	City of Surrey	Group 14
231.	Common Beech	19340-88 Avenue (Port Kells Park)	City of Surrey	Group 14
232.	English Oak	19340-88 Avenue (Port Kells Park)	City of Surrey	Group 14

<b>Tree No.</b>	<b>Tree Species</b>	<b>Location</b>	<b>Owner</b>	<b>Heritage Plaque Number (if applicable)</b>
233.	Sitka Spruce	19340-88 Avenue (Port Kells Park)	City of Surrey	Group 14
234.	Sitka Spruce	19340-88 Avenue (Port Kells Park)	City of Surrey	Group 14
235.	Douglas Fir	19340-88 Avenue (Port Kells Park)	City of Surrey	Group 14
236.	Douglas Fir	19340-88 Avenue (Port Kells Park)	City of Surrey	Group 14
237.	Douglas Fir	19340-88 Avenue (Port Kells Park)	City of Surrey	Group 14
238.	Douglas Fir	18918-88 Avenue (Port Kells Community Hall)	City of Surrey	Group 15
239.	Douglas Fir	18918-88 Avenue (Port Kells Community Hall)	City of Surrey	Group 15
240.	Douglas Fir	18918-88 Avenue (Port Kells Community Hall)	City of Surrey	Group 15
241.	Douglas Fir	18918-88 Avenue (Port Kells Community Hall)	City of Surrey	Group 15
242.	Douglas Fir	18918-88 Avenue (Port Kells Community Hall)	City of Surrey	Group 15
243.	Douglas Fir	18809-88 Avenue (Port Kells Library)	City of Surrey	30
244.	Douglas Fir	19076-88 Avenue (Port Kells Elementary School)	Surrey School District No. 36	Group 16
245.	Douglas Fir	19076-88 Avenue (Port Kells Elementary School)	Surrey School District No. 36	Group 16
246.	Douglas Fir	19076-88 Avenue (Port Kells Elementary School)	Surrey School District No. 36	Group 16
247.	Sugar Maple (12 trees)	8261-188 Street	City of Surrey	Group 17
248.	Copperleaf European Beech	12978 – 56 Avenue	Private	33
249.	Douglas Fir	8850 Harvie Road	Private	Group 18
250.	Douglas Fir	8850 Harvie Road	Private	Group 18
251.	White Ash	18385 – 80 Avenue	Private	34
252.	English Oak	9012 – 160 Street	City of Surrey	32
253.	Sugar Maples (2 Trees)	8495 – 144 Street	City of Surrey	Group 13



**SCHEDULE "B1"**  
**Semiahmo Trail**



**SCHEDULE "B1"**  
**Semiahmo Trail**

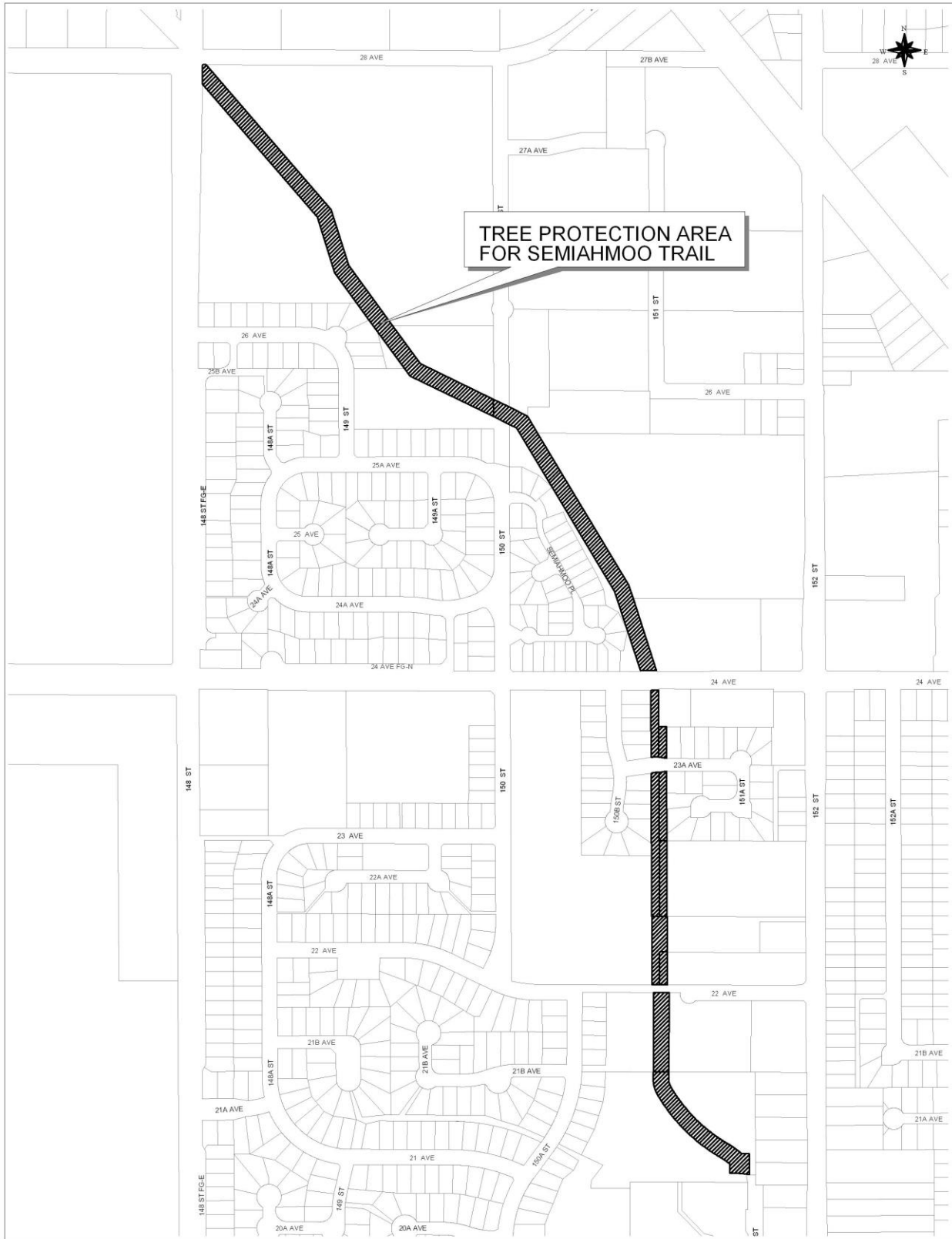



TC Permit #: T \_\_\_\_\_

**SCHEDULE "C"**  
**City Of Surrey - Planning and Development**  
**Application For Tree Cutting Permit**  
**(Surrey Tree Protection Bylaw, 2006, No. 16100)**

**Site Address:** \_\_\_\_\_

**Applicant:**

Name (*please print*): \_\_\_\_\_

Address (*if other than site address*): \_\_\_\_\_

Phone number(s): \_\_\_\_\_

**Owner** (*to be filled out only when the applicant is not the registered owner of the lot*):

Name (*please print*): \_\_\_\_\_

Address: \_\_\_\_\_

Phone number(s): \_\_\_\_\_

Number of trees proposed to be cut: \_\_\_\_\_

Reason for wanting to remove tree(s): \_\_\_\_\_

*(use additional paper if required)*

In consideration of the issuance of a tree cutting permit as a result of this application (the "Permit"), the applicant agrees to indemnify and save harmless the City, its elected and appointed officials, officers, employees, servants and agents from and against all claims, losses, damages, costs, expenses, including investigatory and legal expenses and other actions caused by or attributable to any wilful or negligent act, omission, delay, or allegations thereof on the part of the applicant or owner and their employees, subcontractors or agents, related in any way to the permit. The applicant also agrees that this provision shall survive the termination of the Permit.

I am aware of, understand and intend to comply with all regulations and requirements of "Surrey Tree Protection Bylaw, 2006, No. 16100" and certify that all information provided with this application is correct and true.

\_\_\_\_\_  
Date

\_\_\_\_\_  
Signature of Applicant

*(To be filled out only when the applicant is not the registered owner)*

I, \_\_\_\_\_ am the registered owner of the lot described in this application and hereby consent to this application being made and to the issuance of a tree cutting permit to the applicant as documented above. I certify that the information in this application is correct and true and I acknowledge that although I am not the applicant, I am also responsible for compliance with all provisions of "Surrey Tree Protection Bylaw, 2006, No. 16100".

\_\_\_\_\_  
Date

\_\_\_\_\_  
Signature of Owner

**Unless exempted by the General Manager, the applicant must supply the following:**

**For Hazardous Tree Cutting Permits:**

The following information is attached to this permit as proof that the tree(s) in question are hazardous to persons or property due to natural causes (where trees are hazardous due to causes other than natural causes please go to next section):



- A report prepared by an International Society of Arborists (I.S.A.) accredited arborist that declares the tree(s) to be hazardous documents the assessment and reason for such declaration and recommends removal as the only practical means of removing or abating the hazardous condition.

**OR**

- A current photograph or photographs of the tree(s) that clearly show the tree(s) is/are hazardous and that the only practical means of removing or abating the hazard is to remove the tree(s). The photograph(s) must also show the location of the tree(s) in relation to buildings or some other permanent, identifiable feature on the lot on which the subject tree(s) is/are located.

**For All Other Tree Cutting Permits Except Hazardous Tree Cutting Permits:**

The following information is attached to demonstrate the need to cut and remove any protected tree(s) from the lot:

- A legal survey which illustrates the location of:
  - All protected trees to be retained using the symbol 
  - All protected trees to be removed using the symbol 
  - All replacement trees using the symbol 
  - The location of all tree protection barriers with the symbol -----
  - Any trees of any size on any immediately adjacent lot that have root systems or canopies that extend onto the Applicant's lot.
  - Any existing or proposed buildings, driveways, overhead or underground utility lines, septic fields, easements, restrictive covenant areas and any other features which would impact tree removal or the planting and maintenance of replacement trees or the viability of retained trees.

Note: For wooded areas of closed stand alder and cottonwood forests, each tree need not be surveyed, only those with the potential for preservation. An estimate of how many protected trees there are within the wooded area must be provided, as well, as the outline of the wooded area on the plan.

Note: For existing single family lots where no demolition permit, building permit, subdivision application, development permit or development variance permit is required, the plan may be a hand drawn plan rather than a legal survey, but the plan must show the location and size of each tree on the lot, including dimensions between each tree and any building or structure on the lot and to property lines and be signed by the applicant.

- A report prepared by an I.S.A. accredited arborist that includes the following:
- An environmental description of the lot, including topography, soil conditions and whether it has a High Environmental Sensitivity Rate in the map attached as Schedule "A" to the "Surrey Tree Protection Bylaw, 2006, No. 16100", whether there are any water courses registered with the Ministry of Water, Land and Air Protection and whether there is any evidence of raptors' nests, osprey nests or heron colonies.
  - A description of any large, rare or potential specimen quality trees anywhere on the lot.
  - An assessment of all trees located within areas of the lot that could potentially accommodate the trees if retained and a recommendation as to whether these trees warrant retention or not.
  - A description of the impact the removal of these trees will have on adjacent lots and the trees growing on them.

Note: For wooded areas of closed stand alder and cottonwood forests, each tree need not be assessed, only those trees which have the potential for preservation.

**Please note: The arborist or arboricultural firm that assesses the trees can not also remove the trees.**

**FOR OFFICE USE ONLY**

- Issue Tree Cutting Permit                       Issue Hazardous Tree Cutting Permit
- Permit Denied
- Additional information required from the Applicant: \_\_\_\_\_

Building Permit No. \_\_\_\_\_ Planning File No. \_\_\_\_\_

No. of trees being removed \_\_\_\_\_ No. of Replacement Trees Required \_\_\_\_\_

Permit Fee = \$\_\_\_\_\_ paid on \_\_\_\_\_

Securities = \$\_\_\_\_\_ paid on \_\_\_\_\_ by  cash/cheque  letter of credit

Conditions of this permit: \_\_\_\_\_



**SCHEDULE "D"**  
**Tree Cutting Permit**

**T-06-**

---

---

**CITY OF SURREY**

---

---

**TREE CUTTING PERMIT**

(Schedule "D" Surrey Tree Protection Bylaw, 2006, No. 16100)

---

---

**PROJECT ADDRESS:**

**LEGAL DESCRIPTION:**

**ZONE:**

**EXPIRY DATE:**

**PERMIT TYPE:**

**SECURITY AMOUNT:**

**WORK DESCRIPTION:**

---

---

**APPLICANT:**

---

---

**OWNER:**

---

---

**ARBORIST:**

---

---

**# OF TREES TO BE REMOVED:**

**# OF REPLACEMENT TREES:**

**# OF HAZARDOUS TREES TO BE REMOVED:**

---

---

**TERMS AND CONDITIONS:**

---

---

**ISSUED BY:**

**DATE OF ISSUANCE:**

\_\_\_\_\_  
FOR GENERAL MANAGER

**PLEASE READ THE FOLLOWING CAREFULLY**

**ONE COPY OF THIS PERMIT MUST BE POSTED ON SITE, IN A PLACE VISIBLE TO THE PUBLIC, DURING TREE REMOVAL**

**TREE CUTTING PERMITS**

1. This Permit authorizes the Permittee to cut and remove only the trees listed and described on Appendix "A" of this Permit subject to the terms and conditions hereinafter set out.
2. This Permit is issued subject to the following terms and conditions:
  - (a) any tree authorized to be cut or removed by this Permit shall only be cut or removed in strict compliance with the provisions of Surrey Tree Protection Bylaw, 2006, No. 16100;
  - (b) all trees cut or removed pursuant to this Permit shall be replaced in accordance with the tree replacement plan attached hereto as:
    - Appendix "A" of this Permit; **OR**
    - Appendix "B" of this Permit;
  - (c) tree protection barriers shall be constructed and maintained, around all trees to be preserved which will be impacted in any way by any site disturbance, in accordance with Surrey Tree Protection Bylaw, 2006, No. 16100;
  - (d) all replacement trees shall be planted and maintained in accordance with the provisions of Surrey Tree Protection Bylaw, 2006, No. 16100;
  - (e) The arborist or arboricultural firm that assesses the trees can not also remove the trees.
3. The securities which have been provided by the Permittee are held by the City of Surrey pursuant to the terms and conditions of Part 8 of Surrey Tree Protection Bylaw, 2006, No. 16100.
4. If this Permit authorizes the pruning of a significant tree, it is a term and condition of the issuance of this Permit that such pruning be carried out for and in accordance with good, sound arboricultural practice and not for any other purpose or in any other manner and shall be carried out under the on-site supervision of a qualified arborist.

**HAZARDOUS TREE CUTTING PERMIT**

1. This Permit authorizes the Permittee to cut and remove only the trees:
  - listed and described in the arborist's report which is attached to this permit; **OR**
  - the tree(s) shown in the photographs, copies of which are attached to this Permit;

**AND**

subject to the terms and conditions hereinafter set out.
2. Any tree authorized to be cut or removed by this Permit shall only be cut or removed in strict compliance with provisions of Surrey Tree Protection Bylaw, 2006, No. 16100.
3. No charge shall be required for the issuance of a Hazardous Tree Cutting Permit.

**SCHEDULE "E"**  
**Acceptable Replacement Trees**

# Acceptable Replacement Trees

**The following table lists acceptable  
Replacement Tree species and sizes**

**All plant material and planting techniques  
must comply with the latest edition of the  
"BCSLA/BCLNA B.C. Landscape Standard"**

**Please note: The General Manager reserves the right to specify the species and size of any  
replacement trees required where trees have been cut, removed or damaged in  
contravention of this Bylaw.**

*City of Surrey Planning & Development Department, 14245 - 56 Avenue, Surrey, B.C. V3X 3A2  
Telephone: 591-4441*



## REPLACEMENT TREES

### NOTES TO THE TABLE:

(1) IN THE MINIMUM SIZE COLUMN, REFERENCE TO A FIGURE IN CENTIMETRES (cm) IS A MEASUREMENT OF TRUNK DIAMETER 15 cm ABOVE THE GROUND. REFERENCE TO A FIGURE IN METRES (m) IS A MEASUREMENT OF HEIGHT ABOVE THE GROUND.

(2) THE COLUMN HEADING "TYPE", L = LARGE, M = MEDIUM, S = SMALL AND F = FASTIGIATE (OR COLUMNAR) AND REFERS TO THE SIZE OF TREE AT MATURITY, NOT THE SIZE WHEN PLANTED.

COMMON NAME	BOTANICAL NAME	PLANTING SIZE	TYPE
Hedge Maple	<i>Acer campestre</i> 'Queen Elizabeth'	5 cm caliper	S
Vine Maple	<i>Acer circinatum</i>	5 cm caliper	S
Amur Maple	<i>Acer ginnala</i>	5 cm caliper	S
Bloodgood Japanese Maple	<i>Acer palmatum</i> 'Bloodgood'	5 cm caliper	S
Globe Maple	<i>Acer platanoides</i> 'Globosum'	5 cm caliper	S
Young's Weeping Birch	<i>Betula pendula</i> 'Youngii'	5 cm caliper	S
Eastern Redbud	<i>Cercis canadensis</i>	5 cm caliper	S
Eddie's White Wonder Dogwood	<i>Cornus</i> 'Eddie's White Wonder'	5 cm caliper	S
Chinese Dogwood	<i>Cornus chinensis</i>	5 cm caliper	S
Kousa Dogwood	<i>Cornus kousa</i>	3 m height	S
Cornelian Cherry	<i>Cornus mas</i>	3 m height	S
Cockspur Hawthorn	<i>Crataegus crus-galli inermis</i>	5 cm caliper	S
Washington Hawthorn	<i>Crataegus phaenopyrum</i> 'Treeform'	5 cm caliper	S
Lavalle Hawthorn	<i>Crataegus x lavallei</i>	5 cm caliper	S
English Holly	<i>Ilex aquifolium</i>	5 cm caliper	S
Amur Maackia	<i>Maackia amurensis</i>	5 cm caliper	S
Caerhays Bell Magnolia	<i>Magnolia</i> 'Caerhays Bell'	5 cm caliper	S
Elizabeth Magnolia	<i>Magnolia</i> 'Elizabeth'	5 cm caliper	S
Galaxy Magnolia	<i>Magnolia</i> 'Galaxy'	5 cm caliper	S
Vulcan Magnolia	<i>Magnolia</i> 'Vulcan'	5 cm caliper	S
Waddas Memory	<i>Magnolia Magnolia</i> 'Waddas Memory'	5 cm caliper	S
Yellow Cucumber Tree	<i>Magnolia cordata</i>	3 m height	S
Oyama Magnolia	<i>Magnolia sieboldii</i>	3 m height	S
Saucer Magnolia	<i>Magnolia soulangiana</i>	3 m height	S
Japanese Crabapple	<i>Malus florabunda</i>	5 cm caliper	S
Prairiefire Crabapple	<i>Malus x</i> 'Prairiefire'	5 cm caliper	S
Calocarpa Ornamental Crabapple	<i>Malus x zumi</i> 'Calocarpa'	5 cm caliper	S
White Mulberry	<i>Morus alba</i>	5 cm caliper	S
Sourwood	<i>Oxydendrum arboreum</i>	5 cm caliper	S
Persian Ironwood	<i>Parrotia persica</i>	5 cm caliper	S

City of Surrey Planning & Development Department

## REPLACEMENT TREES

### NOTES TO THE TABLE:

(1) IN THE MINIMUM SIZE COLUMN, REFERENCE TO A FIGURE IN CENTIMETRES (cm) IS A MEASUREMENT OF TRUNK DIAMETER 15 cm ABOVE THE GROUND. REFERENCE TO A FIGURE IN METRES (m) IS A MEASUREMENT OF HEIGHT ABOVE THE GROUND.

(2) THE COLUMN HEADING "TYPE", L = LARGE, M = MEDIUM, S = SMALL AND F = FASTIGIATE (OR COLUMNAR) AND REFERS TO THE SIZE OF TREE AT MATURITY, NOT THE SIZE WHEN PLANTED.

COMMON NAME	BOTANICAL NAME	PLANTING SIZE	TYPE
Japanese Flowering Plum	<i>Prunus blireana</i>	5 cm caliper	S
Portugal Laurel	<i>Prunus lusitanica</i>	3 m height	S
Japanese Flowering Cherry	<i>Prunus serrulat</i>	5 cm caliper	S
Higan Cherry	<i>Prunus subhirtella</i>	5 cm caliper	S
Chokecherry	<i>Prunus virginiana</i>	5 cm caliper	S
Staghorn Sumac	<i>Rhus typhina</i>	3 m height	S
Japanese Stewartia	<i>Stewartia pseudocamellia</i>	5 cm caliper	S
Japanese Snowbell	<i>Styrax japonica</i>	5 cm caliper	S
Fragrant Snowbell	<i>Styrax obassia</i>	5 cm caliper	S
Ivory Silk Tree Lilac	<i>Syringa reticulata</i> 'Ivory Silk'	5 cm caliper	S
Hatfield Yew	<i>Taxus hatfieldii</i>	3 m height	S
Hick's Yew	<i>Taxus media</i> 'Hicksii'	3 m height	S
Windmill Palm	<i>Trachycarpus fortunei</i>	3 m height	S
Certain fruit trees and dwarf fruit trees may be acceptable depending upon location and available sizes. Confirm acceptability with the City before purchase or installation.			S
Cappadocian Maple	<i>Acer cappadocicum</i>	5 cm caliper	M
David's Maple	<i>Acer davidii</i>	5 cm caliper	M
Rocky Mountain Maple	<i>Acer glabrum</i>	5 cm caliper	M
Paperbark Maple	<i>Acer griseum</i>	5 cm caliper	M
Manitoba Maple	<i>Acer negundo</i>	5 cm caliper	M
Striped Maple	<i>Acer pensylvanicum</i>	5 cm caliper	M
Norway Maple	<i>Acer platanoides</i>	5 cm caliper	M
Crimson King Maple	<i>Acer platanoides</i> 'Crimson King'	5 cm caliper	M
Crimson Sentry Maple	<i>Acer platanoides</i> 'Crimson Sentry'	5 cm caliper	M
Drummond Maple	<i>Acer platanoides</i> 'Drummondii'	5 cm caliper	M
Royal Red Maple	<i>Acer platanoides</i> 'Royal Red'	5 cm caliper	M
Schedler's Maple	<i>Acer platanoides</i> 'Schwedleri'	5 cm caliper	M
Pacific Sunset Maple	<i>Acer truncatum</i> x <i>A. platanoides</i> 'Warren Red'	5 cm caliper	M
Red Horsechestnut	<i>Aesculus x carnea</i>	5 cm caliper	M
Ruby Red Horsechestnut	<i>Aesculus x carnea</i> 'Birotti'	5 cm caliper	M
Silk Tree	<i>Albizia julibrissin</i>	5 cm caliper	M

*City of Surrey Planning & Development Department*

## REPLACEMENT TREES

**NOTES TO THE TABLE:**

(1) IN THE MINIMUM SIZE COLUMN, REFERENCE TO A FIGURE IN CENTIMETRES (cm) IS A MEASUREMENT OF TRUNK DIAMETER 15 cm ABOVE THE GROUND. REFERENCE TO A FIGURE IN METRES (m) IS A MEASUREMENT OF HEIGHT ABOVE THE GROUND.

(2) THE COLUMN HEADING "TYPE", L = LARGE, M = MEDIUM, S = SMALL AND F = FASTIGIATE (OR COLUMNAR) AND REFERS TO THE SIZE OF TREE AT MATURITY, NOT THE SIZE WHEN PLANTED.

COMMON NAME	BOTANICAL NAME	PLANTING SIZE	TYPE
Tree-of-Heaven	<i>Alianthus altissima</i>	5 cm caliper	M
Japanese Angelica Tree	<i>Aralia elata</i>	5 cm caliper	M
Pacific Madrone	<i>Arbutus menziesii</i>	3 m height	M
Jacquemontii Birch	<i>Betula jacquemontii</i>	5 cm caliper	M
Weeping Birch	<i>Betula lanciniata</i>	5 cm caliper	M
River Birch	<i>Betula nigra</i>	5 cm caliper	M
Paper Birch	<i>Betula papyrifera</i>	5 cm caliper	M
European White Birch	<i>Betula pendula</i>	5 cm caliper	M
Asian White Birch	<i>Betula platyphylla</i>	5 cm caliper	M
Katsura Tree	<i>Cercidiphyllum japonicum</i>	5 cm caliper	M
Nootka Cypress	<i>Chamaecyparis nootkatensis</i>	3 m height	M
Drooping Nootka Cypress	<i>Chamaesyparis nootkatensis</i> 'Pendula'	3 m height	M
Finge Tree	<i>Chionanthus virginicus</i>	5 cm caliper	M
Giant Dogwood	<i>Cornus controversa</i>	5 cm caliper	M
Flowering Dogwood	<i>Cornus florida</i>	5 cm caliper	M
Pacific Dogwood	<i>Cornus nuttallia</i>	5 cm caliper	M
Handkerchief Tree	<i>Davidia involucrata</i>	5 cm caliper	M
Autumn Applause Ash	<i>Fraxinus americana</i> 'Autumn Applause'	5 cm caliper	M
Autumn Purple Ash	<i>Fraxinus americana</i> 'Autumn Purple'	5 cm caliper	M
Flowering Ash	<i>Fraxinus ornus</i>	5 cm caliper	M
Raywood Ash	<i>Fraxinus oxycarpa</i> 'Raywood'	5 cm caliper	M
Patmore Ash	<i>Fraxinus pennsylvanica</i> 'Patmore'	5 cm caliper	M
Summit Ash	<i>Fraxinus pennsylvanica</i> 'Summit'	5 cm caliper	M
Urbanite Ash	<i>Fraxinus pennsylvanica</i> 'Urbanite'	5 cm caliper	M
Mountain Silverbell	<i>Halesia monticola</i>	5 cm caliper	M
Japanese Walnut	<i>Juglans ailantifolia</i>	5 cm caliper	M
Butternut	<i>Juglans cinera</i>	5 cm caliper	M
Golden Rain Tree	<i>Koelreuteria paniculata</i>	5 cm caliper	M
Goldenchain Tree	<i>Laburnum watereri</i> 'Vossii'	5 cm caliper	M
European Larch	<i>Larix decidua</i>	3 m height	M

## REPLACEMENT TREES

**NOTES TO THE TABLE:**

(1) IN THE MINIMUM SIZE COLUMN, REFERENCE TO A FIGURE IN CENTIMETRES (cm) IS A MEASUREMENT OF TRUNK DIAMETER 15 cm ABOVE THE GROUND. REFERENCE TO A FIGURE IN METRES (m) IS A MEASUREMENT OF HEIGHT ABOVE THE GROUND.

(2) THE COLUMN HEADING "TYPE", L = LARGE, M = MEDIUM, S = SMALL AND F = FASTIGIATE (OR COLUMNAR) AND REFERS TO THE SIZE OF TREE AT MATURITY, NOT THE SIZE WHEN PLANTED.

COMMON NAME	BOTANICAL NAME	PLANTING SIZE	TYPE
Cucumber Tree	<i>Magnolia acuminata</i>	3 m height	M
Dawson Magnolia	<i>Magnolia dawsoniana</i>	3 m height	M
Southern Magnolia	<i>Magnolia Grandiflora</i>	3 m height	M
Northern Japanese Magnolia	<i>Magnolia Kobus</i>	3 m height	M
Antarctic Beech	<i>Nothofagus antarctica</i>	5 cm caliper	M
Sour Gum Tree	<i>Nyssa sylvatica</i>	5 cm caliper	M
Empress Tree	<i>Paulownia tomentosum</i>	5 cm caliper	M
Amur Cork Tree	<i>Phellodendron amurense</i>	5 cm caliper	M
Himalayan White Pine	<i>Pinus agriffithii wallichiana</i>	3 m height	M
Shore Pine	<i>Pinus contorta</i>	3 m height	M
Western White Pine	<i>Pinus monticola</i>	3 m height	M
Austrian Pine	<i>Pinus nigra</i>	3 m height	M
Purpleleaf Plum	<i>Prunus cerasifera pissardi 'Nigra'</i>	5 cm caliper	M
Sargent Flowering Cherry	<i>Prunus sargentii</i>	5 cm caliper	M
Black Cherry	<i>Prunus serotina</i>	5 cm caliper	M
Yoshino Cherry	<i>Prunus yedoensis</i>	5 cm caliper	M
Pink Locust	<i>Robinia ambigua 'Idahoensis'</i>	5 cm caliper	M
Corkscrew Willow	<i>Salix matsudana 'T'ortuosa'</i>	5 cm caliper	M
Umbrella Pine	<i>Sciadopitys verticillata</i>	3 m height	M
Whitebeam	<i>Sorbus airia 'Lutescens'</i>	5 cm caliper	M
European Mountain Ash	<i>Sorbus aucuparia</i>	5 cm caliper	M
Pink Pagoda Mountain Ash	<i>Sorbus huphensis 'Pink Pagoda'</i>	5 cm caliper	M
Pacific Yew	<i>Taxus brevifolia</i>	3 m height	M
Redmond Linden	<i>Tilia americana 'Redmond'</i>	5 cm caliper	M
Little Leaf Linden	<i>Tilia cordata</i>	5 cm caliper	M
Chancellor Litteleaf Linden	<i>Tilia cordata 'Chancellor'</i>	5 cm caliper	M
Greenspire Littleleaf Linden	<i>Tilia cordata 'Greenspire'</i>	5 cm caliper	M
Crimean Linden	<i>Tilia euchlora</i>	5 cm caliper	M
Siberian Elm	<i>Ulmus pumila</i>	5 cm caliper	M
Green Vase Japanese Zelkova	<i>Zelkova serrata 'Green Vase'</i>	5 cm caliper	M

## REPLACEMENT TREES

**NOTES TO THE TABLE:**

(1) IN THE MINIMUM SIZE COLUMN, REFERENCE TO A FIGURE IN CENTIMETRES (cm) IS A MEASUREMENT OF TRUNK DIAMETER 15 cm ABOVE THE GROUND. REFERENCE TO A FIGURE IN METRES (m) IS A MEASUREMENT OF HEIGHT ABOVE THE GROUND.

(2) THE COLUMN HEADING "TYPE", L = LARGE, M = MEDIUM, S = SMALL AND F = FASTIGIATE (OR COLUMNAR) AND REFERS TO THE SIZE OF TREE AT MATURITY, NOT THE SIZE WHEN PLANTED.

COMMON NAME	BOTANICAL NAME	PLANTING SIZE	TYPE
Balsam Fir	<i>Abies balsamea</i>	3 m height	L
White Fir	<i>Abies concolor</i>	3 m height	L
Fraser's Fir	<i>Abies fraseri</i>	3 m height	L
Grand Fir	<i>Abies grandis</i>	3 m height	L
Alpine Fir	<i>Abies lasiocarpa</i>	3 m height	L
Noble Fir	<i>Abies procera</i>	3 m height	L
Bigleaf Maple	<i>Acer macrophyllum</i>	5 cm caliper	L
Deborah Maple	<i>Acer platinoides</i> 'Deborah'	5 cm caliper	L
Sycamore Maple	<i>Acer pseudoplatanus</i>	5 cm caliper	L
Red Maple	<i>Acer rubrum</i>	5 cm caliper	L
Morgan Maple	<i>Acer rubrum</i> 'Morgan'	5 cm caliper	L
Red Sunset Maple	<i>Acer rubrum</i> 'Red Sunset'	5 cm caliper	L
Silver Maple	<i>Acer saccharinum</i>	5 cm caliper	L
Sugar Maple	<i>Acer saccharum</i>	5 cm caliper	L
Common Horsechestnut	<i>Aesculus hippocastanum</i>	5 cm caliper	L
Monkey Puzzle Tree	<i>Araucaria araucana</i>	3 m height	L
California Incense Cedar	<i>Calocedrus decurrens</i>	3 m height	L
European Hornbeam	<i>Carpinus betulus</i>	5 cm caliper	L
Common Catalpa	<i>Catalpa bignoides</i>	5 cm caliper	L
Western Catalpa	<i>Catalpa speciosa</i>	5 cm caliper	L
Atlas Cedar	<i>Cedrus atlantica</i>	3 m height	L
Blue Atlas Cedar	<i>Cedrus atlantica</i> 'Gluca'	3 m height	L
Cedar of Lebanon	<i>Cedrus libani</i>	3 m height	L
Hinoki False Cypress	<i>Chamaecyparis obtusa</i>	3 m height	L
Saware False Cypress	<i>Chamaecyparis pisifera</i>	3 m height	L
American Beech	<i>Fagus grandiflora</i>	5 cm caliper	L
European Beech	<i>Fagus sylvatica</i>	5 cm caliper	L
Copper Beech	<i>Fagus sylvatica</i> 'Autopurpurea'	5 cm caliper	L
White Ash	<i>Fraxinus americana</i>	5 cm caliper	L
Autumn Purple Ash	<i>Fraxinus americana</i> 'Autumn Purple'	5 cm caliper	L

## REPLACEMENT TREES

### NOTES TO THE TABLE:

(1) IN THE MINIMUM SIZE COLUMN, REFERENCE TO A FIGURE IN CENTIMETRES (cm) IS A MEASUREMENT OF TRUNK DIAMETER 15 cm ABOVE THE GROUND. REFERENCE TO A FIGURE IN METRES (m) IS A MEASUREMENT OF HEIGHT ABOVE THE GROUND.

(2) THE COLUMN HEADING "TYPE", L = LARGE, M = MEDIUM, S = SMALL AND F = FASTIGIATE (OR COLUMNAR) AND REFERS TO THE SIZE OF TREE AT MATURITY, NOT THE SIZE WHEN PLANTED.

COMMON NAME	BOTANICAL NAME	PLANTING SIZE	TYPE
European Ash	<i>Fraxinus excelsior</i>	5 cm caliper	L
Westhoff's Glory Ash	<i>Fraxinus excelsior</i> 'Westhoff's Glory'	5 cm caliper	L
Green Ash	<i>Fraxinus pennsylvanica</i>	5 cm caliper	L
Maidenhair Tree	<i>Ginkgo biloba</i>	5 cm caliper	L
Thornless Honeylocust	<i>Gleditsia tricanthos inermis</i>	5 cm caliper	L
Skyline Honeylocust	<i>Gleditsia tricanthos inermis</i> 'Skyline'	5 cm caliper	L
Sunburst Honeylocust L	<i>Gleditsia tricanthos inermis</i> 'Sunburst'	5 cm caliper	
Shademaster Honeylocust	<i>Gleditsia tricanthos inermis</i> 'Shademaster'	5 cm caliper	L
Black Walnut	<i>Juglans nigra</i>	5 cm caliper	L
English Walnut	<i>Juglans regia</i>	5 cm caliper	L
Worplesdon Sweatgum	<i>Liquidambar styraciflua</i> 'Worpleston'	5 cm caliper	L
Tuliptree	<i>Liriodendron tulipifera</i>	5 cm caliper	L
Dawn Redwood	<i>Metasequoia glyptostroboides</i>	3 m height	L
Norway Spruce	<i>Picea abies</i>	3 m height	L
White Spruce	<i>Picea glauca</i>	3 m height	L
Serbian Spruce	<i>Picea omorika</i>	3 m height	L
Colorado Spruce	<i>Picea pungens</i>	3 m height	L
Colorado Blue Spruce	<i>Picea pungens</i> 'Glauca'	3 m height	L
Hoop's Blue Spruce	<i>Picea pungens</i> 'Hoopsii'	3 m height	L
Koster Blue Spruce	<i>Picea pungens</i> 'Koster'	3 m height	L
Sitka Spruce	<i>Picea sitchensis</i>	3 m height	L
Ponderosa Pine	<i>Pinus ponderosa</i>	3 m height	L
Monterey Pine	<i>Pinus radiata</i>	3 m height	L
Red Pine	<i>Pinus resinosa</i>	3 m height	L
Eastern White Pine	<i>Pinus strobus</i>	3 m height	L
Scotch Pine	<i>Pinus sylvestris</i>	3 m height	L
Japanese Black Pine	<i>Pinus thunbergii</i>	3 m height	L
London Plane Tree	<i>Platanus acerifolia</i>	5 cm caliper	L
Oriental Plane Tree	<i>Platanus orientalis</i>	5 cm caliper	L
Douglas Fir	<i>Pseudotsuga menziesii</i>	3 m height	L

## REPLACEMENT TREES

**NOTES TO THE TABLE:**

(1) IN THE MINIMUM SIZE COLUMN, REFERENCE TO A FIGURE IN CENTIMETRES (cm) IS A MEASUREMENT OF TRUNK DIAMETER 15 cm ABOVE THE GROUND. REFERENCE TO A FIGURE IN METRES (m) IS A MEASUREMENT OF HEIGHT ABOVE THE GROUND.

(2) THE COLUMN HEADING "TYPE", L = LARGE, M = MEDIUM, S = SMALL AND F = FASTIGIATE (OR COLUMNAR) AND REFERS TO THE SIZE OF TREE AT MATURITY, NOT THE SIZE WHEN PLANTED.

COMMON NAME	BOTANICAL NAME	PLANTING SIZE	TYPE
Oriental Chestnut Oak	<i>Quercus acutissima</i>	5 cm caliper	L
Scarlet Oak	<i>Quercus coccinea</i>	5 cm caliper	L
Garry Oak	<i>Quercus garryana</i>	5 cm caliper	L
Pin Oak	<i>Quercus palustris</i>	5 cm caliper	L
English Oak	<i>Quercus robur</i>	5 cm caliper	L
Red Oak	<i>Quercus rubra</i>	5 cm caliper	L
Shumard Oak	<i>Quercus shumardii</i>	5 cm caliper	L
Black Locust	<i>Robinia pseudoacacia</i>	5 cm caliper	L
Yellow Leaf Black Locust	<i>Robinia pseudoacacia</i> 'Frisia'	5 cm caliper	L
White Willow	<i>Salix alba</i>	5 cm caliper	L
Golden Weeping Willow	<i>Salix alba</i> 'Tristis'	5 cm caliper	L
Weeping Willow	<i>Salix babylonica</i>	5 cm caliper	L
Corkscrew Willow	<i>Salix matsudana</i> 'Tortuosa'	5 cm caliper	L
Coast Redwood	<i>Sequoia sempervirens</i>	3 m height	L
Giant Redwood	<i>Sequoiadendron giganteum</i>	3 m height	L
Golden Cedar	<i>Thuja plicata</i> 'Aurea'	3 m height	L
Western Red Cedar	<i>Thuja plicata</i> 'Excelsior'	3 m height	L
Basswood	<i>Tilia americana</i>	5 cm caliper	L
Canadian Hemlock	<i>Tsuga canadensis</i>	3 m height	L
Western Hemlock	<i>Tsuga heterophylla</i>	3 m height	L
Mountain Hemlock	<i>Tsuga mertensiana</i>	3 m height	L
American Elm	<i>Ulmus americana</i>	5 cm caliper	L
Scotch Elm	<i>Ulmus glabra</i>	5 cm caliper	L
Armstrong Maple	<i>Acer rubrum</i> 'Armstrong'	5 cm caliper	F
Bowhall Maple	<i>Acer rubrum</i> 'Bowhall'	5 cm caliper	F
Columnar Red Maple	<i>Acer rubrum</i> 'Columnaire'	5 cm caliper	F
Karpick Maple	<i>Acer rubrum</i> 'Karpick'	5 cm caliper	F
Scanlon Red Maple	<i>Acer rubrum</i> 'Scanlon'	5 cm caliper	F
Scarlet Sentinel Maple	<i>Acer rubrum</i> 'Scarlet Sentinel'	5 cm caliper	F

## REPLACEMENT TREES

**NOTES TO THE TABLE:**

(1) IN THE MINIMUM SIZE COLUMN, REFERENCE TO A FIGURE IN CENTIMETRES (cm) IS A MEASUREMENT OF TRUNK DIAMETER 15 cm ABOVE THE GROUND. REFERENCE TO A FIGURE IN METRES (m) IS A MEASUREMENT OF HEIGHT ABOVE THE GROUND.

(2) THE COLUMN HEADING "TYPE", L = LARGE, M = MEDIUM, S = SMALL AND F = FASTIGIATE (OR COLUMNAR) AND REFERS TO THE SIZE OF TREE AT MATURITY, NOT THE SIZE WHEN PLANTED.

<b>COMMON NAME</b>	<b>BOTANICAL NAME</b>	<b>PLANTING SIZE</b>	<b>TYPE</b>
Pyramidal European Hornbeam	<i>Carpinus betulus</i> 'Fastigiata'	5 cm caliper	F
Franz Fontaine Hornbeam	<i>Carpinus betulus</i> 'Franz Fontaine'	5 cm caliper	F
Purple Dawyck Beech	<i>Fagus sylvatica</i> 'Dawyckii Purple'	5 cm caliper	F
Dawyck Beech	<i>Fagus sylvatica</i> 'Dawyckii'	5 cm caliper	F
Princeton Sentry Maidenhair Tree	<i>Ginkgo biloba</i> 'Princeton Sentry'	5 cm caliper	F
Swedish Columnar Aspen	<i>Populus tremuloides</i> 'Erecta'	5 cm caliper	F
Amanagowa Cherry	<i>Prunus serrulta</i> 'Amanagowa'	5 cm caliper	F
Chanticleer Pear	<i>Pyrus calleryana</i> 'Chanticleer'	5 cm caliper	F
Upright English Oak	<i>Quercus robur</i> 'Fastigiata'	5 cm caliper	F
Upright Japanese Pagoda Tree	<i>Sophora japonica</i> 'Regent'	5 cm caliper	F



**SCHEDULE "F"**  
**Tree Protection Barrier Detail**

**Tree Protection Distance Table**

Trunk Diameter (cm)	Minimum Protection Req'd Around Tree (distance from trunk in metres)
20	1.2
25	1.5
30	1.8
35	2.1
40	2.4
45	2.7
50	3
55	3.3
60	3.6
75	4.5
90	5
100	6.0

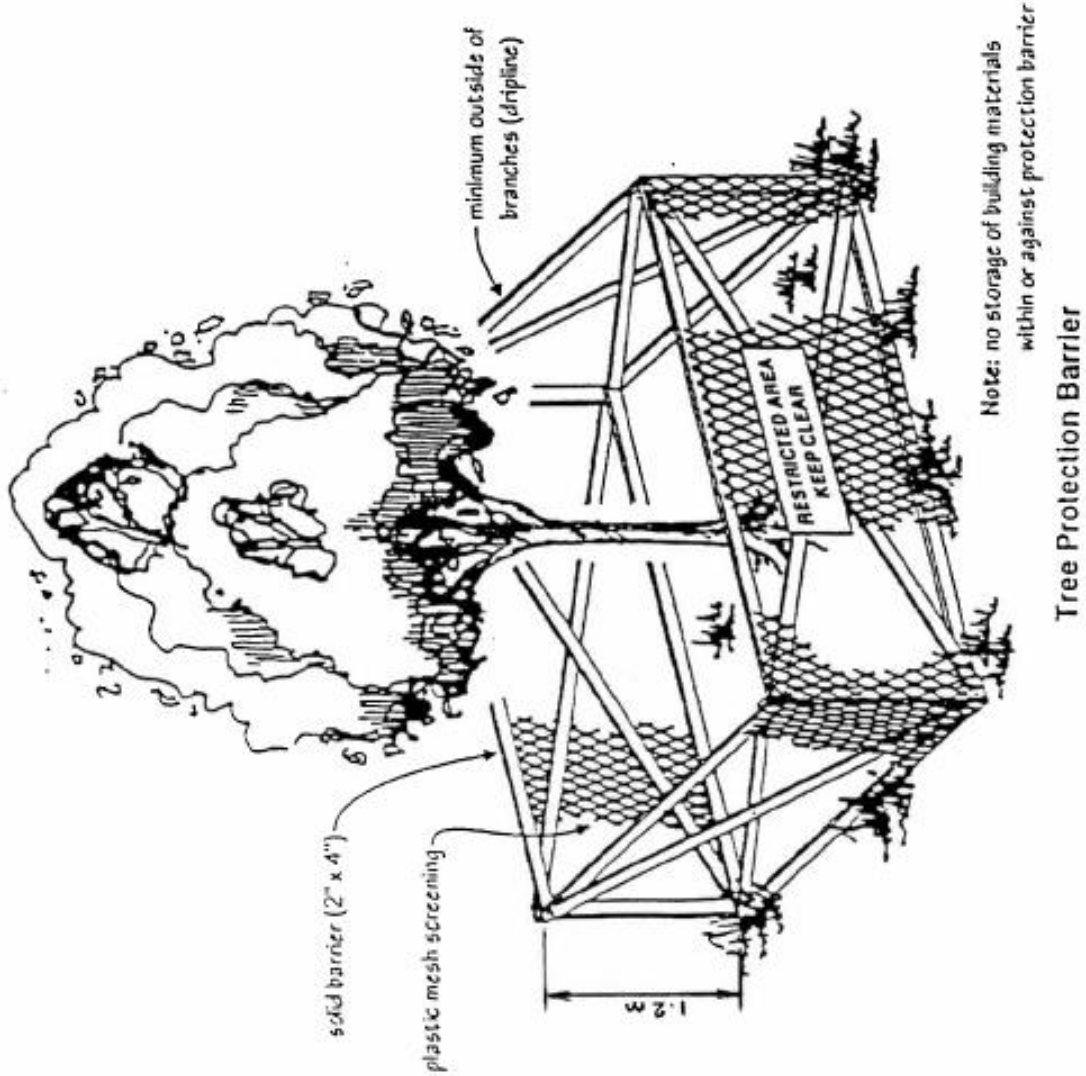

**Surrey Tree Protection Bylaw, 2006, No. 16100  
Summary and Comparison Table**

<b>Proposed Surrey Tree Protection Bylaw, 2006, No. 16100</b>	<b>Recommendations approved by Council as per Corporate Report R185 (July 25, 2005) and C003 (February 20, 2006) or Reasons for Inclusion</b>	<b>Current Tree Preservation Bylaw, 1996, No. 12880</b>
<b>Part 1 - Introductory Provisions</b>		
s.1, Title	<b>Required Bylaw Section</b>	Similar s.1.
s.2, Definitions: 28 defined terms are included for greater certainty, including the new definitions of "tree survey" and "specimen quality tree".	Recommendation 4(b) (CR - No. R185) to add a definition of "tree survey" and Recommendation 2(b) (CR – No. C003) to add a definition of "specimen quality tree".	s.2, Definitions: contains 15 defined terms.
<b>Part 2 - Application and Exemptions</b>		
ss.3-5: the Bylaw applies only to protected trees as defined, but does not apply to the protected trees under hydro or pipeline jurisdictions or within City-owned property or highways.	<i>Required housekeeping Bylaw Sections to clarify applicability.</i>	Similar provisions in s.3.
<b>Part 3 - Prohibitions</b>		
s.6: no person shall cut, remove or damage any protected tree except as permitted and in accordance with the Bylaw	<i>Required housekeeping Bylaw Section for enforcement purposes</i>	Similar provision in s.4
s.7: an owner may cut an imminently dangerous tree without a permit, but may be subject to a penalty if the City determines that the tree was not in imminent danger.	<i>Required housekeeping Bylaw Section to deal with imminently dangerous situations</i>	Similar provision in s.4, also in s.18 and s.24, with improved clarification.
s.8: no person shall fail to comply with a tree cutting permit	<i>Required housekeeping Bylaw Section for enforcement purposes</i>	Same provision in s.5.
s.9: the arborist who submitted a report on a tree cannot also cut or remove that same tree	Recommendation 4(c) (CR - No. R185)	
<b>Part 4 - Offences</b>		
ss.10-11: an offence against this Bylaw is subject to a fine of not less than \$50 and not more than \$10,000, and each day a violation is caused to exist constitutes a separate offence.	<i>Required housekeeping Bylaw Section for enforcement purposes.</i>	Similar provisions in ss.6-7, with a maximum fine of \$10,000 but no minimum fine.

<p><b>Proposed Surrey Tree Protection Bylaw, 2006, No. 16100</b></p>	<p><b>Recommendations approved by Council as per Corporate Report R185 (July 25, 2005) and C003 (February 20, 2006) or Reasons for Inclusion</b></p>	<p><b>Current Tree Preservation Bylaw, 1996, No. 12880</b></p>
<p><b>Part 5 - Penalties</b></p>		
<p>s.12: if an owner cuts or removes trees in violation of the Bylaw or a tree cutting permit, the owner must pay penalties and replant on the same lot. If the trees cut or removed are proposed to be preserved the replacement trees must be replanted at the same locations.</p>	<p><i>Required housekeeping Bylaw Section to discourage illegal tree removal.</i></p>	<p>Similar provisions for penalty and tree replanting provided in ss.8-9, with amount of fine and penalty in accordance with the Act, but without the requirement for replanting at the same locations.</p>
<p>ss.13-16: penalties for illegal cutting of a protected tree, specimen quality tree, and significant tree are \$1,000, \$2,000, and \$10,000 respectively and the amount and size for replacement trees are to be determined by the General Manager.</p>	<p><i>Required housekeeping Bylaw Section for enforcement purposes and to discourage illegal tree cutting.</i></p>	<p>Similar provisions in ss.8-9 without prescribing the amount of penalties.</p>
<p>ss.17-19: if the owner fails or refuses to plant the required replacement trees, the City may use the securities to replant or the City may replant at the owner's expense and the costs may be added to the property taxes.</p>	<p><i>Required housekeeping Bylaw Section for enforcement purposes</i></p>	
<p>s.20: to clarify that prosecution under Part 4 does not exempt a person from penalties and replanting requirements under Part 5.</p>	<p><i>Required housekeeping Bylaw Section for enforcement purposes.</i></p>	
<p><b>Part 6 - Significant Trees</b></p>		
<p>ss.21-23: a significant tree cannot be cut unless it is first removed from the Bylaw and it must be maintained by the owner according to sound arboricultural practice.</p>	<p><i>Required housekeeping Bylaw Section for enforcement purposes.</i></p>	<p>Similar provisions in ss.13-14 and s.26.</p>
<p>s.24: a plaque or marker may be placed near the significant tree.</p>	<p><i>Housekeeping Bylaw Section to retain a similar provision in the current Bylaw.</i></p>	<p>Similar provision in s.15.</p>

<p><b>Proposed Surrey Tree Protection Bylaw, 2006, No. 16100</b></p>	<p><b>Recommendations approved by Council as per Corporate Report R185 (July 25, 2005) and C003 (February 20, 2006) or Reasons for Inclusion</b></p>	<p><b>Current Tree Preservation Bylaw, 1996, No. 12880</b></p>
<p><b>Part 7, Tree Cutting Permits</b></p>		
<p>s.25: A tree cutting permit is required by any person for cutting a protected tree and the tree cutting permit prescribes the requirement for security and replacement trees. The forms for the tree cutting permit and application are also prescribed in Schedules</p>	<p><i>Required Housekeeping Bylaw Section for enforcement purposes.</i></p>	<p>Similar requirement in ss.20-21.</p>
<p>s.26: Requires the posting of the tree cutting permit on the lot.</p>	<p>Recommendation 2(d) (CR - No. C003).</p>	
<p>s.27: Pruning of protected trees does not require a tree cutting permit, but it must be in accordance with sound arboricultural practice, and specifies that excessive lift pruning and topping are not included as sound arboricultural practice.</p>	<p>Recommendation 4(e) (CR - No. R185), also Recommendation 2(g) (CR - No. C003).</p>	<p>Similar requirements in s. 19, without specific exclusion of excessive lift pruning and topping.</p>
<p>s.28: Requires payment of fee for each tree cutting permit application, with certain exceptions (i.e., hazardous trees, trees impairing public works/utilities, for pruning of a significant tree).</p>	<p><i>Required housekeeping Bylaw Section for administrative purposes.</i></p>	<p>Similar requirement in s.22, without exceptions.</p>
<p>s.29: Prescribes circumstances and conditions under which a tree cutting permit may only be issued.</p>	<p><i>Required housekeeping Bylaw Section for administrative purposes.</i></p>	<p>Similar provisions in s.24.</p>
<p>s.29(e): Requires the owner of the lot within ALR to remove trees for agricultural purposes to agree in writing not to subdivide or rezone for a period of 5 years</p>	<p>Recommendation 4(k) (CR - No. R185)</p>	
<p>s.29(f): Requires the owner of the lot zoned for agricultural, but outside ALR to remove trees for agricultural purposes to agree by a restrictive covenant not to make application for development for 10 years.</p>	<p>Recommendation 2(k) (CR - No. C003).</p>	<p>s.24(f) only requires a sworn declaration of the owner that tree cutting is for agricultural purposes.</p>
<p>s.30: Prescribes conditions under which a tree cutting permit may be issued to remove a protected tree inappropriately located.</p>	<p>Recommendation 4(h) (CR - No. R185), also Recommendation 2(j) (CR - No. C003).</p>	

<p><b>Proposed Surrey Tree Protection Bylaw, 2006, No. 16100</b></p>	<p><b>Recommendations approved by Council as per Corporate Report R185 (July 25, 2005) and C003 (February 20, 2006) or Reasons for Inclusion</b></p>	<p><b>Current Tree Preservation Bylaw, 1996, No. 12880</b></p>
<p>s.31: Prescribes conditions under which a tree cutting permit may be issued for pruning of a significant tree.</p>	<p><i>Housekeeping Bylaw Section to retain a similar provision of the current Bylaw.</i></p>	<p>Similar provision in s.25.</p>
<p>s.32: Prescribes the conditions that may be imposed for issuance of a tree cutting permit (i.e., tree survey, lot grading and servicing plans, site supervision, sound arboricultural practice, replacement trees).</p>	<p>Recommendation 4(l) (CR - No. R185), also Recommendation 2(f) (CR - No. C003) to encourage treatment of diseased trees rather than removal is found in s.32(c).</p>	<p>Similar provisions in s.27.</p>
<p>s.33: Specifies that a tree cutting permit may be revoked under certain situations.</p>	<p><i>Required housekeeping Bylaw Section for administrative purposes.</i></p>	<p>Similar, but less stringent provisions in s.27(c).</p>
<p>s.34: The City may order an independent arborist review at the owner's expense if the owner's arborist report is found inadequate or inaccurate.</p>	<p>Recommendation 2(c) (CR - No. C003).</p>	
<p>s.35: A tree cutting permit may be refused for trees located in high environmentally sensitive areas</p>	<p><i>Required housekeeping Bylaw Section for clarification of intent.</i></p>	<p>Similar provision in s.27(f).</p>
<p><b>Part 8 - Permit Fees and Securities</b></p>		
<p>ss.36-41: Prescribes tree cutting permit fees, which reflect a 10% increase over the current fees, and a tree cutting permit amendment fee of \$60 is added.</p>	<p>Recommendation 4(m) (CR - No. R185).</p>	<p>Similar provisions in s.22 and Schedule I.</p>
<p>s.39: Prescribes tree cutting permit fees for properties within ALR separately and the fees remain the same as in the current Bylaw.</p>	<p>Recommendation 2(l)</p>	
<p>ss.42-44: Provides for the collection of securities for replacement trees and for the protected trees proposed to be retained in a development.</p>	<p>Recommendation 4(j) (CR - No. R185), extended to include securities collected for replacement trees.</p>	<p>Similar provisions in ss.11-12, with a flat rate of \$200 per tree.</p>
<p>s.45: Prescribes the amount of securities for replacement trees (i.e., \$300 and \$600 for 5 centimetre and 8 centimetre caliper, respectively)</p>	<p>Recommendation 4(j) (CR - No. R185), extended to include securities collected for replacement trees.</p>	

<b>Proposed Surrey Tree Protection Bylaw, 2006, No. 16100</b>	<b>Recommendations approved by Council as per Corporate Report R185 (July 25, 2005) and C003 (February 20, 2006) or Reasons for Inclusion</b>	<b>Current Tree Preservation Bylaw, 1996, No. 12880</b>
ss.46: Prescribes the amount of securities for the existing trees intended to be preserved by the owner in conjunction with a proposed development (i.e., \$10,000, \$5,000, and \$3,000 for each significant tree, specimen quality tree and protected tree, respectively, with a maximum of \$100,000 for each development site)	Recommendation 4(j) (CR - No. R185).	
ss.47-49: Provides for the release of securities in stages.	Recommendation 4(j) (CR - No. R185)	
<b>Part 9 - Replacement Trees</b>		
ss.50-56: Requires replacement trees for each lot where protected trees are removed, and prescribes the sizes, amount, species, locations, standard of practice, and when replacement trees are to be planted.	Recommendation 4(f) (CR - No. R185).	Similar provisions in ss.28-31.
s.57: Requires replacement trees at 2 to 1 ratio, and \$300 cash-in-lieu for each replacement tree not planted on site.	Recommendations 4(f) and 5 (CR - No. R185).	Similar provisions in s.32 without cash-in-lieu provision.
s.58: Provides for replacement tree upsizing and increase in securities at the discretion of the General Manager.	Recommendation 2(h) (CR - No. C003).	
s.59: Sets upper limit of cash-in-lieu at \$15,000 per acre	Recommendation 6 (CR - No. R185).	
s.60: Prescribes the number of replacement trees per lot in new subdivisions under various zones.	<i>Required housekeeping Bylaw Section for administrative purposes.</i>	
s.61: Provides for replacement tree upsizing and increase in security where less than half of the removed trees are replaced in a development site.	Recommendation 2(h) (CR - No. C003).	
s.62: Allows the retained trees, which are not protected trees to be considered as a credit towards the required replacement trees and provides for transfer of credits to other lots with some limitations	<i>Required housekeeping Bylaw Section for administrative purposes.</i>	

<b>Proposed Surrey Tree Protection Bylaw, 2006, No. 16100</b>	<b>Recommendations approved by Council as per Corporate Report R185 (July 25, 2005) and C003 (February 20, 2006) or Reasons for Inclusion</b>	<b>Current Tree Preservation Bylaw, 1996, No. 12880</b>
<b>Part 10 - Tree Protection</b>		
ss.63-67: Requires tree protection barrier for all the protected trees in a development site, prescribes standards, and prohibits site disturbance.	<i>Required housekeeping Bylaw Sections for administrative and enforcement purposes, also Recommendation 4(d) (CR - No. R185)</i>	Similar, but less stringent provisions in s.10.
<b>Part 11 - Inspection and Assessment</b>		
s.68: Authorizes City staff as well as consultants retained by the City to enter without notice for inspection.	<i>Required housekeeping Bylaw Section for enforcement purposes and authority to enter is expanded to include City engaged consultants.</i>	Similar provisions in ss.16-17.
s.69: Prohibits the owner from removing the cut trees until the City has completed infraction investigation	<i>New Bylaw provision to enhance enforcement capability</i>	
ss.70-71: Provides for inspection of the replacement trees and payment of fees for re-inspection.	Recommendation 4(n) (CR - No. R185).	
<b>Part 12 - General Provisions</b>		
s.72: Provides for a transition period of 12 months for in-stream development applications.	Recommendation 2(0) (CR - No. C003).	
ss.73-75: Validating provisions.	<i>Required housekeeping Bylaw Sections for enforcement purposes.</i>	Similar provision in ss.38-40.
<b>Schedules</b>		
Schedule "A" - Environmentally Sensitive Areas.	<i>Required Bylaw Schedule.</i>	Same Schedule A.
Schedule "B" – List of Significant Trees updated and augmented.	<i>Required Bylaw Schedule, also Recommendation 4(a) (CR - No. R185).</i>	Similar Schedule B.
Schedule "B1" - Semiahmoo Trail to identify a tree protection area within which all trees are defined as Significant Trees.	<i>Required Bylaw Schedule</i>	
Schedule "C" - Application for tree cutting permit, including formats for tree survey and arborist report.	<i>Required Bylaw Schedule, also Recommendation 4(b) (CR - No. R185).</i>	Similar Schedule H.
Schedule "D" tree cutting permit form.	<i>Required Bylaw Schedule.</i>	Similar Schedules F and G.
Schedule "E - Acceptable Replacement Trees.	<i>Required Bylaw Schedule.</i>	Similar Schedule J.

<b>Proposed Surrey Tree Protection Bylaw, 2006, No. 16100</b>	<b>Recommendations approved by Council as per Corporate Report R185 (July 25, 2005) and C003 (February 20, 2006) or Reasons for Inclusion</b>	<b>Current Tree Preservation Bylaw, 1996, No. 12880</b>
Schedule "F" Tree Protection Barrier Detail	<i>Required Bylaw Schedule, also Recommendation 4(d) (CR - No. R185).</i>	Similar Schedule E.