

CITY OF SURREY

BY-LAW NO. 16188

A By-law to close and to remove the dedication
of a highway of a portion of 162 Street.

.....

WHEREAS pursuant to Subsection 40(1)(a) of the *Community Charter*, S.B.C. 2003, c. 26, the Council may, by by-law, close all or part of a highway that is vested in the municipality to all or some types of traffic;

AND WHEREAS pursuant to Section 40(2) of the *Community Charter*, S.B.C. 2003, c. 26, the Council may, by by-law, remove the dedication of a highway that has been closed by a by-law under Subsection 40(1)(a).

NOW THEREFORE the Council of the City of Surrey in open meeting assembled, ENACTS as follows:

1. That portion of road lying in Section 24 Township 1 New Westminster District shown outlined in heavy black line on a Reference Plan attached hereto, and forming part of this by-law, duly signed by the Mayor and Clerk, prepared by Montgomery Brisson, B.C.L.S. on the 6th day of December, 2006, and more particularly described as follows:

That portion of road dedicated by Plan LMP24217, called Parcel
"A" and containing 0.101 hectares,

(hereinafter referred to as that portion of 162 Street)

shall be closed to traffic.

2. The dedication as highway be removed of said portion of 162 Street.
3. This By-law may be cited for all purposes as "Surrey Close and Remove the Dedication of Highway of a Portion of 162 Street between 26 Avenue and 28 Avenue By-law, 2006, No. 16188".

READ A FIRST, SECOND AND THIRD TIME on the 18th day of December, 2006.

NOTICE OF INTENTION

ADVERTISED on the 23rd and 24th day of December and on the 30th and 31st day of December, 2006, in the SURREY LEADER/PEACE ARCH Community newspaper.

RECONSIDERED AND FINALLY ADOPTED, signed by the Mayor and Clerk, and sealed with the Corporate Seal on the 15th day of January, 2007.

_____ MAYOR

_____ CLERK

REFERENCE PLAN TO ACCOMPANY CITY OF SURREY HIGHWAY DEDICATION CANCELLATION BYLAW NUMBER 16188
 OF A PORTION OF ROAD LYING IN SECTION 24 TOWNSHIP 1 NEW WESTMINSTER DISTRICT DEDICATED BY PLAN LMP24217

B.C.G.S. 92G. 007
 PURSUANT TO SECTION 120, LAND TITLE ACT
 PURSUANT TO SECTION 40, COMMUNITY CHARTER

PLAN BCP _____

DEPOSITED IN THE LAND TITLE OFFICE
 AT NEW WESTMINSTER, B.C.

- LEGEND**
- ⊙ DENOTES CONTROL MONUMENT FOUND
 - DENOTES STANDARD IRON POST FOUND
 - ⊙ DENOTES STANDARD CONCRETE POST FOUND
 - ⊙ DENOTES NON-STANDARD POST FOUND
 - DENOTES STANDARD IRON POST SET
 - U DENOTES UNREGISTERED

BOOK OF REFERENCE		
DESCRIPTION	AREA	PARCEL
ROAD TO BE CLOSED		
PORTION OF ROAD LYING IN SEC. 24 TP. 1 N.W.D. DEDICATED BY PLAN LMP24217	0.101 ha	PARCEL 'A'

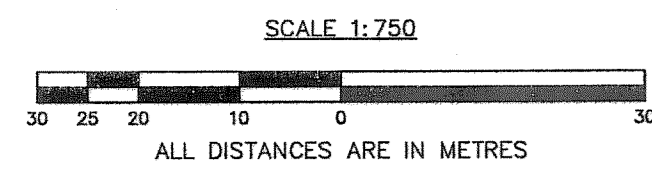

INTEGRATED SURVEY AREA NO. 1, SURREY, NAD83 (CSRS)

GRID BEARINGS ARE DERIVED FROM DUAL FREQUENCY, PHASE G.P.S. OBSERVATIONS BETWEEN GEODETIC CONTROL MONUMENTS 5741 AND 84H0589.

THIS PLAN SHOWS HORIZONTAL GROUND-LEVEL DISTANCES EXCEPT WHERE OTHERWISE NOTED. TO COMPUTE GRID DISTANCES, MULTIPLY GROUND LEVEL DISTANCES BY COMBINED FACTOR 0.9995946.

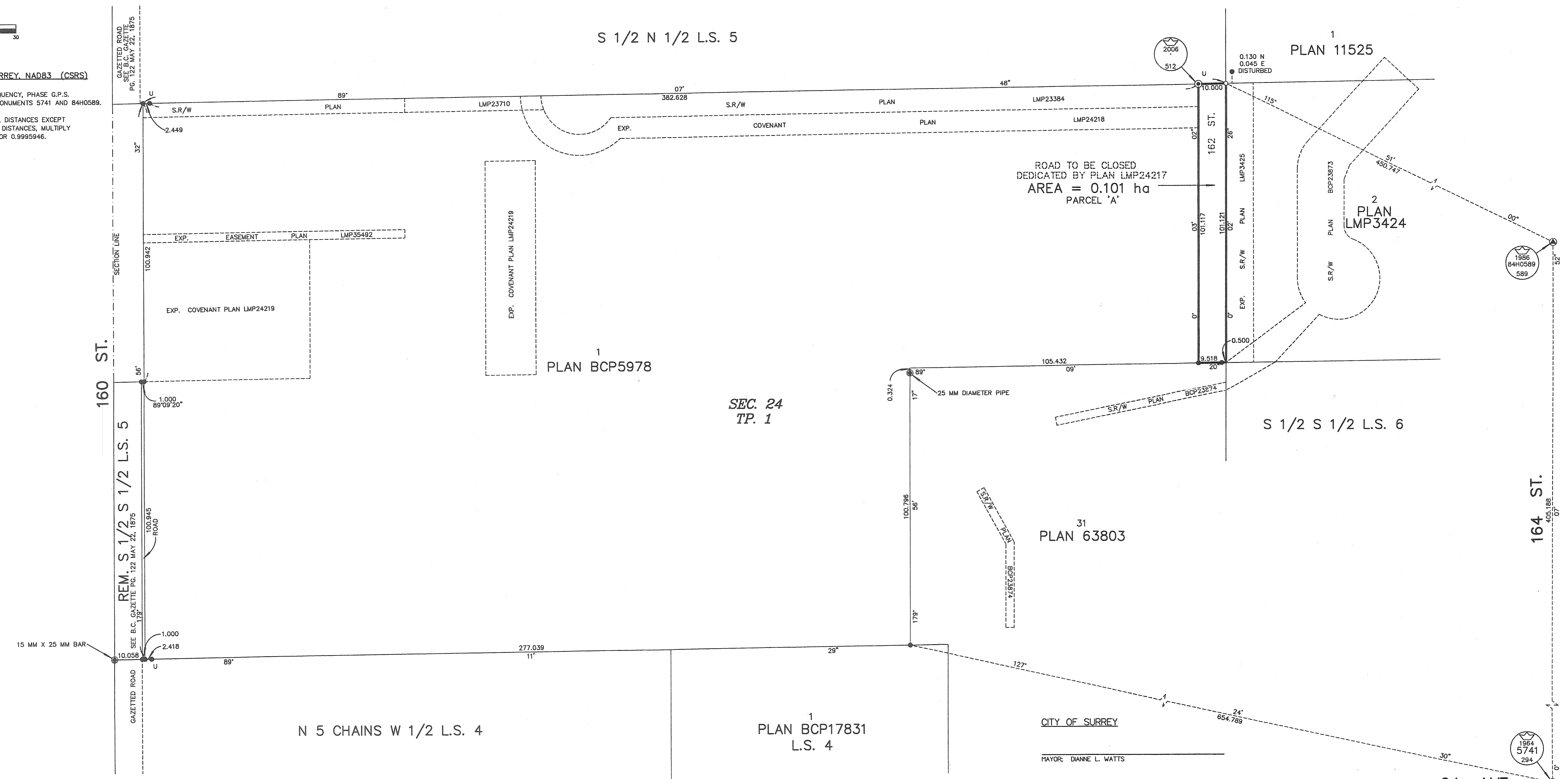
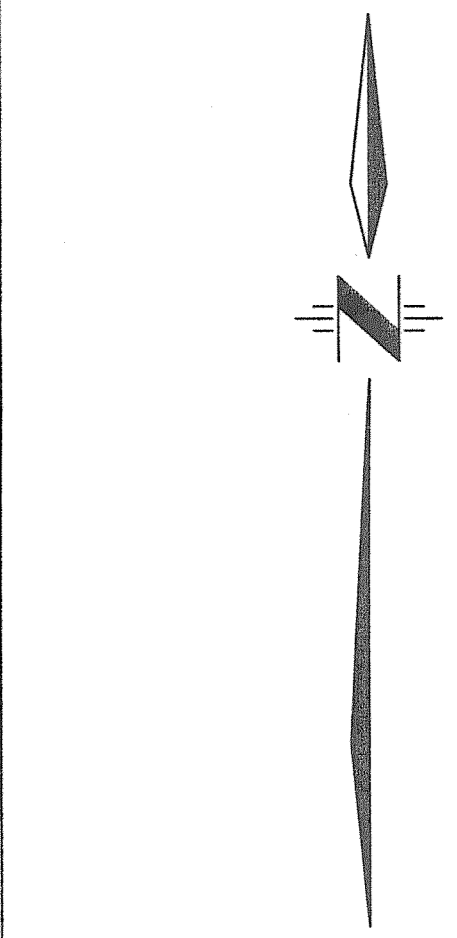

CITY OF SURREY
 SURVEY SECTION
 14245 - 56 AVE.
 SURREY, B.C. V3X 3A2
 TEL (604) 591-4253
 FAX (604) 591-8693

CITY OF SURREY
 MAYOR: DIANNE L. WATTS
 CITY CLERK:
 WITNESS AS TO THE SIGNATURE OF THE CITY CLERK
 ADDRESS OF WITNESS
 OCCUPATION OF WITNESS

24 AVE.
 THIS PLAN LIES WITHIN THE GREATER
 VANCOUVER REGIONAL DISTRICT

I, MONTGOMERY C. BRISSON, A BRITISH COLUMBIA LAND SURVEYOR, OF MISSION, IN BRITISH COLUMBIA, CERTIFY THAT I WAS PRESENT AT AND PERSONALLY SUPERINTENDED THE SURVEY REPRESENTED BY THIS PLAN, AND THAT THE SURVEY AND PLAN ARE CORRECT. THE FIELD SURVEY WAS COMPLETED ON THE 29TH DAY OF NOVEMBER, 2006. THE PLAN WAS COMPLETED AND CHECKED, AND THE CHECKLIST FILED UNDER ECP# 58329, ON THE 27TH DAY OF DECEMBER, 2006.

[Signature]
 B.C.L.S.