

CITY OF SURREY

BY-LAW NO. 14856

A by-law to dispose of portions of a public highway in exchange for adjoining lands necessary for a public highway.  
.....

WHEREAS pursuant to Section 525(3) of the *Local Government Act*, R.S.B.C. 1996, c.323, as amended, the Council may by by-law dispose of a portion of a highway in exchange for land necessary for the purpose of improving, widening, straightening, relocating or diverting a highway;

AND WHEREAS the Registered Owner of the land described in Section 2 of this By-law has agreed with the City of Surrey to make the exchange hereinafter provided for;

NOW, THEREFORE, the Council of the City of Surrey, in open meeting assembled, ENACTS AS FOLLOWS:

1. Upon receiving from the said Registered Owner, the conveyance or other assurance mentioned in Section 2 hereof, the Mayor and the Clerk of the City of Surrey are hereby authorized, in exchange therefore, to execute and deliver on behalf of the City such conveyance or other assurance as may be necessary for vesting in the said Registered Owner, ALL AND SINGULAR those certain parcels or tracts of land and premises situate, lying and being in the City of Surrey, in the Province of British Columbia:

Portion of Road dedicated on Plan LMP32926, Section 10 Township 2 New Westminster District, shown hatched on a Reference Plan, attached hereto and forming part of this by-law, duly signed by the Mayor and Clerk, prepared by L. Achtemichuk, B.C.L.S., on the 29th day of October, 2002, containing 179 square metres, called Parcel "C" and more particularly described as follows:

(Portion of Lane at Highway 10 and 148 Street)

2. For the purpose of acquiring adjacent lands for a public highway, the Mayor and Clerk are authorized to accept from the said Registered Owner, in exchange for the land mentioned in Section 1 hereof, the sum of One Dollar (\$1.00), together with such

conveyance or other assurance as may be necessary to vest in the Crown as a public highway, ALL AND SINGULAR those certain parcels or tracts of lands and premises situate, lying and being in the City of Surrey, in the Province of British Columbia:

Those portions of land shown within the bold outline on a Reference Plan, attached hereto and forming part of this by-law, duly signed by the Mayor and Clerk, prepared by L. Achtemichuk, B.C.L.S., on the 29th day of October, 2002, and more particularly described as follows:

Portion of Parcel Identifier: 010-321-331, Lot "B" Section 10 Township 2 New Westminster District Plan 17987, containing 119 square metres, and called Parcel "B":

(Portion of 5630 - 148 Street)

Portion of Parcel Identifier: 010-321-373, Lot "C" Except: Part subdivided by Plan 34233; Section 10 Township 2 New Westminster District Plan 17987, containing 134 square metres, and called Parcel "A":

(Portion of 5648 - 148 Street)

3. This By-law may be cited for all purposes as "Portion of lane at Highway No. 10 and 148 Street Road Exchange By-law, 2002, No. 14856".

PASSED THREE READINGS on the 25th day of November, 2002.

NOTICE OF INTENTION

ADVERTISED on the 30th day of November and on the 7th day of December, 2002, in the NOW Community newspaper.

RECONSIDERED AND FINALLY ADOPTED, signed by the Mayor and Clerk, and sealed with the Corporate Seal on the 9th day of December, 2002.

\_\_\_\_\_MAYOR

\_\_\_\_\_CLERK

**Reference Plan To Accompany City of Surrey Road Exchange  
Bylaw No. 1485 For A Portion Of Sec 10 Tp 2 NWD**  
Pursuant To Section 525(3) Of The Local Government Act  
B.C.G.S. 92C.016  
This Plan Lies Within The Greater Vancouver Regional District

Plan BCP

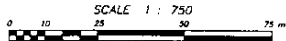

Integrated Survey Area No. 1, Surrey, NAD83 (CSRS)

This Plan Shows Ground Level Measured Distances  
Prior To Computation Of D.M. Coordinates.  
Multiply By Conversion Factor 0.9999976

**LEGEND:**

One Bearing Is Derived From Observations Between  
Control Monuments 5611 And 5620  
All Distances Are In Metres And Decimals Thereof

- ⊙ Central Monument Found
- Standard Iron Post Found
- Standard Iron Post Set

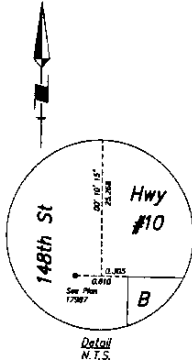

57th Avenue

8  
Plan 7092

Rem 7  
Plan 7092

Plan  
HWP876.34

148th Street

57th Avenue

37  
Plan 34233

Parcel "A"  
Plan 17987  
Area=134 m<sup>2</sup>

Parcel "C"  
Plan LMP32926  
Area=179 m<sup>2</sup>

Rem C  
Plan 17987

Parcel "B"  
Plan 17987  
Area=119 m<sup>2</sup>

B  
Plan 17987

Highway No 10

Ex Plan 19514

Deposited in the Land Title Office  
At New Westminster, B.C.  
This Day Of \_\_\_\_\_ 2002

Register

Ref. No.

Book Of Reference	
Description	Area (m <sup>2</sup> )
▨ Road To Be Cleared	
▩ Road To Be Dedicated	
A Portion of Lot C Plan 17987 Except Part Squatted By Plan 34233 Sec 10 Tp 2 NWD	134
A Portion of Lot B Plan 17987 Sec 10 Tp 2 NWD	119
A Portion of Sec 10 Tp 2 NWD Dedicated Road on Plan LMP32926	179

I, L. Ashenbald, A British Columbia Land Surveyor,  
Of Surrey, British Columbia, Certify That I Was  
Present At And Personally Supervised The Survey  
Represented By This Plan, And That The Survey and  
Plan Are Correct. The Survey Was Completed On  
The 29th Day Of October, 2002

S.G.L.S.

City of Surrey

Mayor: Douglas McCollum

City Clerk

City Name

City Name

Witness As To The Signature Of The City Clerk

Print Name

Address

Occupation

Hol & Associates

Professional Land Surveyors

Suite 111 - 12427 - 76th Avenue, Surrey, BC

Tel: 604-591-1770

Fax: 604-591-1770