

CITY OF SURREY

BYLAW NO. 21354

A Bylaw to provide for the exemption from taxation
of certain properties in the City of Surrey pursuant to
Section 220 and 224(2)(f) and (h) of the *Community Charter*
.....

WHEREAS Section 220 of the *Community Charter*, S.B.C. 2003, Chap. 26, provides statutory exemptions from taxation to certain properties;

AND WHEREAS Council may, by authority of Section 224(2)(f) and (h), exempt from taxation certain lands surrounding those properties;

AND WHEREAS Council deems it expedient to exempt from taxation the properties described in Schedule A attached hereto;

NOW, THEREFORE, the Council of the City of Surrey enacts as follows:

Title

1. This Bylaw may be cited as the "Section 220 and 224(2)(f) and (h) Tax Exemption Bylaw, 2024, No. 21354".

Exemptions

2. The lands or improvements, or portions thereof, as outlined in Schedule A attached to this Bylaw are exempt from taxation for the Year 2025 pursuant to Sections 220 and 224(2)(f) and (h) of the *Community Charter*, and subject to the conditions provided for in this Bylaw.

Conditions

3. Where:
 - (a) a transfer, sale, or lease is made of property exempt from taxation under this Bylaw to some person not entitled to such exemption; or

- (b) property used for some purpose which would entitle it to exemption under this Bylaw ceases to be so used; or
- (c) property exempt from taxation under this Bylaw ceases to meet the conditions necessary to qualify for the exemption including, but not limited to, compliance with City policies and bylaws,

the property shall be liable to taxation from the date of the transfer, sale, lease, or change of use or conditions, as the case may be (the "Taxation Date").

- 4. Where the assessment roll is completed before the transfer, sale, lease or change of use or conditions described in Section 3 of this Bylaw comes to the attention of the collector:
 - (a) the collector will provide written notice to the transferee, purchaser, lessee, or other person who, but for the exemption, would have been liable to taxation; and
 - (b) the person described in (a) shall pay to the City an amount equal to the total taxes that, but for the exemption, would have been payable on the property from the Taxation Date, together with interest compounded annually at the rate described in Section 246 of the *Community Charter*.

Repeal Section

- 5. "Section 220 and 224(2)(f) and (h) Tax Exemption Bylaw, 2023, No. 21018" is hereby repealed.

PASSED FIRST READING on the 7th day of October, 2024.

PASSED SECOND READING on the 7th day of October, 2024.

PASSED THIRD READING on the 7th day of October, 2024.

RECONSIDERED AND FINALLY ADOPTED, signed by the Mayor and Clerk and sealed with the Corporate Seal on the 21st day of October, 2024.

 _____ MAYOR

 _____ CLERK

SCHEDULE A

Section 220 and 224(2)(f) and (h) Tax Exemption Bylaw 2024, No. 21354

	PID	LEGAL	Operating Name	Legal Owner	Address	Folio No.
1.	013-210-611	North East 175 Feet by 200 Feet of Parcel "A" (Reference Plan 8680), Fractional North East Quarter Section 6, Township 2 having a frontage of 175 feet on Station Road and 200 feet on the North Boundary NWD	Al-Mustafa Academy (Canadian Hussaini Association) 220(1)(h)/224(2)(f)	Same	5441 - 125A Street	6064-97102-2
2.	012-719-625 (Lot 1) 012-719-633 (Lot 2)	Lots 1 & 2, Block 2, District Lot 52, Group 2, NWD Plan 2482	All Saints Community Church 220(1)(h)/224(2)(f)	Same	12268 Beecher Street	5700-00116-0
3.	013-198-076	Parcel "7" (Reference Plan 15046) of Parcel "A" (Explanatory Plan 1136), Section 29, Block 5 North, Range 2 West, NWD	Amazing Grace United Church 220(1)(h)/224(2)(f)	Trustees of Amazing Grace United Church Pastoral Charge and The United Church of Canada	12740 - 102 Avenue	2290-06004-5
4.	011-438-789	Lot 1 Except: The North 25 feet; Section 19, Block 5 North, Range 1 West, NWD Plan 9920 (with the exempt portion shown shaded on the map attached hereto)	Anglican Church of the Epiphany 220(1)(h)/224(2)(f)	Synod of the Diocese of New West	10553 - 148 Street	1190-00012-X
5.	010-115-803	Lot F, Section 14, Block 5 North, Range 2 West, NWD Plan 15734	Association of Islamic Charitable Projects 220(1)(h)/224(2)(f)	Same	13630 Grosvenor Road	2140-95002-1

	PID	LEGAL	Operating Name	Legal Owner	Address	Folio No.
6.	025-422-359	Lot 1, Section 19, Township 2, NWD Plan LMP54053	B.C. Muslim Association (Surrey Mosque) 220(1)(h)/224(2)(f)	Same	12407 – 72 Avenue	6191-00033-9
7.	024-823-503	Parcel 1, Section 8, Township 2, NWD Plan LMP46747 (with the exempt portion shown shaded on the map attached hereto)	B.C. Muslim Association Mosque 220(1)(h)/224(2)(f)	Same	13585 – 62 Avenue	6084-00070-8
8.	018-336-400	Lot 6, Section 8, Township 2, NWD Plan LMP11223 (with the exempt portion shown shaded on the map attached hereto)	Berea Baptist Church 220(1)(h)/224(2)(f)	Same	6062 – 132 Street	6084-05021-9
9.	001-095-111	Lot 1, Section 23, Block 5 North, Range 1 West, NWD Plan 68978	Calvary Christian Church 220(1)(h)/224(2)(f)	Same	16293 – 104 Avenue	1230-00011-2
10.	027-107-248	Lot 1 Section 28 Township 2, NWD Plan BCP 30823 (except that 2,900 sq. ft portion used as a residence)	Canadian Ramgarhia Society 220(1)(h)/224 (2)(f)	Same	8365 – 140 Street	6282-00016-6
11.	006-222-641	Lot 118, Section 7, Township 8, NWD Plan 48116	Canadian Reformed Church of Cloverdale 220(1)(h)/224(2)(f)	Trustees of the Congregation of the Canadian Reformed Church	17473 - 60 Avenue	8074-76702-4
12.	002-833-778	Lot 283, Section 30, Block 5 North, Range 1 West, NWD Plan 61636	Cedar Grove Baptist Church 220(1)(h)/224(2)(f)	Same	10330 – 144 Street	1300-89934-7

	PID	LEGAL	Operating Name	Legal Owner	Address	Folio No.
13.	010-429-336	Lot "A", Section 31, Block 5 North, Range 2 West, NWD Plan 18742	Cedar Hills Pentecostal Lighthouse Church 220(1)(h)/224(2)(f)	Same	12256 - 98 Avenue	2310-90031-X
14.	015-253-872	Lot 18, Section 12, Township 2, NWD Plan 1752	Christ Church Anglican Cemetery 220(1)(g)/224(2)(f)	The Synod of the Diocese of New Westminster	16591 Bell Road	6121-17002-5
15.	015-510-026	Lot 1, Section 12, Township 2, NWD Plan 83959	Christ Church Surrey Centre 220(1)(h)/224(2)(f)	The Synod of the Diocese of New Westminster	16631 Old McLellan Road	6121-00009-0
16.	029-968-992	Air Space Parcel 1, Section 27, Block 5 North, Range 2 West, NWD Plan EPP61077	Christ the King Lutheran Church 220(1)(h)/224(2)(f)	Same	13388 - 104 Avenue	2270-00065-1
17.	031-667-554	Lot 7, Section 12, Township 2, NWD Plan EPP113198	Christ the Redeemer Anglican Church 220(1)(h)/224(2)(f)	Parish of Christ the Redeemer	16628 Old McLellan Road	6121-06012-8
18.	026-317-371	Lot A, Section 30, Township 8, NWD Plan BCP18068 (with the exempt portion shown shaded on the map attached hereto)	Christ Worship Centre 220(1)(h)/224(2)(f)	Same	17171 - 80 Avenue	8302-90008-4
19.	029-971-179	Lot 1 Section 9 Township 8 NWD Plan EPP65319 (with the exempt portion shown shaded on the map attached hereto)	Christians' Gospel Society 220(1)(h)/224(2)(f)	Same	18780 - 58 Avenue	8092-00057-8

	PID	LEGAL	Operating Name	Legal Owner	Address	Folio No.
20.	009-021-795	Lot 24, Section 34, Township 2, NWD Plan 29430	Church of Christ 220(1)(h)/224(2)(f)	Same	15048 – 92 Avenue	6341-23002-3
21.	005-834-228	Lot 61, Section 25, Block 5 North, Range 2 West, NWD Plan 40870	Church of Jesus Christ of Latter Day Saints 220(1)(h)/224(2)(f)	President of the Lethbridge Stake of the Church of Jesus Christ of Latter- day Saints	10122 – 140 Street	2250-55002-5
22.	012-463-515	Lot "B" (S110393), Block 7, Section 14, Township 1, NWD Plan 2015	Church of Jesus Christ of Latter Day Saints 220(1)(h)/224(2)(f)	President of the Lethbridge Stake of the Church of Jesus Christ of Latter- day Saints	15450 – 20 Avenue	5142-91006-0
23.	012-695-726	Lot 21 Except: South 33 Feet, Section 7, Township 2, NWD Plan 2378	Church of Jesus Christ of Latter Day Saints 220(1)(h)/224(2)(f)	President of the Lethbridge Stake of the Church of Jesus Christ of Latter- day Saints	6270 – 126 Street	6074-20002-6
24.	009-384-235 009-384-260	Lot 3 and 4, Section 8, Township 8, Plan 10742	Church of Pentecost Canada Inc. 220(1)(h)/224(2)(f)	Same	5814-176A Street	8082-02029-5
25.	023-642-467	Lot 1, Section 28, Block 5 North, Range 2 West, NWD Plan LMP31197	City Centre Church 220(1)(h)/224(2)(f)	Trustees of the Congregation of City Centre Church of the Presbyterian Church in Canada	13062 – 104 Avenue	2280-00056-8
26.	006-127-444	Lot 12, Section 16, Township 8, NWD Plan 59668 Except Plan BCP 48838	Cloverdale Baptist Church 220(1)(h)/224(2)(f)	Same	18685 – 64 Avenue	8162-11002-1

	PID	LEGAL	Operating Name	Legal Owner	Address	Folio No.
27.	009-164-286	Parcel One, Section 9, Township 8, NWD Reference Plan 76388	Cloverdale Bibleway Church & Christian Academy 220(1)(h)/224(2)(f)	Same	18603 – 60 Avenue	8093-00012-4
28.	005-367-123	Lot 77, Section 7, Township 8, NWD Plan 55563	Cloverdale Pastoral Charge (formerly Cloverdale United Church) 220(1)(h)/224(2)(f)	Trustees of the Congregation of the United Church of Canada	17575 – 58A Avenue	8071-63002-0
29.	024-263-036	Lot 1, Section 18, Township 7, NWD Plan LMP39629 (with the exempt portion shown shaded on the map attached hereto)	Emmanuel Evangelical Covenant Church 220(1)(h)/224(2)(f)	Same	17029 – 16 Avenue	7189-00012-4
30.	000-774-201 000-774-197 001-338-323	Lot 101, Section 15, Range 2 West, NWD Plan 48381 Lot 100, Section 15, Block 5 North Range 2 West, NWD Plan 48381 Lot 4, Section 15, Block 5 North Range 2 West, NWD Plan 12404	Emmanuel Romanian Pentecostal Church 220(1)(h)/224(2)(f)	Same	13575 King George Boulevard 13585 & 13591 Binnie Lane (parking lots)	2150-75004-1 2150-74504-5 2150-03028-7
31.	023-304-880	Lot 11, Section 18, Township 2, NWD Plan LMP26603	Faith Evangelical Lutheran Church 220(1)(h)/224(2)(f)	Same	7086 – 124 Street	6184-10012-9
32.	011-359-382	Lot 1, Section 17, Range 2 West, NWD Plan 8343 except Explanatory Plan 10527	Fatima Education Association 220(1)(h)/224(2)(f)	Fatimia Community Services Society of BC	10922 Scott Road	2170-00018-5

	PID	LEGAL	Operating Name	Legal Owner	Address	Folio No.
33.	002-712-342	Lot 2, Section 17, Block 5 North, Range 2 West NWD Plan 8343	Fatima Education Association 220(1)(h)/224(2)(f)	Fatimia Community Services Society of BC	10906 Larson Road	2170-01022-1
34.	001-731-688	Parcel A, (Explanatory Plan 10527) Lot 1, Section 17, Block 5 North, Range 2 West, NWD Plan 8343	Fatima Education Association 220(1)(h)/224(2)(f)	Fatimia Community Services Society of BC	10926 Scott Road	2170-90005-6
35.	024-880-001	Lot A Section 35 Township 2 NWD Plan LMP46216	Fleetwood Christian Reformed Church 220(1)(h)/224(2)(f)	Same	9165 – 160 Street	6351-90018-9
36.	010-764-615	Lot 4, Section 26, Township 2, NWD Plan 2824	Fleetwood Gospel Hall 220(1)(h)/224(2)(f)	The Trustees of the Congregation of the Fleetwood Gospel Hall	8725 – 158 Street	6264-03002-8
37.	031-692-257	Lot 1, Section 25, Township 2, NWD Plan LMP20904 (with the exempt portion shown shaded on the map attached hereto)	Fleetwood International Church 220(1)(h)/224(2)(f)	Same	8250 – 161 Street	6252-00069-3
38.	001-857-789	Lot "B", Except Part Subdivided By Plan LMP 918, Section 9 Township 8 NWD Plan 17590 (with the exempt portion shown shaded on the map attached hereto)	Free Presbyterian Church in Cloverdale 220(1)(h)/224(2)(f)	Same	18790 – 58 Avenue	8092-91011-X
39.	004-915-291	Lot 127, Section 21, Block 5 North, Range 2 West, NWD Plan 51205 (with the exempt portion shown shaded on the map attached hereto)	Gateway Baptist Church 220(1)(h)/224(2)(f)	Same	13175 – 107 Avenue	2210-77602-8

	PID	LEGAL	Operating Name	Legal Owner	Address	Folio No.
40.	013-974-734	Lot 1 Except: Part dedicated Road on Reference Plan NWP88383, Section 35, Block 5 North, Range 2 West, NWD Plan 81072	Grace Hanin Community Church 220(1)(h)/224(2)(f)	Same	9770 King George Boulevard	2350-00040-0
41.	017-456-843	Parcel A, District Lot 165, Group 2, NWD Reference Plan LMP1474	Gracepoint Community Church 220(1)(h)/224(2)(f)	BC Conference of Mennonite Brethren Churches	3487 King George Boulevard	5700-90009-9
42.	006-156-444	Lot 26, Section 26, Township 2, NWD Plan 47194 (with the exempt portion shown shaded on the map attached hereto)	Greater Vancouver Assembly Hall of Jehovah's Witnesses 220(1)(h)/224(2)(f)	Same	15577 - 82 Avenue	6262-25002-5
43.	009-102-205	Lot C Except: Parcel "One" (Bylaw Plan 53423); Section 33, Block 5 North, Range 2 West, NWD Plan 22344	Greek Orthodox Community of Surrey and Fraser Valley 220(1)(h)/224(2)(f)	Same	13181 - 96 Avenue	2331-92002-3
44.	009-102-175	Lot B, Section 33, Block 5 North, Range 2 West, NWD Plan 22344 (with the exempt portion shown shaded on the map attached hereto)	Greek Orthodox Community of Surrey and Fraser Valley 220(1)(h)/224(2)(f)	Same	9635 - 132 Street	2331-91002-9
45.	018-416-179	Lot 1, Section 33, Township 2, NWD Plan LMP12024 (with the exempt portion shown shaded on the map attached hereto)	Green Timbers Covenant Church 220(1)(h)/224(2)(f)	Same	14219 - 88 Avenue	6331-00016-1

	PID	LEGAL	Operating Name	Legal Owner	Address	Folio No.
46.	030-252-393	Lot 1, Section 28, Township 2, NWD Plan EPP 60714 (with the exempt portion shown shaded on the map attached hereto)	Gurdwara Nanaksar Satsang Sabha Society 220(1)(h)/224(2)(f)	Same	14212 – 88 Avenue	6284-00046-7
47.	018-339-361	Lot A, Section 18, Township 2, NWD, Plan LMP11269 (with the exempt portion shown shaded on the map attached hereto)	Guru Nanak Sikh Temple 220(1)(h)/224(2)(f)	Guru Nanak Sikh Gurdwara Society	7050 – 120 Street	6183-90019-9
48.	012-531-847	Lot "J" (U37030), Blocks 42 and 43, Except: Parcel "One" (Bylaw Plan 64766), Section 8, Township 8, NWD Plan 2107 (with the exempt portion shown shaded on the map attached hereto)	Hillside Christian Church 220(1)(h)&(l)/224(2)(f)&(h)	Hillside Christian Church & Surrey Christian School Society	5950 – 179 Street	8082-95402-4
49.	002-826-321	Lot 4, Section 19, Township 2 NWD Plan 17466	Holy Satsang Foundation 220(1)(h)/224(2)(f)	Same	7975 –123A Street	6193-03008-6
50.	023-315-199	Section 19 Township 2 Plan Ref LMP 2678 NWD Parcel A Plan Ref LMP 26788 Previously Lots 1 and 2 PL 13889 (except that 480 sq. ft. used as a caretaker residence)	Holy Satsang Foundation 220(1)(h)/224(2)(f)	Same	7990 –123A Street	6193-90006-8
51.	029-174-261	Lot 2, Section 16, Township 8, Plan EPP30745, NWD	Hope Community Church 220(1)(h)/224(2)(f)	Hope Community Church of Surrey BC	18625 Fraser Highway	8163-01023-X

	PID	LEGAL	Operating Name	Legal Owner	Address	Folio No.
52.	003-437-256	Lot "A" (W23431), Except: Part Dedicated Road on Plan BCP1285, Section 15, Township 2, NWD Plan 64193 (with the exempt portion shown shaded on the map attached hereto)	Iglesia Ni Cristo (Church of Christ) 220(1)(h)/224(2)(f)	Same	15145 – 68 Avenue	6154-90005-3
53.	011-236-337	Parcel "A" (Explanatory Plan 12335) Lot 1, Section 15, Township 8 NWD Plan 7371 Except Plan LMP1427 and Plan BCP45376	Jericho Ridge Community Church 220(1)(h)/224(2)(f)	The BC Conference of the Mennonite Brethren Churches	19533 – 64 Avenue	8152-90017-5
54.	010-087-117	Parcel "4" (Reference Plan 16904), Lots 2 and 3, Section 28, Block 5 North, Range 2 West, NWD Plan 15418	Jesus Christ, The Name Above Every Name Inc. 220(1)(h)/224(2)(f)	The Kingdom of Jesus Christ, The Name Above Every Name Inc.	13055 Old Yale Road	2280-03022-6
55.	011-278-901	West 231 feet Lot 3, Except: Parcel "L" (By-law Plan 39734); Section 33, Block 5 North, Range 1 West, NWD Plan 8137	Johnston Heights Evangelical Free Church 220(1)(h)/224(2)(f)	Same	9612 – 152 Street	1330-02004-2
56.	000-709-760	Lot 3 Except: Firstly: West 231 feet, Secondly: Parcel "V" (By-law Plan 39734) and Thirdly: Parcel "A" (By-law Plan 68239), Section 33, Block 5 North, Range 1 West, NWD Plan 8137	Johnston Heights Evangelical Free Church 220 (1)(h)/224(2)(f)	Same	15245 – 96 Avenue	1330-02006-6
57.	019-184-697	Lot 4, Section 6, Township 9, NWD Plan LMP 22110 (with the exempt portion shown shaded on the map attached hereto)	Korean Central Presbyterian Church 220(1)(h)/224(2)(f)	Same	10110 – 175A Street	9064-03003-0

	PID	LEGAL	Operating Name	Legal Owner	Address	Folio No.
58.	011-131-471	Lot "A" Except: Firstly: Parcel "One" (By-law Plan 50571); Secondly: Part on SRW Plan 28411, Thirdly: Part on Plan BCP30270, Block 16, Section 22, Block 5 North, Range 1 West, NWD Plan 4704 (with the exempt portion shown shaded on the map attached hereto)	Kwanglim Methodist Church in Canada 220(1)(h)/224(2)(f)	Same	15688 – 106A Avenue 15678 – 106A Avenue	1220-90012-6
59.	010-508-317	Lot 21, Section 31, Township 8, NWD Plan 19576 (with the exempt portion shown shaded on the map attached hereto)	Lam Ti Ni (Lumbini) Buddhist Temple 220(1)(h)/224(2)(f)	Same	16837 - 94A Avenue	8313-20002-9
60.	029-545-242	Lot 1, Section 36, Township 2, NWD Plan EPP 47259 (with the exempt portion shown shaded on the map attached hereto)	Legacy - A Church of the Nazarene 220(1)(h)/224(2)(f)	Same	9012 – 160 Street	6362-00039-0
61.	004-951-131	Lot 134, Except: Part Subdivided by Plan 40698, Section 31, Block 5 North, Range 2 West, NWD Plan 40170	Living Hope Christian Fellowship 220(1)(h)/224(2)(f)	Conference of United Mennonite Churches of BC	12265 – 99A Avenue	2310-78303-1
62.	005-289-513	Lot 159, Section 31, Block 5 North, Range 2 West, NWD Plan 54987	Living Hope Christian Fellowship 220(1)(h)/224(2)(f)	Mennonite Church BC	12246 – 100 Avenue	2310-80802-7
63.	009-735-151	Lot 99 Except Parcel "Q" (Bylaw Plan 76106), Section 22, Block 5 North, Range 2 West, NWD Plan 12661 (except for that 500 sq. ft. portion of the building used as living quarters)	Manawmaya Theravada Buddhist Society Inc. 220(1)(h)/224(2)(f)	Same	13260 – 108 Avenue	2220-74002-X

	PID	LEGAL	Operating Name	Legal Owner	Address	Folio No.
64.	018-698-727	Lot 4, Section 31, Township 2, NWD Plan LMP15632	Maranatha Canadian Reformed Church 220(1)(h)/224(2)(f)	Same	12300 – 92 Avenue	6312-03009-X
65.	011-041-765	Lot 17, Section 34, Block 5 North, Range 2 West, NWD Plan 6707	Masjid Al Noor "Mosque of Lights" 220(1)(h)/224(2)(f)	Same	13526 – 98A Avenue	2340-16002-9
66.	018-895-557	Lot 1, Section 15, Township 1, NWD Plan LMP18340	Mount Olive Lutheran Church 220(1)(h)/ 224(2)(f)	Same	2350 – 148 Street	5150-00024-3
67.	003-102-963	Lot "B", NWD Plan 12508	Muslim Education & Welfare Foundation of Canada 220(1)(h)/224(2)(f)	Same	14136 Grosvenor Road	4000-91026-7
68.	017-136-733	Lot 7, Section 32, Township 2, NWD Plan NWP88116	New Life Ministries 220(1)(h)/224(2)(f)	Pentecostal Assemblies of Canada	8868 – 128 Street	6322-06003-X
69.	008-605-343	Lot 3, Section 15, Block 5 North, Range 2 West, NWD Plan 9938, (except that 1,000 sq. ft. portion of the building used as living quarters)	Nichiren Shoshu Temple 220(1)(h)/224(2)(f)	Same	13579 Bentley Road	2150-02024-5
70.	003-743-241	Lot 1, Section 32, Township 2, NWD Plan 66067	North Surrey Christian Assembly Society (formerly North Surrey Gospel Chapel) 220(1)(h)/224(2)(f)	Same	13044 - 96 Avenue	6323-00013-1

	PID	LEGAL	Operating Name	Legal Owner	Address	Folio No.
71.	023-868-562	Lot 1, Section 35, Township 2, NWD Plan LMP34541 (with the exempt portion shown shaded on the map attached hereto)	Northwood United Church 220(1)(h)/224(2)(f)	The United Church of Canada	8855 – 156 Street	6359-00025-8
72.	009-254-218	Lot 4 Except: Firstly; Part dedicated road on Plan LMP23777 Secondly; Part subdivided by Plan LMP32059, Section 28, Township 2, NWD Plan 10208 (with the exempt portion shown shaded on the map attached hereto)	Nova Church (formerly Bear Creek Community Church) 220(1)(h)/224(2)(f)	Northwest Canada Conference Evangelical Church	8383 – 140 Street	6282-03009-2
73.	005-654-467	Lot 15, Section 15, Township 1, NWD Plan 58404 (with the exempt portion shown shaded on the map attached hereto)	Ocean Park Congregation of Jehovah's Witnesses 220(1)(h)/224(2)(f)	Same	14832 – 24 Avenue	5150-14004-1
74.	023-859-768	Lot 1, Section 23, Block 5 North, Range 2 West, NWD Plan LMP34549 (with the exempt portion shown shaded on the map attached hereto)	Our Lady of Good Counsel Church and School 220(1)(h)(l)/224(2)(f)	Roman Catholic Archbishop of Vancouver	10460 – 139 Street	2237-00026-8
75.	001-983-521	Lot 9, Except: Part Subdivided by Plan 70047; Section 5, Township 8, NWD Plan 10274	Pacific Community Church 220(1)(h)/224(2)(f)	Christian Missionary Alliance – Canadian Pacific District – Pacific Community Church	5337 – 180 Street	8053-08001-7
76.	009-306-056	Lot 6, Section 17, Township 1, NWD Plan 23154 (with the exempt portion shown shaded on the map attached hereto)	Parish of St. Mark - Ocean Park 220(1)(h)/224(2)(f)	Same	12953 – 20 Avenue	5173-04010-5

	PID	LEGAL	Operating Name	Legal Owner	Address	Folio No.
77.	023-265-281	Lot 1, Section 22, Township 1, NWD Plan LMP26024, Except Part in Plan BCP31762	Peace Portal Alliance Church 220(1)(h)/224(2)(f)	Christian and Missionary Alliance (Canadian Pacific District)	15128 - 27B Avenue	5221-00022-2
78.	007-707-100	Parcel "One", Section 19, Township 1, NWD Reference Plan 74588	Peninsula United Church 220(1)(h)/224(2)(f)	Trustees Congregation of Peninsula United Church	2756 - 127 Street	5191-00034-1
79.	023-212-004	Lot A, Section 23, Township 1, NWD Plan LMP25229, (with the exempt portion shown shaded on the map attached hereto)	Peninsula United Church 220(1)(h)/224(2)(f)	Trustees Congregation of Peninsula United Church	15639 - 24 Avenue	5230-90062-3
80.	023-440-554	Lot 1, Section 19, Block 5 North, Range 1 West, NWD Plan LMP28609	People's Full Gospel Church 220(1)(h)/224(2)(f)	Same	14456 - 104A Avenue	1190-00038-6
81.	011-294-841	North 134 Feet Lot "B" Except: Firstly: Part subdivided by Plan 40114, Secondly: Parcel 2 (Bylaw Plan 49022); Section 32, Township 2, NWD Plan 6436	Philadelphia Church of Vancouver Society 220(1)(h)/224(2)(f)	Same	9135 - 132 Street	6322-91005-X
82.	011-564-083	East 117 Feet of Lot 11, Section 33, Township 8, NWD Plan 342 (with the exempt portion shown shaded on the map attached hereto)	Port Kells Congregational Christian Church 220(1)(h)/224(2)(f)	Same	19131 - 88 Avenue	8331-10004-9
83.	005-290-911	Parcel "A", Section 7, Township 8, NWD Reference Plan 55276 (with the exempt portion shown shaded on the map attached hereto)	Precious Blood Parish 220(1)(h)/224(2)(f)	Roman Catholic Archbishop of Vancouver	17475 - 59 Avenue	8071-90036-9

	PID	LEGAL	Operating Name	Legal Owner	Address	Folio No.
84.	009-004-629	Lot 21 Except: Part Dedicated Road on Plan BCP24054, Section 15, Township 2, NWD Plan 28794 (with the exempt portion shown shaded on the map attached hereto)	Punjabi Masihi Church Society 220(1)(h)/224(2)(f)	The Pentecostal Assemblies of Canada	14488 – 72 Avenue	6153-20002-3
85.	009-492-836	Lot 16, Except: Parcel "A" (Bylaw Plan 62482); Section 14, Township 2, NWD Plan 11278, except that 1547 sq. ft. portion leased to a third party daycare provider	Relate Christian Church 220(1)(h)/224(2)(f)	Same	6788 – 152 Street	6142-15002-7
86.	009-506-837	Lot "B", Section 22, Township 2, NWD Plan 11349	Renew Church (formerly Newton Fellowship Baptist Church) 220(1)(h)/224(2)(f)	Same	7328 – 144 Street	6222-91002-6
87.	004-713-311	Lot 224, Section 15, Township 1, NWD Plan 58294	Seaview Pentecostal Assembly 220(1)(h)/224(2)(f)	Same	14633 – 16 Avenue	5152-87302-3
88.	024-355-593	Lot A Section 4 Township 8 NWD Plan LMP40501	Sonrise Full Gospel Church 220(1)(h)/224(2)(f)	Same	5588 – 188 Street	8044-90003-2
89.	002-682-915	Lot 198, Section 32, Block 5 North, Range 2 West, NWD Plan 61060	Southside Community Church 220(1)(h)/224(2)(f)	Same	12642 – 100 Avenue	2320 – 84702-9
90.	005-737-036	Lot 51 Except Part Dedicated Road on Plan LMP 47874, Section 29, Township 2, NWD Plan 59251 (with the exempt portion shown shaded on the map attached hereto)	Sri Guru Singh Sabha Gurdwara Association 220(1)(h)/224(2)(f)	Same	8135 – 132 Street	6292-50002-0

	PID	LEGAL	Operating Name	Legal Owner	Address	Folio No.
91.	005-737-061	Lot 52, Except: Part Dedicated Road on Plan LMP47874, Section 29, Township 2, NWD Plan 59251, except that 2,000 sq ft portable building and 5,000 sq ft of lands leased to a third-party preschool provider	Sri Guru Singh Sabha Gurdwara Association 220(1)(h)/224(2)(f)	Same	8115 – 132 Street	6292-50504-2
92.	002-582-732	Lot 14 Except: Firstly: Part on Statutory Right of Way Plan 28411 and Secondly, part dedicated Road on Plan LMP33786, Section 26, Block 5 North, Range 1 West, NWD Plan 1670 (with the exempt portion shown shaded on the map attached hereto)	St. Andrew Kim Catholic Parish 220(1)(h)/224(2)(f)	The Roman Catholic Archbishop of Vancouver	10222 – 161 Street	1260-13002-2
93.	018-749-666	Lot 1, Section 18, Township 2, NWD Plan LMP16349 (with the exempt portion shown shaded on the map attached hereto)	St. Andrews – Newton Presbyterian Church 220(1)(h)/224(2)(f)	Same	7147 – 124 Street	6183-00041-3
94.	005-100-364	Lot 37, Section 17, Township 2, NWD Plan 53238 (with the exempt portion shown shaded on the map attached hereto)	St. Bernadette Roman Catholic Church & School 220(1)(h)&(l)/224(2)(f)&(h)	Roman Catholic Archdiocese of Vancouver	6543 – 132 Street	6172-36002-4
95.	031-087-337	Lot A, Section 22, Township 2, NWD Plan EPP85592 (with the exempt portion shown shaded on the map attached hereto)	St. George Malankara Orthodox Church 220(1)(h)/224(2)(f)	St. George Malankara Orthodox Church BC	15151 72 Avenue	6221-90007-4
96.	023-266-635	Lot A, Section 17 and 20, Block 5 North, Range 2 West, NWD Plan LMP25593 (with the exempt portion shown shaded on the map attached hereto)	St. Helen's Anglican Church & Hall 220(1)(h)/224(2)(f)	Synod of the Diocese of New Westminster	10787 – 128 Street	2170-90015-9

	PID	LEGAL	Operating Name	Legal Owner	Address	Folio No.
97.	002-436-451	Lot 1, Section 30, Block 5 North, Range 1 West, NWD Plan 70402, (with the exempt portion shown shaded on the map attached hereto)	St. Luke Lutheran Church 220(1)(h)/224(2)(f)	Same	10167 – 148 Street	1300-00001-6
98.	028-973-755	Lot 29 Section 8 Township 2 NWD Plan BCP51638 (with the exempt portion shown shaded on the map attached hereto)	St. Michaels Anglican Church 220(1)(h)/224(2)(f)	Synod of the Diocese of New Westminster	12996 – 60 Avenue	6082-28005-2
99.	011-441-135	Lot 1, Section 28, Township 8, NWD Plan 9828 (with the exempt portion shown shaded on the map attached hereto)	St. Nicolae Romanian Orthodox Church 220(1)(h)/224(2)(f)	Same	8679 Harvie Road	8283-00004-4
100.	023-211-351	Parcel 1, Section 33, Township 8, NWD Plan LMP25295	St. Oswald's Anglican Church 220(1)(g)&(h)/224(2)(f)	The Synod of the Diocese of New Westminster	19016 – 96 Avenue	8334-00020-0
101.	001-941-607	Lot 24, Legal Subdivision 16, Section 15, Township 1, NWD Plan 69917 (with the exempt portion shown shaded on the map attached hereto)	Star of the Sea School and Good Shepherd Church 220(1)(h)&(l)/224(2)(f)&(h)	Star of the Sea Parish	15024 – 24 Avenue	5150-23001-7
102.	004-409-116	Lot 228, Except: Parcel "A" (Bylaw Plan 63717), Section 8, Township 2, NWD Plan 59712 (with the exempt portion shown shaded on the map attached hereto)	Sunshine Hills Congregation of Jehovah's Witnesses 220(1)(h)/224(2)(f)	Same	13095 – 60 Avenue	6083-87702-7
103.	030-235-987	Lot 2 Section 7 Township 2 Plan EPP73003 NWD (with the exempt portion shown shaded on the map attached hereto)	Sunshine Ridge Baptist Church 220(1)(h)/224(2)(f)	Same	6230 – 120 Street	6073-01059-X

	PID	LEGAL	Operating Name	Legal Owner	Address	Folio No.
104.	003-216-772	Lot 1, Section 32, Township 2, NWD Plan 62948 (with the exempt portion shown shaded on the map attached hereto)	Surrey Alliance Church 220(1)(h)/224(2)(f)	Same	13474 – 96 Avenue	6324-00028-X
105.	013-238-868	North 132 Feet of Parcel "B" (Reference Plan 2623) of the North West Quarter, Section 25, Township 2, NWD	Surrey Chinese Baptist Church 220(1)(h)/224(2)(f)	Same	8590 – 160 Street	6253-97108-6
106.	025-984-128	Lot 1, Section 16, NWD Plan BCP 12182	Surrey Christian Alliance Church 220(1)(h)/224(2)(f)	Christian and Missionary Alliance, Canadian Pacific District	15421 – 110 Avenue	1164-00011-1
107.	002-248-646	Lot 55, Section 7, Township 8, NWD Plan 39855 (with the exempt portion shown shaded on the map attached hereto)	Surrey Covenant Reformed Church 220(1)(h)/224(2)(f)	Same	17400 – 60 Avenue	8071-52503-0
108.	009-288-473	Lot 45, Section 26, Block 5, North Range 2 West, NWD Plan 23047	Surrey Evangelical Chinese Bible Church 220(1)(h)/224(2)(f)	Same	13912 – 104 Avenue	2260-44002-2
109.	013-239-180	Parcel "D" (Explanatory Plan 7664), South West Quarter, Section 16, Township 7, NWD	Surrey Filipino Seventh-day Adventist Church 220(1)(h)/224(2)(f)	Seventh Day Adventist Church (British Columbia Conference)	1614 – 184 Street	7162-97106-4
110.	011-432-641	Lot 23, Section 31, Block 5 North, Range 2 West, NWD Plan 9373 Except: Part Subdivided by Plan 26970 (with the exempt portion shown shaded on the map attached hereto)	Surrey Free Methodist Church 220(1)(h)/224(2)(f)	Trustees of the Congregation of the Surrey Free Methodist Church	12371 – 96 Avenue	2310-22002-4

	PID	LEGAL	Operating Name	Legal Owner	Address	Folio No.
111.	010-627-537	Lot 1, Block 9, Section 18, Block 5 North, Range 1 West, NWD Plan 1701	Surrey Grace Community Church 220(1)(h)/224(2)(f)	Same	14618 – 110 Avenue	1181-00002-6
112.	010-627-545	Lot 2, Block 9, Section 18, Block 5 North, Range 1 West, NWD Plan 1701	Surrey Grace Community Church 220(1)(h)/224(2)(f)	Same	14624 – 110 Avenue	1181-01002-0
113.	026-247-399	Lot A, Section 26, Township 2, NWD Plan BCP 16894	Surrey Korean Presbyterian Church 220(1)(h)/224(2)(f)	Same	15964 – 88 Avenue	6264-90007-2
114.	026-420-325	Lot 1, Sections 19 & 30, Township 8, NWD Plan BCP 19721,	Surrey Pentecostal Assembly 220(1)(h)/224(2)(f)	Same	16870 – 80 Avenue	8302-00030-9
115.	000-809-853	Lot 9 Except: Part Subdivided by Plan 86708; North East Quarter, Section 29, Township 2, NWD Plan 5488	Surrey Seventh-Day Adventist Church (BC Conference) 220(1)(h)/224(2)(f)	Same	8520 – 132 Street	6294-08005-8
116.	011-392-533	Parcel A (Explanatory Plan 11016) Lot 3, Section 14, Block 5 North, Range 2 West, NWD Plan 5392	Surrey Vietnamese Alliance Church 220(1)(h)/224(2)(f)	Christian & Missionary Alliance-Canadian Pacific District	13821 Grosvenor Road	2140-90004-2
117.	011-392-509	Parcel A (Explanatory Plan 13691) Lot 4, Section 14, Block 5 North, Range 2 West, NWD Plan 5392 (with the exempt portion shown shaded on the map attached hereto)	Surrey Vietnamese Alliance Church 220(1)(h)/224(2)(f)	Christian & Missionary Alliance-Canadian Pacific District	13815 Grosvenor Road	2140-90008-X

	PID	LEGAL	Operating Name	Legal Owner	Address	Folio No.
118.	002-220-440	Lot D, Section 33 Block 5 North, Range 2 West, NWD Plan 22620	The Church in Surrey 220(1)(h)/224(2)(f)	Same	9630 – 131A Street	2331-93002-8
119.	004-586-069	Lot 15, Section 27, Township 8, NWD Plan 33498 (with the exempt portion shown shaded on the map attached hereto)	Tong Do Sa Buddhist Temple Chogye Order Korea (Seu Kwang Sa Buddhist Temple Society) 220(1)(h)/224(2)(f)	Tong Do Sa Buddhist Temple Chogye Order Korea	8425 – 196 Street	8273-14002-7
120.	008-783-497	Lot 33, Section 22, Block 5 North, Range 1 West, NWD Plan 25315	Tynehead Park Congregation of Jehovah's Witnesses 220(1)(h)/224(2)(f)	Same	10446 – 157 Street	1220-32002-X
121.	011-384-417	Lot 56, Section 22, Block 5 North, Range 2 West, NWD Plan 9117 (with the exempt portion shown shaded on the map attached hereto)	Ukrainian Orthodox Church of St. Mary 220(1)(h)/224(2)(f)	The Trustees of the Whalley Congregation of the Ukrainian-Greek Orthodox Church	10765 – 135A Street	2220-52502-8
122.	009-179-011	Lot 95 Except: Firstly: Part on Reference Plan 31517 and Secondly: Parcel "G" (By-law Plan 76106), Section 22, Block 5 North, Range 2 West, NWD Plan 9117	Ukrainian Orthodox Church of St. Mary (Church Hall) 220(1)(h)/224(2)(f)	The Trustees of the Whalley Congregation of the Ukrainian-Greek Orthodox Church	13512 – 108 Avenue	2220-72006-8
123.	011-418-133 011-418-192	Lot 1, Section 15, Block 5 North, Range 2 West, NWD Plan 9187 Lot 4, Section 15, Block 5, North, Range 2 West, NWD Plan 9187	Vancouver Chinese Zion Church 220(1)(h)/224(2)(f)	Same	13551 King George Boulevard and 13546 Bentley Road (parking lot)	2154-00002-2 2150-03014-7

	PID	LEGAL	Operating Name	Legal Owner	Address	Folio No.
124.	000-643-408	Lot 27, Except Firstly: Parcel T (Bylaw Plan 68239); Secondly: Part Subdivided by Plan 83273, Section 35, Township 2, NWD Plan 31091	Vancouver Christadelphian Ecclesia 220(1)(h)/224(2)(f)	Same	15582 – 96 Avenue	6353-26022-2
125.	006-516-866	Lot 23, Block 60, NWD Plan 30581	Vancouver Life Church 220(1)(h)/224(2)(f)	Same	11565 – 142 Street	4000-22044-5
126.	000-917-346	Lot 2 Except: Part on Bylaw Plan Filed A14399; Section 25 Block 5 North Range 2 West, NWD Plan 16376	Vancouver New Life Church 220(1)(h)/224(2)(f)	Same	14370 – 104 Avenue	2250-01030-4
127.	000-917-354	Lot 3, Section 25, Block 25, Range 2 West, NWD Plan 16376	Vancouver New Life Church 220(1)(h)/224(2)(f)	Same	10370 – 143A Avenue	2250-02024-3
128.	000-904-961	Lot 6, Except: Parcel A (Bylaw Plan 68121), Section 25, Block 5, North Range 2 West, NWD Plan 16376	Vancouver New Life Church 220(1)(h)/224(2)(f)	Same	10381 – 144 Street	2250-05018-1
129.	024-581-511	Lot B, Section 28, Township 2, NWD Plan LMP43799 (with the exempt portion shown shaded on the map attached hereto)	Vedic Hindu Cultural Society of BC 220(1)(h)/224(2)(f)	Same	8321 – 140 Street	6282-91003-1
130.	025-581-511	Lot 7, Section 7, Township 8, NWD Plan BCP 3568	Westwinds Community Church 220(1)(h)/224(2)(f)	Same	6331 – 176 Street	8074-06013-5
131.	010-307-338	Lot 2, Section 16, Township 1, NWD Plan 77224	White Rock Baptist Church 220(1)(h)/224(2)(f)	Same	1657 – 140 Street	5162-01009-1

	PID	LEGAL	Operating Name	Legal Owner	Address	Folio No.
132.	009-555-595	Lot 1, Except Portions on Plan BCP 23492, Block 30, Section 15, Township 1, NWD Plan 11645, (except that 2,422 sq. ft. portion of the second floor of the building used for residential accommodation)	White Rock Seventh-Day Adventist Church 220(1)(h)/224(2)(f)	Seventh-Day Adventist Church (BC Conference)	14615 – 16 Avenue	5152-00000-3
133.	001-810-570	Strata Lot 2, Section 8, Township 8 NWD Strata Plan NW1449, Together with an Interest in the Common Property in Proportion to the Unit Entitlement of the Strata Lot as shown on Form 1	Zion Park Manor 220(1)(i)/224(2)(h)	Lutheran Senior Citizens Housing Society	5939 – 180 Street 5905 – 180 Street	8082-98701-7



The Anglican Church
of the Epiphany
Folio: 1190-00012-x
10553 148 St

Legend

- EXEMPT: 4935 Sq/m
- NOT EXEMPT: 1673 Sq/m
- Total Area: 6608 Sq/m



B.C. Muslim
Association 62 Ave
Folio: 024-823-503
13585 62 Ave

Legend

- EXEMPT: 1036 Sq/m
- NOT EXEMPT: 2599 Sq/m
- Total Area: 3635 Sq/m





Berea Baptist Church
 Folio: 6084-05021-9
 6062 132 St

Legend

- EXEMPT: 6347 Sq/m
- NOT EXEMPT: 4478 Sq/m
- Total Area: 10825 Sq/m



Christ Worship Centre
 Folio: 8302-90008-4
 17171 80 Ave

Legend

- EXEMPT: 15003 Sq/m
- NOT EXEMPT: 16552 Sq/m
- Total Area: 31555 Sq/m





Christians' Gospel Society
 Folio: 8092-00057-8
 18780 58 Ave

Legend

- EXEMPT: 1154 Sq/m
- NOT EXEMPT: 3723 Sq/m
- Total Area: 4947 Sq/m

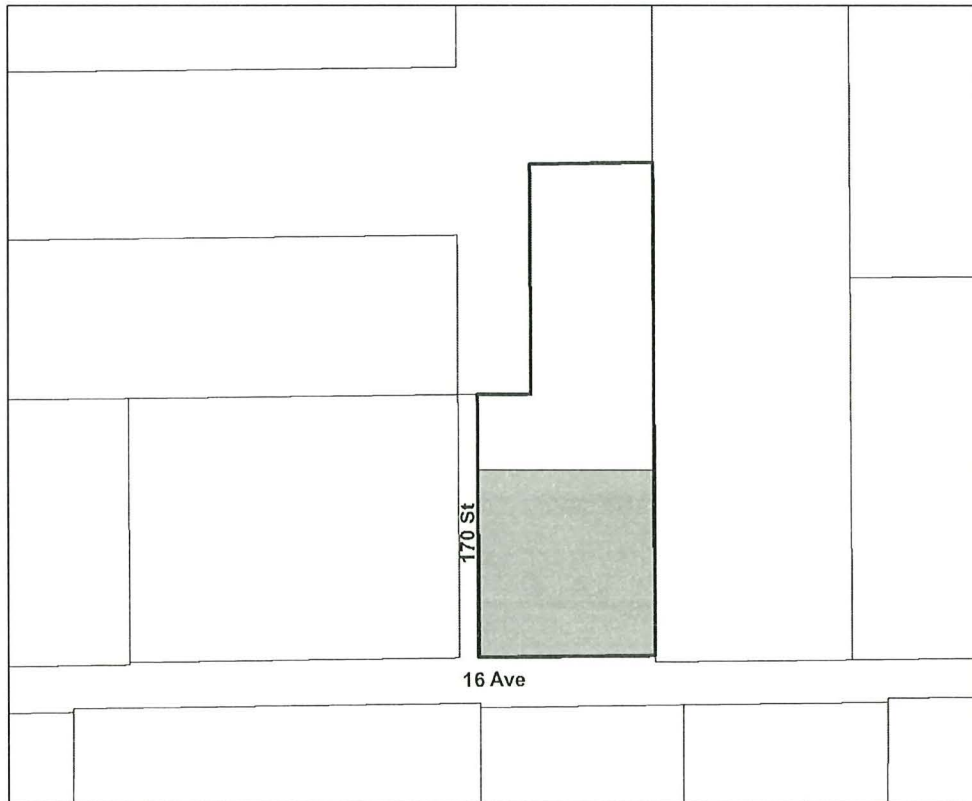

Emmanuel Evangelical Covenant Church
 Folio: 7189-00012-4
 17029 16 Ave

Legend



- EXEMPT: 8882 Sq/m
- NOT EXEMPT: 11337 Sq/m
- Total Area: 20219 Sq/m

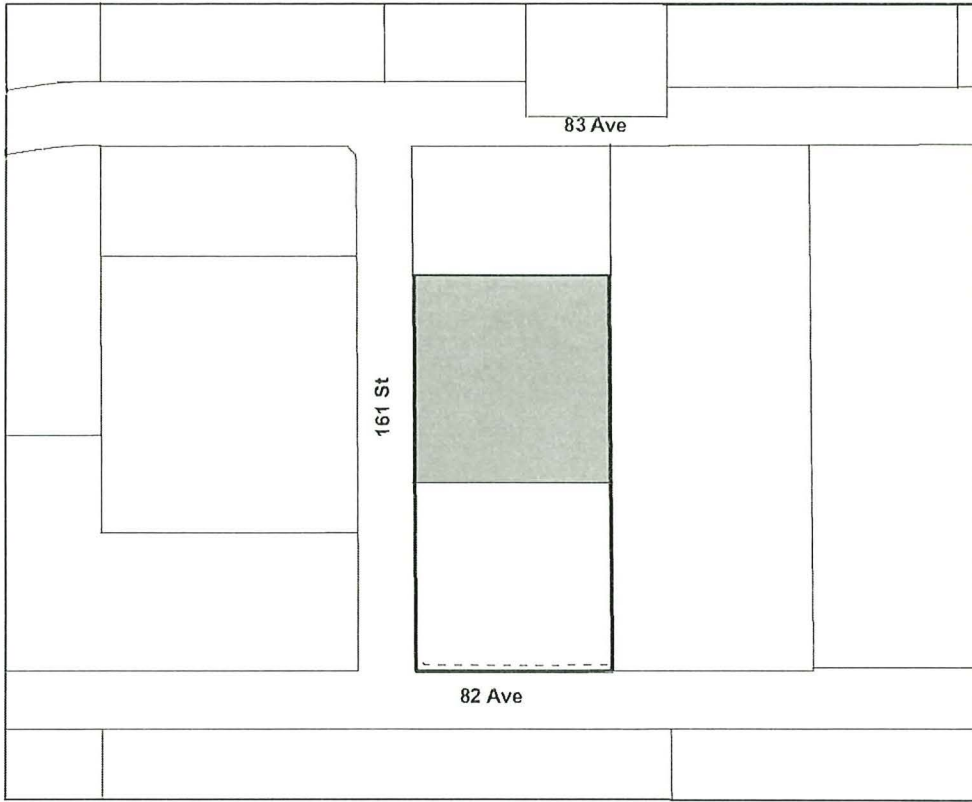



Fleetwood International Church
 Folio: 6252-00043-7
 8250 161 St



Legend

-  EXEMPT: 4887 Sq/m
-  NOT EXEMPT: 4199 Sq/m
-  Total Area: 9086 Sq/m



Free Presbyterian Church
 Folio: 8092-91011-X
 18790 58 Ave

Legend

-  EXEMPT: 3483 Sq/m
-  NOT EXEMPT: 1762 Sq/m
-  Total Area: 5245 Sq/m



Gateway Baptist Church
Folio: 2210-77602-8
13175 107 Ave



Legend

- EXEMPT: 4287 Sq/m
- NOT EXEMPT: 2777 Sq/m
- Total Area: 7064 Sq/m



Greater Vancouver
Assembly Hall of
Jehovah's Witnesses
Folio: 6262-25002-5
15577 82 Ave

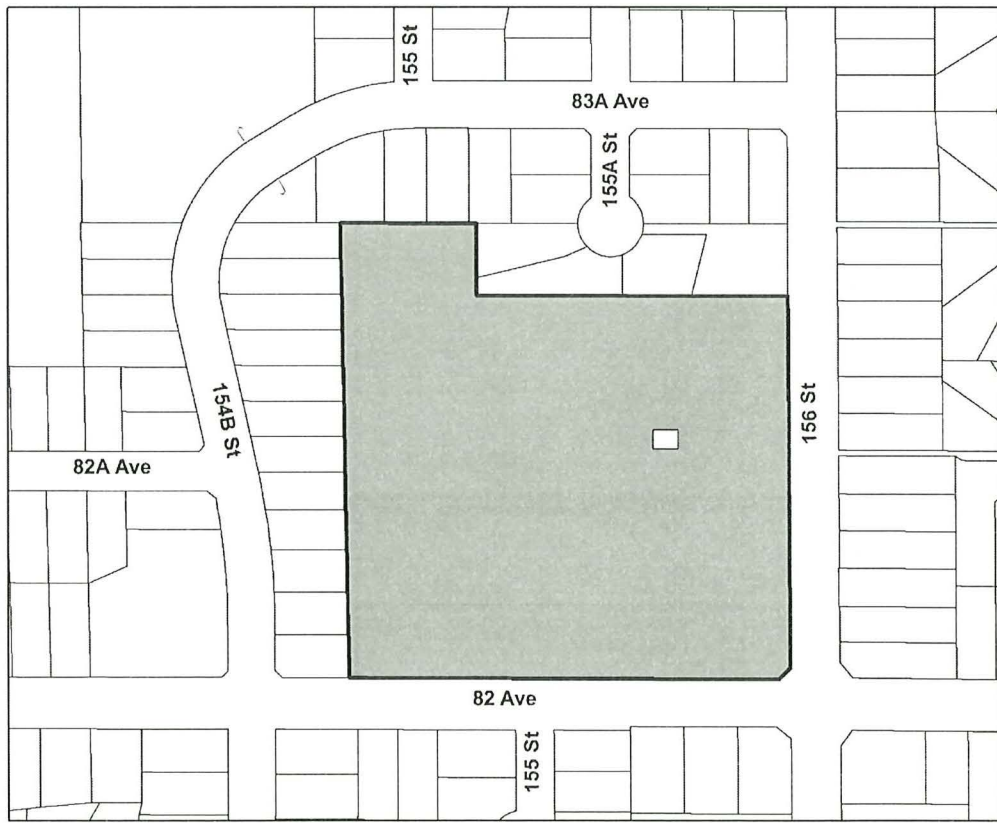

Legend

- EXEMPT: 32190 Sq/m
- NOT EXEMPT: 87 Sq/m
- Total Area: 32277 Sq/m





Greek Orthodox
Community of Surrey &
Fraser Valley
Folio: 2331-91002-9
9635 132 St

Legend

- EXEMPT: 585 Sq/m
- NOT EXEMPT: 163 Sq/m
- Total Area: 747 Sq/m



Green Timbers
Covenant Church
Folio: 6331-00016-1
14219 88 Ave

Legend



- EXEMPT: 7551 Sq/m
- NOT EXEMPT: 729 Sq/m
- Total Area: 8280 Sq/m

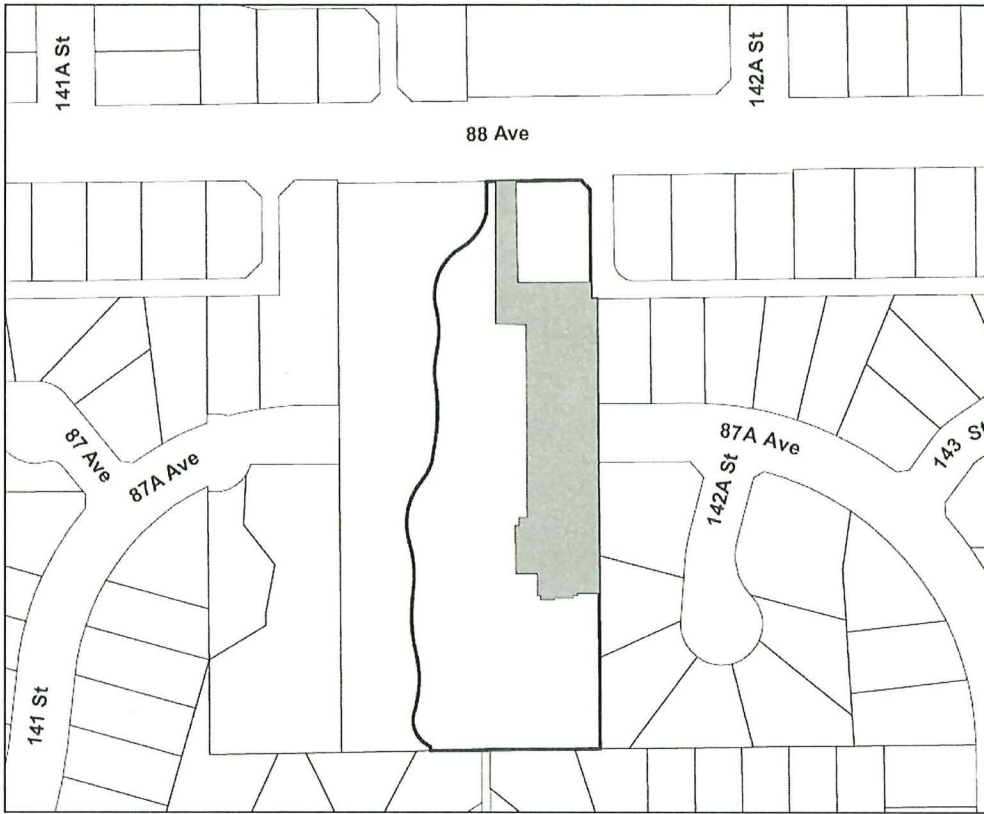



Gurdwara Nanaksar
 Satsang Sabha Society
 Folio: 6284-00046-7
 14212 88 Ave

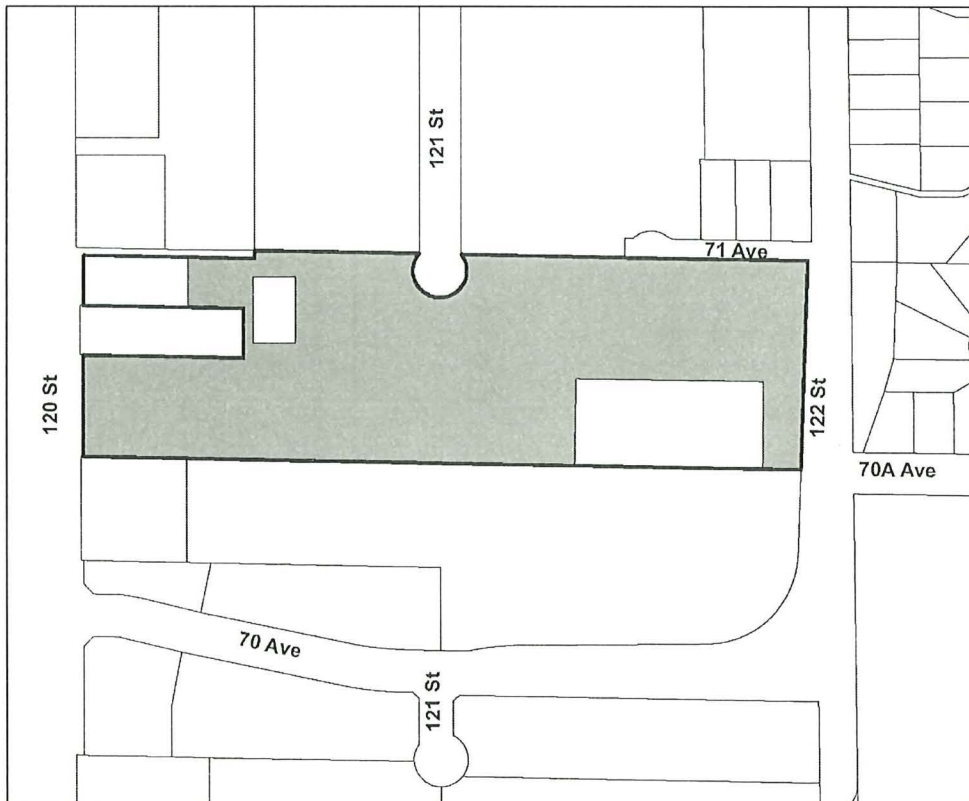

Legend

-  EXEMPT: 2877 Sq/m
-  NOT EXEMPT: 7913 Sq/m and 186 Sq/m Manse
-  Total Area: 10976 Sq/m



Guru Nanak Sikh Temple
 Folio: 6183-90019-9
 7050 120 St

Legend

-  EXEMPT: 30992 Sq/m
-  NOT EXEMPT: 6558 Sq/m
-  Total Area: 37550 Sq/m





Hillside Christian Church
 Folio: 8082-95402-4
 5950 179 St

Legend

- EXEMPT: 14555 Sq/m
- NOT EXEMPT: 5065 Sq/m
- Total Area: 19620 Sq/m



Iglesia Ni Cristo -
 Church of Christ
 Folio: 6154-90005-3
 15145 68 Ave

Legend

- EXEMPT: 6076 Sq/m
- NOT EXEMPT: 2336 Sq/m
- Total Area: 8412 Sq/m





Korean Central
Presbyterian Church
Folio: 9064-03003-0
10110 175A St

Legend

- EXEMPT: 10640 Sq/m
- NOT EXEMPT: 241 Sq/m
- Total Area: 10881 Sq/m



Kwanglim Methodist
Church of Canada
Folio: 1220-90012-6
15688 106A Ave



Legend

- EXEMPT: 10843 Sq/m
- NOT EXEMPT: 1088 Sq/m
- Total Area: 11931 Sq/m



Lam Ti Ni
Buddhist Temple
Folio: 8313-20002-9
16837 94A Ave



Legend

-  EXEMPT: 4092 Sq/m
-  NOT EXEMPT: 92 Sq/m
-  Total Area: 4184 Sq/m



Legacy - A Church
of the Nazarene
Folio: 6362-00039-0
9012 160 St

Legend



-  EXEMPT: 7959 Sq/m
-  NOT EXEMPT: 2540 Sq/m
-  Total Area: 10499 Sq/m





Northwood
 Congregation
 of the United Church
 Folio: 6359-00025-8-00
 8855 156 St

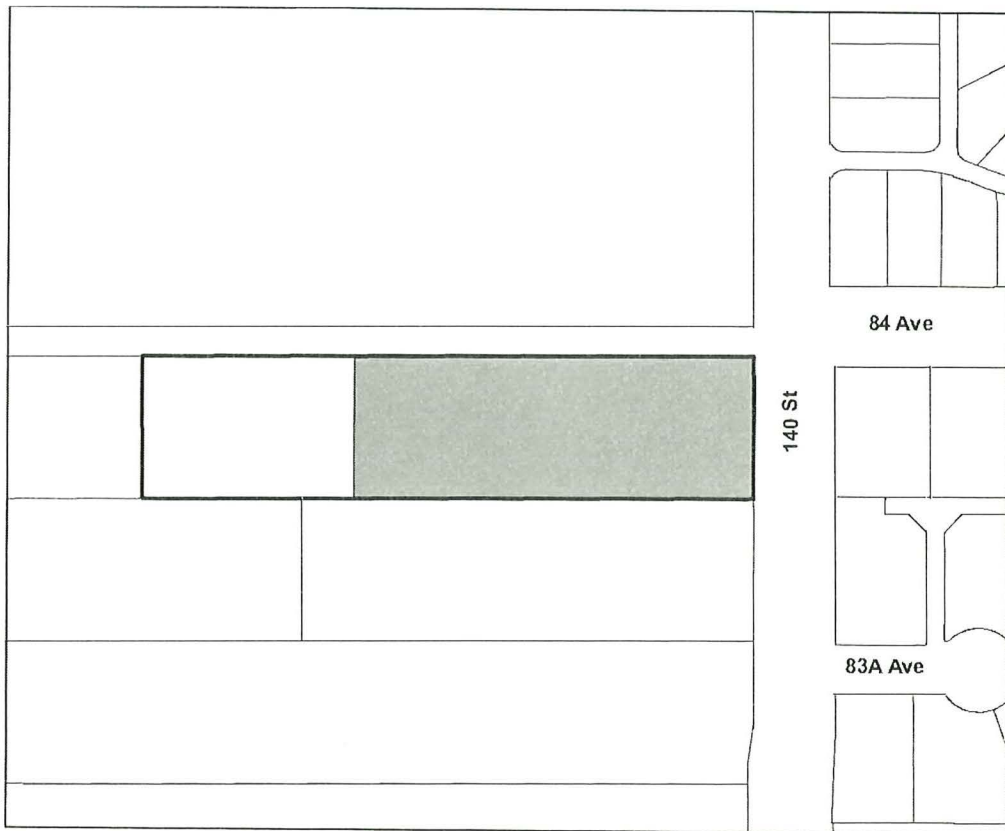

Legend

-  EXEMPT: 7568 Sq/m
-  NOT EXEMPT: 4084 Sq/m
-  Total Area: 11672 Sq/m



Nova Church
 Folio: 6282-03009-2
 8383 140 St

Legend

-  EXEMPT: 6415 Sq/m
-  NOT EXEMPT: 3395 Sq/m
-  Total Area: 9809 Sq/m



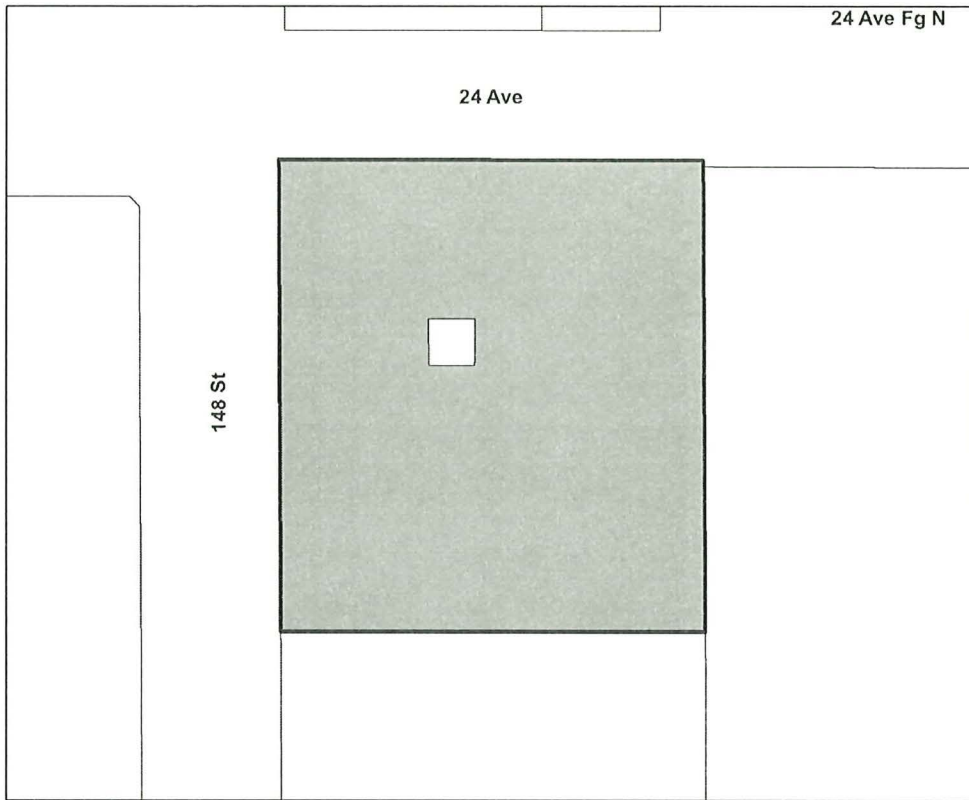

Ocean Park
 Congregation of
 Jehovah's Witnesses
 Folio: 5150-14004-1
 14832 24 Ave

Legend

- EXEMPT: 8608 Sq/m
- NOT EXEMPT: 93 Sq/m
- Total Area: 8701 Sq/m



Our Lady of Good
 Counsel Church
 Folio: 2237-00026-8
 10460 139 St

Legend

- EXEMPT: 26735 Sq/m
- NOT EXEMPT: 1418 Sq/m
- Total Area: 28153 Sq/m



Parish of St. Mark -
Ocean Park
Folio: 5173-04010-5
12953 20 Ave

Legend

- EXEMPT. 7113 Sq/m
- NOT EXEMPT. 7134 Sq/m
- Total Area: 14247 Sq/m

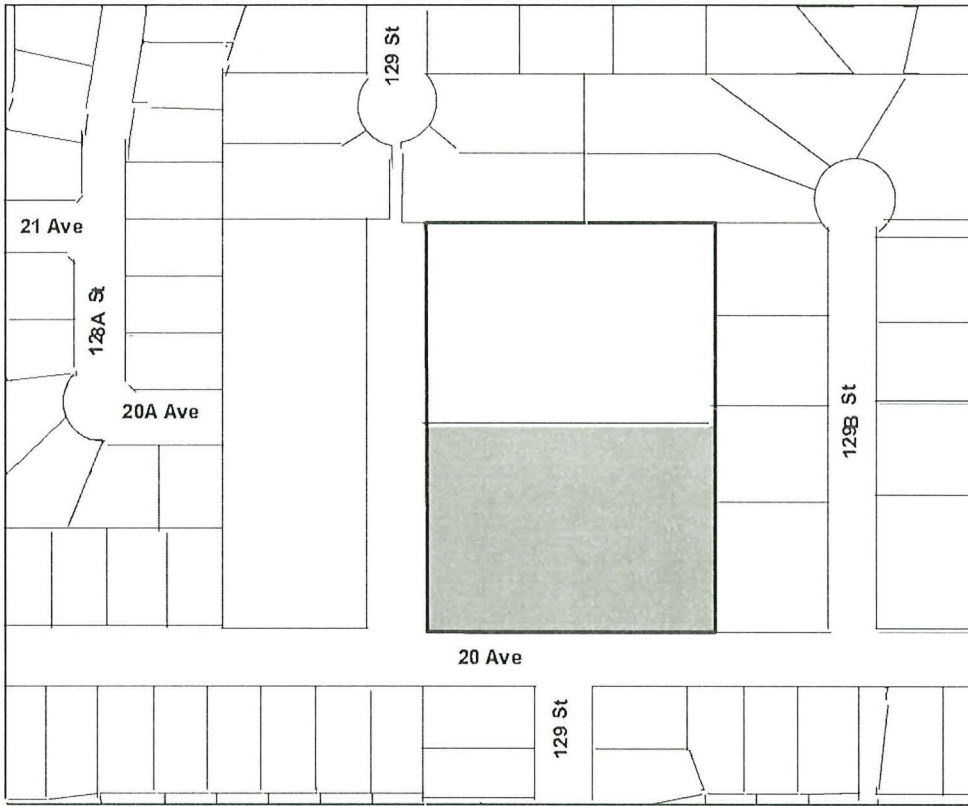

Peninsula United
Church
Folio: 5230-90062-3
15639 24 Ave

Legend

- EXEMPT. 4487 Sq/m
- NOT EXEMPT. 666 Sq/m
- Total Area: 5153 Sq/m





Punjabi Masihi Chruch
Folio: 6153-20002-3
14488 72 Ave

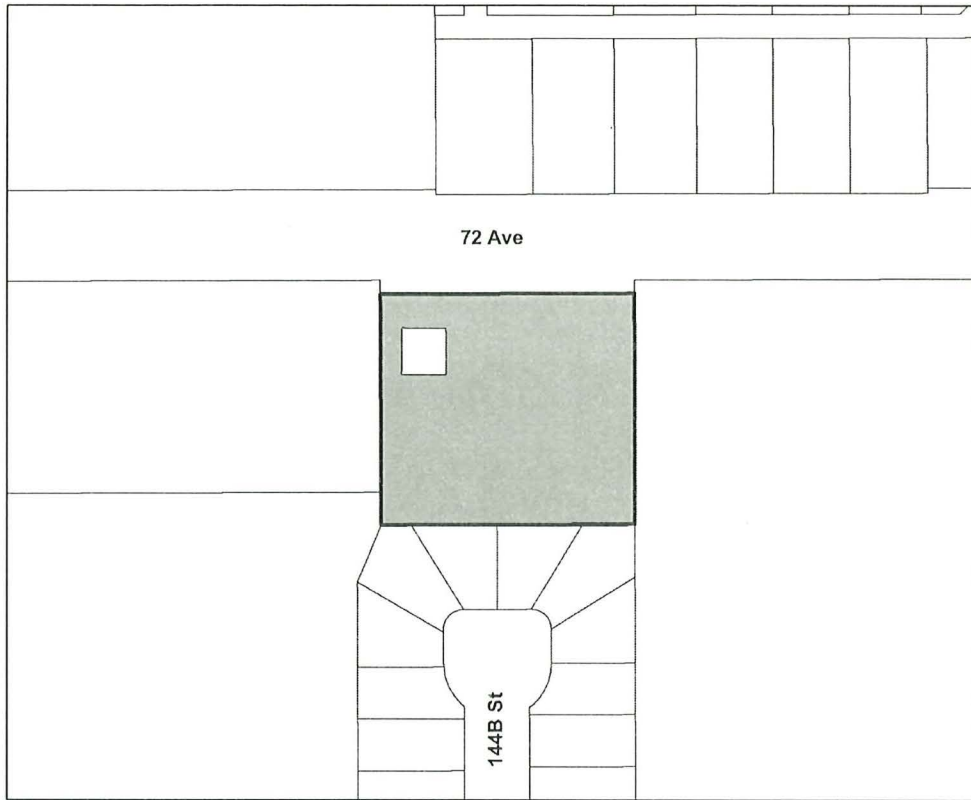

Legend

- EXEMPT: 3827 Sq/m
- NOT EXEMPT: 138 Sq/m
- Total Area: 3965 Sq/m



Sri Guru Singh Sabha
Gurdwara Association
Folio: 6292-50002-0
8135 132 St



Legend

- EXEMPT: 4430 Sq/m
- NOT EXEMPT: 971 Sq/m
- Total Area: 5401 Sq/m



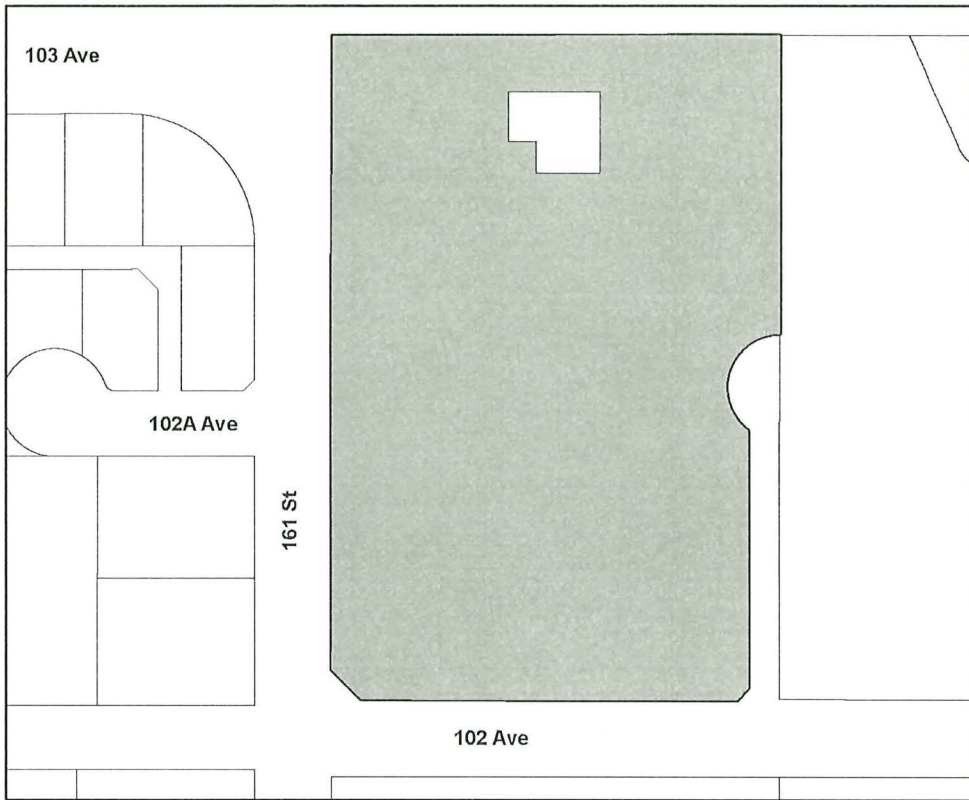

St Andrew Kim
Catholic Parish
Folio: 1260-13002-2
10222 161 St

Legend

- EXEMPT, 18764 Sq/m
- NOT EXEMPT, 437 Sq/m
- Total Area, 19201 Sq/m



St. Andrew's
Newton Presbyterian
Folio: 6183-00041-3
7147 124 St

Legend

- EXEMPT: 6524 Sq/m
- NOT EXEMPT: 2057 Sq/m
- Total Area: 8581 Sq/m



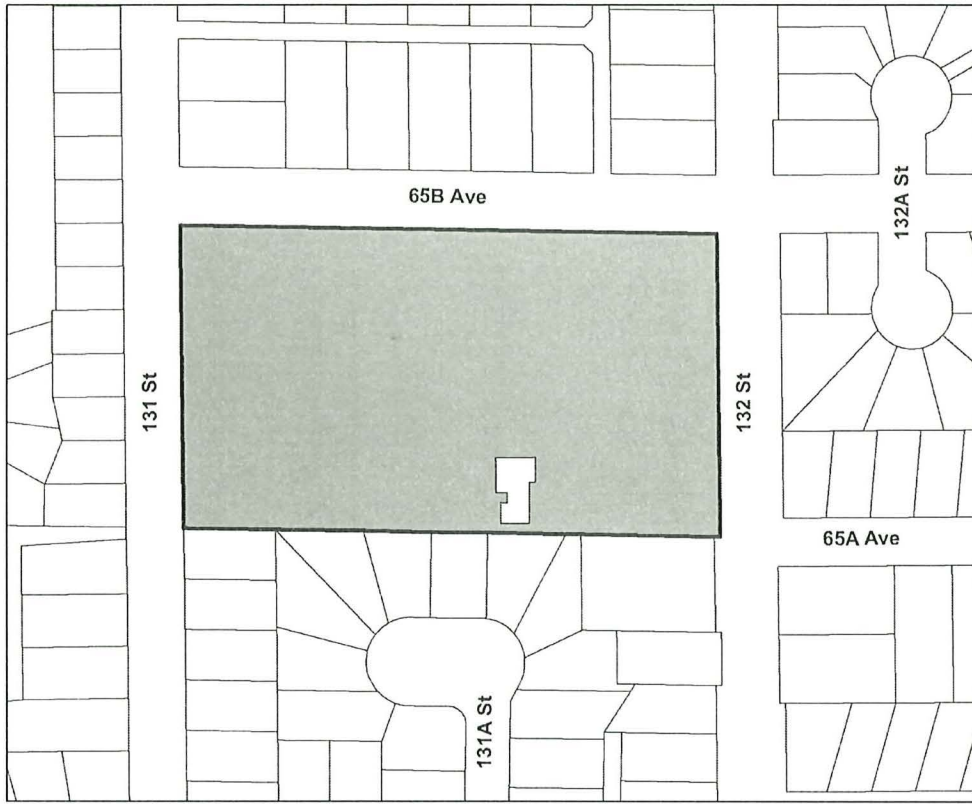

St Bernadette Roman Catholic Church
 Folio: 6172-36002-4
 6543 132 St

Legend

- EXEMPT, 19229 Sq/m
- NOT EXEMPT, 254 Sq/m
- Total Area, 19483 Sq/m



St George's Coptic Orthodox Church
 Folio: 2130-17007-9
 13905 108 Ave

Legend

- EXEMPT: 7611 Sq/m
- NOT EXEMPT: 522 Sq/m
- Total Area: 8133 Sq/m





**St George's Malankara
Orthodox Church**

15151 72 Avenue

Folio:
6221-90007-4

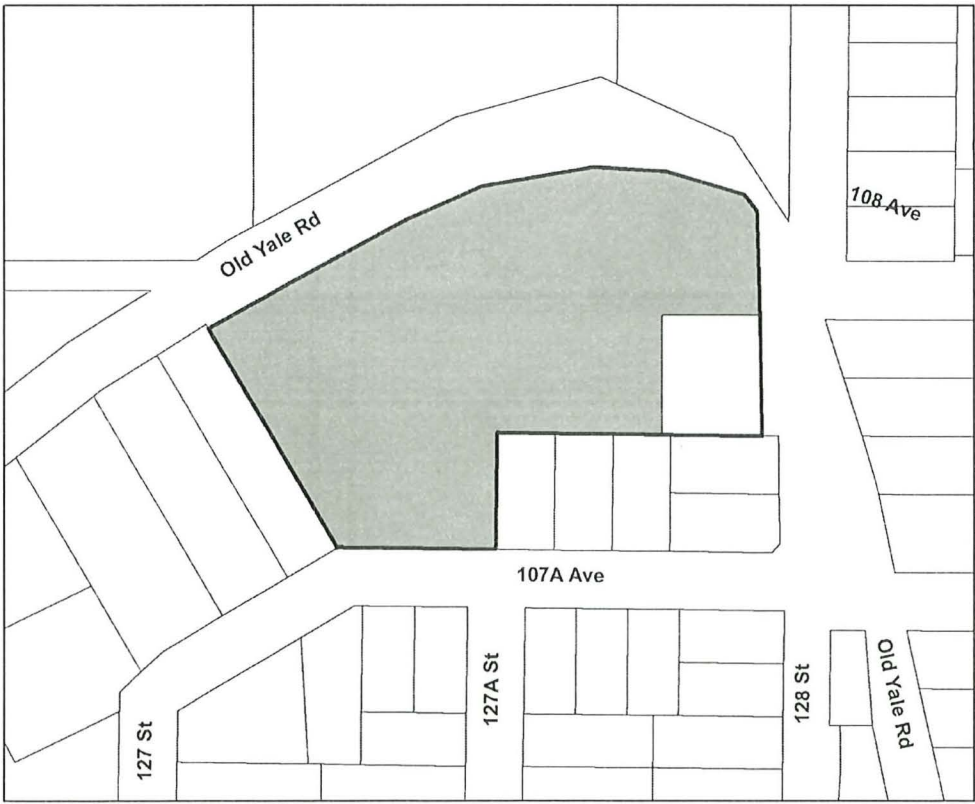

Legend

-  EXEMPT, 3259 Sq/m
-  NOT EXEMPT, 1059 Sq/m
-  Total Area, 4318 Sq/m



**St. Helen's
Anglican Church**
Folio: 2170-90015-9
10787 128 St

Legend



-  EXEMPT: 15291 Sq/m
-  NOT EXEMPT: 1417 Sq/m
-  Total Area: 16708 Sq/m

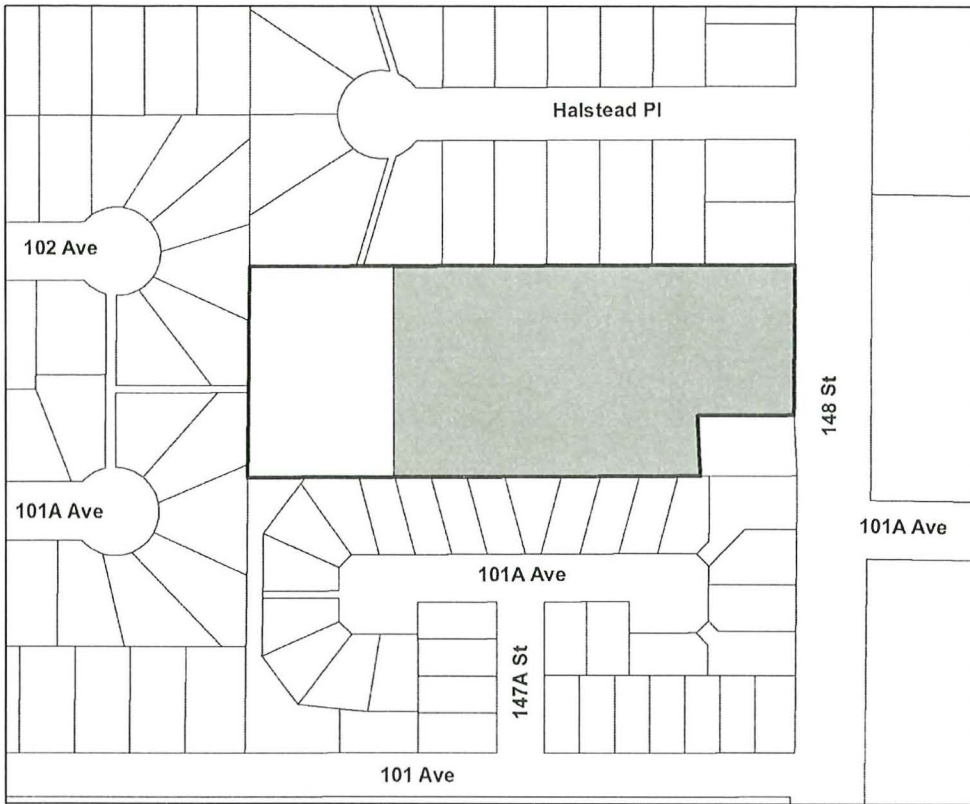



St. Luke
Lutheran Church
Folio: 1300-00001-6
10167 148 St



Legend

-  EXEMPT: 9426 Sq/m
-  NOT EXEMPT: 3660 Sq/m
-  Total Area: 13086 Sq/m



St. Michael's Church
Folio: 6082-28005-2
12996 60 Ave

Legend

-  EXEMPT: 4577 Sq/m
-  NOT EXEMPT: 3273 Sq/m
-  Total Area: 7850 Sq/m





St. Nicolae Romanian
Orthodox Church
Folio: 8283-00004-4
8679 Harvie Road

Legend

- EXEMPT: 1877 Sq/m
- NOT EXEMPT: 140 Sq/m
- Total Area: 2017 Sq/m



Star of the Sea Parish
Folio: 5150-23001-7
15024 24 Ave

Legend

- EXEMPT: 34291Sq/m
- NOT EXEMPT: 15570 Sq/m
- Total Area: 49861 Sq/m



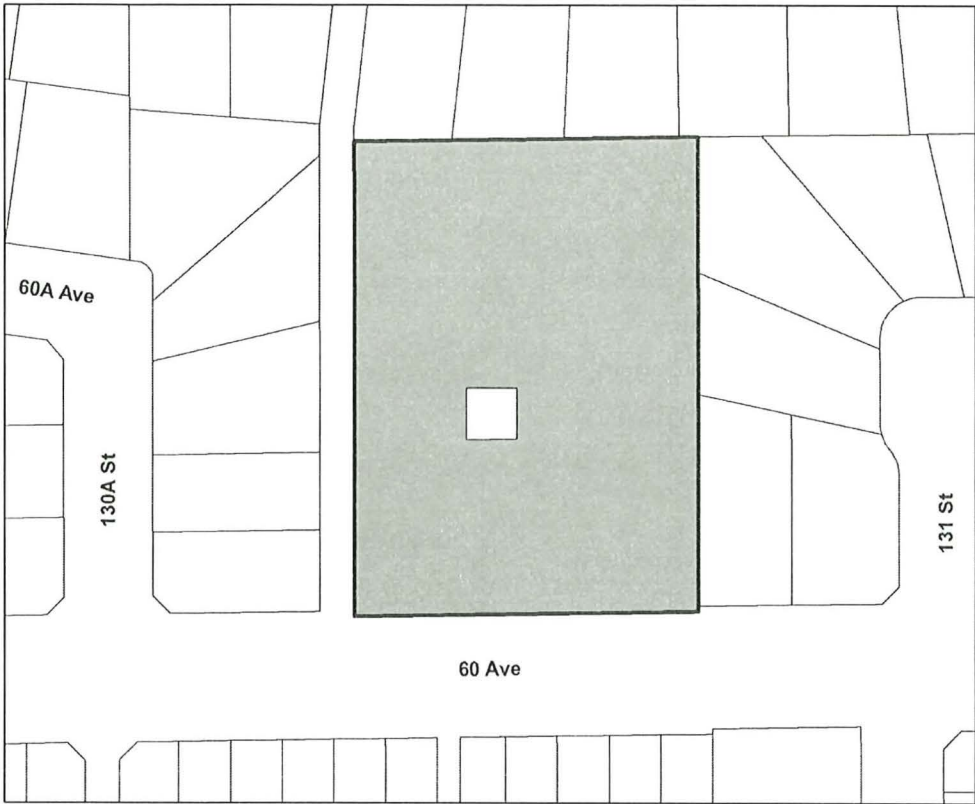

Sunshine Hills
 Congregation
 Kingdom Hall
 Folio: 6083-87702-7
 13095 60 Ave

Legend

- EXEMPT: 4813 Sq/m
- NOT EXEMPT: 76 Sq/m
- Total Area: 4889 Sq/m



Sunshine Ridge
 Baptist Church
 Folio: 6073-01059-X
 6230 120 St

Legend



- EXEMPT, 8033 Sq/m
- NOT EXEMPT, 4381 Sq/m
- Total Area, 12418 Sq/m





Surrey Alliance Church
 Folio: 6324-00028-X
 13474 96 Ave

Legend

-  EXEMPT, 6655 Sq/m
-  NOT EXEMPT, 4296 Sq/m
-  Total Area, 10993 Sq/m



Surrey Covenant
 Reformed Church
 Folio: 8071-52503-0
 17400 60 Ave

Legend



-  EXEMPT, 3599 Sq/m
-  NOT EXEMPT, 2460 Sq/m
-  Total Area: 6059 Sq/m





Surrey Free Methodist Church
 Folio: 2310-22002-4
 12371 96 Ave



Legend

-  EXEMPT: 4975 Sq/m
-  NOT EXEMPT: 2851 Sq/m
-  Total Area: 7826 Sq/m



Surrey Vietnamese Alliance Church
 Folio: 2140-90008-X
 13815 Grosvenor Rd

Legend

-  EXEMPT: 1387 Sq/m
-  NOT EXEMPT: 423 Sq/m
-  Total Area: 1810 Sq/m



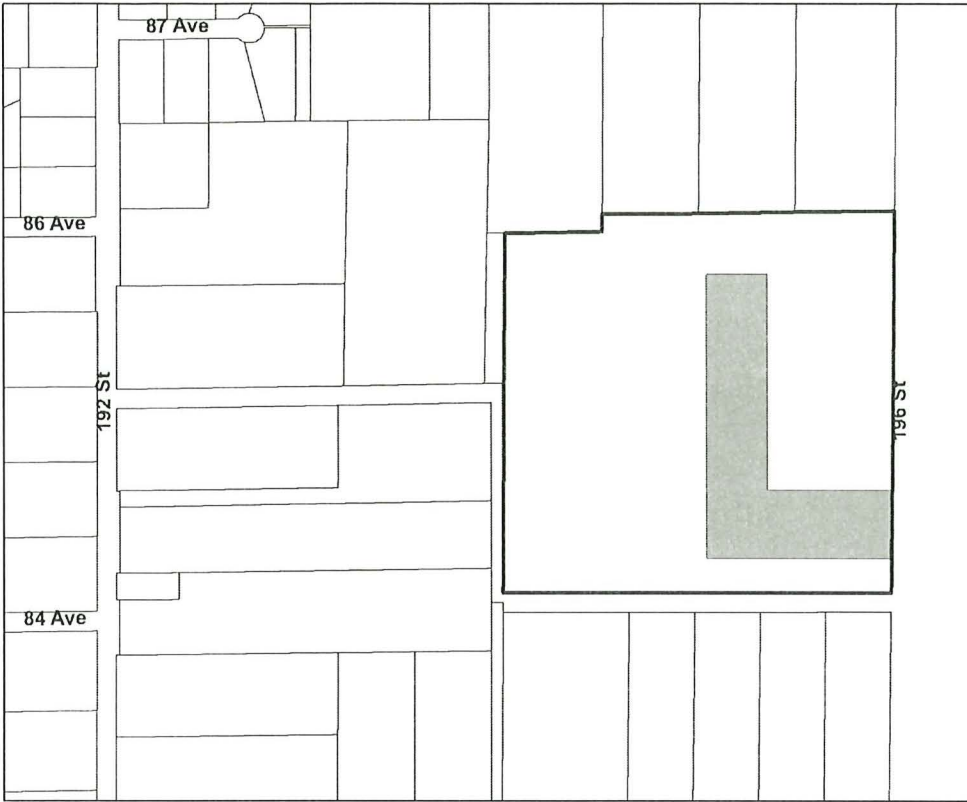

Tong Do Sa
Buddhist Temple
Folio: 8273-14002-7
8425 196 Ave

Legend

- EXEMPT: 27466 Sq/m
- NOT EXEMPT: 129558 Sq/m
- Total Area: 157024 Sq/m



Ukrainian Orthodox
Church of St. Mary
Folio: 2220-52502-8
10765 135A St

Legend

- EXEMPT: 644 Sq/m
- NOT EXEMPT: 363 Sq/m
- Total Area: 1007 Sq/m





Vedic Hindu Temple
Folio: 6282-91003-1
8321 140 St

Legend

- EXEMPT: 8113 Sq/m
- NOT EXEMPT: 4022 Sq/m
- Total Area: 12135 Sq/m

