

City of Surrey



SURREY
CITY OF PARKS

"Surrey Tree Protection Bylaw, 2006 No. 16100"

A Bylaw to regulate and prohibit the cutting, removal and damage of trees, the setting of fees and issuance of permits for the same and the requirement for replacement trees and of security for their provision and maintenance.

INDEX

| | |
|---|-----------|
| PART 1 | 1 |
| INTRODUCTORY PROVISIONS..... | 1 |
| PART 2 | 8 |
| APPLICATION AND EXEMPTIONS..... | 8 |
| PART 3 | 8 |
| PROHIBITIONS..... | 8 |
| PART 4 | 9 |
| OFFENCES..... | 9 |
| PART 5 | 9 |
| PART 6 | 9 |
| SIGNIFICANT TREES..... | 9 |
| PART 7 | 9 |
| TREE CUTTING PERMITS / PRUNING PROTECTED TREES..... | 9 |
| PART 8 | 13 |
| PERMIT FEES..... | 13 |
| PART 8A | 15 |
| SECURITIES..... | 15 |
| PART 9 | 18 |
| REPLACEMENT TREES..... | 18 |
| PART 10 | 21 |
| TREE PROTECTION..... | 21 |
| PART 11 | 22 |
| INSPECTION AND ASSESSMENT..... | 22 |
| PART 12 | 23 |
| RIGHT TO RECONSIDERATION..... | 23 |
| PART 12 | 23 |
| GENERAL PROVISIONS..... | 23 |
| SCHEDULE "A" DELETED BY BYLAW NO. 20251 | 24 |
| SCHEDULE "B" SIGNIFICANT TREES | 25 |
| SCHEDULE "B₁" SEMIAHMOO TRAIL | 37 |
| SCHEDULE "C" | 39 |

CITY OF SURREY

BYLAW NO. 16100

A bylaw to regulate and prohibit the cutting, removal and damage of trees, the setting of fees and issuance of permits and the requirement for replacement trees and of security for their provision and maintenance.

.....

As amended by By-law No: 16532, 01/14/08; 16586 03/10/08; 16859, 01/19/09; 16894, 04/20/09; 17047, 11/30/09; 17082, 12/14/09; 17327, 01/10/11; 17371, 03/14/11; 17480, 10/03/11; 17569, 02/06/12; 17635, 05/07/12; 17810, 12/10/12; 17845, 12/17/12; 18138, 01/13/14; 18360, 01/12/15; 18592, 12/14/15; 18659, 03/07/16; 18710, 07/11/16; 18984, 12/19/16; 19430, 12/18/17; 19720, 12/19/18; 19986, 12/16/19; 20223, 12/21/20; 20251, 01/11/21; 20509, 12/24/21; 20876, 04/17/23; 21230, 05/06/24; 21392, 09/23/2024; 21448, 11/04/2024

THIS IS A CONSOLIDATED BY-LAW PREPARED BY THE CITY OF SURREY FOR CONVENIENCE ONLY. THE CITY DOES NOT WARRANT THAT THE INFORMATION CONTAINED IN THIS CONSOLIDATION IS CURRENT. IT IS THE RESPONSIBILITY OF THE PERSON USING THIS CONSOLIDATION TO ENSURE THAT IT ACCURATELY REFLECTS CURRENT BY-LAW PROVISIONS.

- (a) WHEREAS pursuant to Sections 8(3)(c) and 50 to 52 of the *Community Charter*, S.B.C. 2003, c. 26, a city may, by bylaw, exercise certain powers to preserve and protect trees within the city, regulate the cutting and removal of trees and require their replacement;
- (b) AND WHEREAS Council considers it is in the public interest to provide for the protection and preservation of trees, the regulation of their cutting and removal and their replacement;

Under its statutory powers, including Sections 8(3)(c) and 50 to 52 of the *Community Charter*, S.B.C. 2003, c. 26, the Council of the City of Surrey, in open meeting assembled, enacts the following provisions:

Part 1
Introductory Provisions

Title

1. This Bylaw may be cited as "Surrey Tree Protection Bylaw, 2006, No. 16100".

Definitions

2. In this Bylaw,

"agricultural use"

means the use of land for the growing of crops or the raising of livestock as permitted under the Zoning Bylaw.

"arborist"

means an arborist who is both:

- (a) certified as an arborist by the International Society of Arboriculture; and
- (b) is qualified as a tree risk assessor by the International Society of Arboriculture.

"arborist report"

means a technical report prepared by an arborist which may include all or some of the following:

- (a) information relevant to the purpose for which the report is to be submitted to the City including, but not limited to, surveyed location, species, size and condition of the subject tree or trees;
- (b) the reasons for any proposed removal of a tree or trees;
- (c) description of the recommended tree protection and mitigation measures; and
- (d) a tree replacement strategy.

and the General Manager will specify in each instance which of the items listed above are required.

"Bylaw"

means the Surrey Tree Protection Bylaw, 2006, No. 16100, as amended.

"caliper"

means the diameter of a tree at 15 centimetres [6 inches] above the natural grade of the ground, measured from the base of the tree.

"City"

means the City of Surrey.

"conifer"

means a cone bearing tree or other plant that has its seeds in a cone structure.

"Council"

means the municipal Council of the City of Surrey.

"cut"

means to cut down a tree and shall include to pull up, push or pull over or otherwise fall the majority of a tree. **"Cutting"** shall have the corresponding meaning.

"crown"

means all parts of a tree, including all of the branches and foliage, that extend upward from the lowest branch of the tree.

"crown lifting"

means removing the lowest branches of the crown, having the effect of lifting the crown's base.

"damage"

means any action done to a tree which will likely cause a tree to die or cause a decline to the health of a tree, including but not limited to ringing, poisoning, burning, topping, root compaction, root cutting, shearing, denting, gouging, drilling, crown lifting, or pruning a tree in any manner other than as specifically permitted in this Bylaw. **"Topping"** will not be considered **"damage"** if evidence satisfactory to the General Manager is provided to the City to establish that the tree in question was previously topped prior to 2006. **"Damaged"** and **"damaging"** shall have the corresponding meaning.

"D.B.H."

means the diameter of a tree at breast height or 1.4 metres [4.6 feet] above the highest point of the natural grade of the ground measured from the base of a tree. For multi-stemmed trees, the three (3) largest stems shall be measured 1.4 metres [4.6 feet] above the highest point of the natural grade and the D.B.H. of the tree shall equal the cumulative total of the D.B.H. of the three (3) largest stems.

"deciduous"

means a tree or plant that sheds most or all of its foliage annually.

"drip line"

means a horizontal line on the ground encircling a tree corresponding to the furthest extension of the branches of a tree.

"engineer"

means a person registered or licensed as a professional engineer pursuant to the provisions of the *Engineers and Geoscientists Act*, R.S.B.C. 1996, c. 116, as amended.

"General Manager"

means the person appointed by Council as the General Manager of Planning and Development and shall include a City employee or employees whom the General Manager has delegated, in writing, the authority to act on his or her behalf pertaining to this Bylaw.

"letter of acceptance"

means a letter signed by the General Manager, Engineering when the following requirements have been met:

- (a) the engineer for the project on behalf of the owner has requested in writing the letter of acceptance;
- (b) the maintenance period or any extension thereof as set out in the applicable servicing agreement has expired with no identified damage, defect, deficiency or holdback that needs to be dealt with by the owner; and
- (c) the owner has completed all of the terms and conditions in the applicable servicing agreement, including without limitation, the registration in the Land Title Office of all statutory right of ways, easements, restrictive covenants, subdivision plan or Land Title Act section 107 road dedication plan.

"lot"

means land designated as a separate and distinct parcel on a legally recorded subdivision plan or description filed in the records of the Land Title Office.

"natural causes"

means death or decline of a tree as a result of natural diseases, pests, climactic conditions, inherent structural defects, or senescence.

"owner"

means the registered owner in fee simple of a lot upon which a tree is located.

"protected tree"

means:

- (a) any tree, including multi-stemmed trees, within the City, regardless of species, having a D.B.H. of 30 centimetres [11.8 inches] or more or, where measurement of the D.B.H. is impossible or impractical, any tree with a stump having a diameter of 35 centimetres [13.8 inches] or more, measured at the natural grade of the ground;
- (b) a replacement tree;
- (c) a tree planted or retained as a requirement of a subdivision application, development permit, development variance permit, building permit or demolition permit;
- (d) a tree located in a riparian area;
- (e) a specimen quality tree;
- (f) a significant tree;
- (g) a tree with evidence of nesting or use by:
 - (i) raptors as defined in the *Wildlife Act*, R.S.B.C. 1996, c. 488,
 - (ii) osprey, or
 - (iii) a heron colony;
- (h) the following tree species where the tree is 3 metres [118.1 inches] or taller, if coniferous, or a tree having a 5 centimetres [1.9 inches] or greater caliper, if deciduous:
 - (i) *Arbutus (Arbutus menziesii)*,
 - (ii) Garry Oak (*Quercus garryana*),
 - (iii) Coast Redwood (*Sequoia sempervirens*),
 - (iv) Dawn Redwood (*Metasequoia glyptostroboides*),
 - (v) Giant Redwood (*Sequoiadendron giganteum*),
 - (vi) Maidenhair Tree (*Ginkgo biloba*); and
- (i) any tree located on City property.

"replacement tree"

means a tree required to be planted to replace a tree cut, removed or damaged in accordance with this Bylaw.

"remove"

means to cut a tree and to remove it from the lot where it exists. **"Removed"**, **"removal"** and **"removing"** shall have the corresponding meaning.

"retained tree"

means a tree that has not been permitted for removal. **"Tree to be retained"** shall have the corresponding meaning.

"riparian area"

means the horizontal area within a lot, that is calculated by measuring the distance perpendicularly, from the top of bank in the direction away from the stream, where land disturbance of any kind is prohibited by the *Riparian Areas Protection Regulation*, B.C. Reg. 178/2019.

"significant tree"

means a tree listed in SCHEDULE "B" and SCHEDULE "B1".

"specimen quality tree"

means a tree of any size which the General Manager deems to be of exceptional value because of its species, condition, form, age or size but which has not been designated by Council to be a significant tree.

"stream"

means any of the following, in accordance with the *Water Sustainability Act*, S.B.C. 2014, c. 15, as amended, and the *Riparian Areas Protection Regulation*, B.C. Reg. 178/2019, as amended, that provides fish habitat:

- (a) a watercourse, whether it usually contains water or not;
- (b) a pond, lake, river, creek, brook, ravine, swamp, gulch or natural or channelized stream; or
- (c) a ditch, spring or wetland, that is connected by surface flow to any items referred to in (a) or (b) above.

"top of bank"

means:

- (a) the point closest to the boundary of the active floodplain of a stream where a break in the slope of the land occurs such that the grade beyond the break is flatter than 3:1 at any point for a minimum distance of 15 metres measured perpendicularly from the break; and
- (b) for a floodplain area not contained in a ravine, the edge of the active floodplain of a stream where the slope of the land beyond the edge is flatter than 3:1 at any point for a minimum distance of 15 metres measured perpendicularly from the edge.

"topping"

means to remove the entire crown of a tree, or a substantial part of the crown of a tree by cutting horizontally through the central or major stem of a tree.

"tree cutting permit"

means the written authority granted by the General Manager pursuant to this Bylaw for the cutting or removal of a specified tree or trees.

"tree protection barrier"

means a barrier constructed around a tree in accordance with Schedule "C" of this Bylaw to protect the tree from damage during construction, development or site disturbance.

"tree protection zone"

means the area within a tree protection barrier. Where a tree protection barrier has not been erected as required by this Bylaw, the tree protection zone shall be the area within which a tree protection barrier should have been erected in accordance with this Bylaw.

"tree survey"

means a survey plan prepared by an engineer or by a surveyor registered as a British Columbia land surveyor, that illustrates the location of trees in relation to the property lines of a lot, along with the size and species of each tree, plus any other information required by the General Manager for the purpose of assessing a tree cutting permit application.

"Zoning Bylaw"

means Surrey Zoning Bylaw, 1993, No. 12000, as may be amended or replaced from time to time.

Part 2 Application and Exemptions

3. This Bylaw applies to protected trees and to no other trees.
4. This Bylaw does not apply to protected trees, that are cut, removed or damaged, pursuant to the *Hydro and Power Authority Act*, R.S.B.C. 1996, c. 212 or the *Oil and Gas Activities Act*, S.B.C. 2008, c. 36.
5. This Bylaw does not apply to trees on City-owned property or highways that are cut or removed by the City or its authorized agents in accordance with approved City operations.
- 5.1 This Bylaw does not apply to trees on property owned by either the Government of Canada, the Province, or Metro Vancouver that are cut or removed by that entity or its authorized agents.

Part 3 Prohibitions

6. No person shall cut, remove or damage any protected tree or cause, suffer or permit any such tree to be cut, removed or damaged, except where permitted by and in accordance with the terms of this Bylaw.
7. In the event that a protected tree is in imminent danger of falling and injuring persons or property due to natural causes, and it is not possible to obtain a tree cutting permit prior to the tree falling, the owner may cut the tree or have it cut, but shall report the cutting of the tree to the General Manager within the next business day. The owner shall not remove the tree from the lot until the City has visited the lot and confirmed that the tree was in imminent danger of falling and injuring persons or property. If the General Manager determines that the tree was not in imminent danger of falling and injuring persons or property due to natural causes, the person or persons who cut the tree or who suffered or permit the tree to be cut shall be deemed to have cut the tree contrary to Section 6 of this Bylaw.
8. No person shall fail to comply with the terms and conditions of a tree cutting permit issued pursuant to this Bylaw.
- 8.1 No person shall provide information in support of a tree cutting permit application, which is false, inaccurate, incomplete or erroneous.
9. For the purposes of this Bylaw, an arborist report will only be accepted by the City within two (2) years of the date of issuance of the arborist report.

**Part 4
Offences**

10. Every person is guilty of an offence against this Bylaw and is liable to a fine of not less than FIFTY (\$50.00) DOLLARS and not more than TWENTY THOUSAND (\$20,000.00) DOLLARS per offence, who:
- (a) cuts, removes or damages a tree contrary to this Bylaw or contrary to the terms and conditions of a tree cutting permit;
 - (b) violates any of the provisions of this Bylaw or a tree cutting permit;
 - (c) suffers or permits any act or thing to be done in contravention or violation of any provision of this Bylaw or a tree cutting permit; or
 - (d) omits to do or refrains from doing anything required to be done by any of the provisions of this Bylaw or a tree cutting permit.
11. For the purposes of this Bylaw, each tree cut, removed or damaged in violation of this Bylaw and each day that a violation of this Bylaw is caused or permitted to exist by any person, shall constitute a separate offence.

Part 5

Sections 12 – 20 were deleted.

**Part 6
Significant Trees**

21. Deleted.
22. No person shall prune the branches or roots of a significant tree without first obtaining a tree cutting permit to do so in accordance with Part 7. There is no fee for such a permit.
23. A significant tree shall not be cut, removed or damaged in any way unless it is first removed from SCHEDULE "B" by an amendment to this Bylaw.
24. The General Manager, with the consent of the owner of the significant tree, may direct that a plaque or marker, that provides information about the significant tree, be placed near the significant tree.

**Part 7
Tree Cutting Permits / Pruning Protected Trees**

25. A person wishing to cut or remove a protected tree shall apply to the General Manager for a tree cutting permit to cut or remove the tree. A tree cutting permit application shall be in a form approved by the General Manager. The tree cutting permit shall be in a form

approved by the General Manager. The tree cutting permit may determine the number, size, species and location of replacement trees and required security.

26. Notice of the tree cutting permit shall be posted on the lot for which a tree cutting permit has been issued in a location visible to the public, prior to the commencement of any cutting or removal of a protected tree and shall remain posted on the lot until the completion of all work related to the cutting or removal of protected trees on the lot. The notice shall include a copy of the tree cutting permit, identify by species and location the trees which are to be cut or removed and provide a contact number for the permit holder and the City.
27. A person must not prune a protected tree unless:
 - (a) the tree is pruned pursuant to a tree cutting permit; or
 - (b) the pruning is limited to maintenance pruning that:
 - i. does not remove any branches from the top half of the tree;
 - ii. removes less than $\frac{1}{4}$ of the tree's total branches or limbs;
 - iii. removes less than $\frac{1}{4}$ of the tree's total live foliage or bud-bearing branches or limbs; and
 - iv. removes less than $\frac{1}{4}$ of the tree's crown.
- 27.1 Despite the limitations set out in Section 27(b), the pruning of a protected tree may be approved pursuant to Section 27(a) if the owner submits an arborist report which certifies that the pruning is necessary and this report is approved by the General Manager or an arborist chosen by the City.
- 27.2 A tree cutting permit may be issued for the topping of a protected tree if the tree was topped prior to the year 2006, or if the tree has lost a portion of the stem by natural causes. The owner is required to submit an arborist report which certifies that the pruning is necessary and where this report is approved by the General Manager or an arborist chosen by the City. The General Manager may require, as a condition of the tree cutting permit issued under this Section, that all pruning activity be carried out under the on-site supervision of an arborist.
- 27.3 A tree cutting permit may be issued for the pruning of a significant tree where the owner submits an arborist report which certifies that the pruning is necessary and where this report is approved by the General Manager or an arborist chosen by the City. The General Manager may require, as a condition of the tree cutting permit issued under this Section, that all pruning activity be carried out under the on-site supervision of an arborist.
28. The fee for the tree cutting permit shall be determined as set out in Part 8 and shall be paid upon application for the permit. No fee is required for a tree cutting permit issued pursuant to Part 7, Section 27.1, 27.2 or 27.3.
29. Subject to Part 7, Section 35, a tree cutting permit to cut or remove a protected tree, other than a significant tree, may be issued by the General Manager in the following circumstances:

- (a) where an arborist provides an arborist report to the satisfaction of the General Manager that a tree is an unreasonable hazard to the safety of persons or property, or where the applicant has otherwise demonstrated to the satisfaction of the General Manager that the tree is hazardous, dead, damaged, diseased or in decline beyond expectation of recovery;
- (b) where the General Manager, or his or her duly authorized representative, or an engineer employed by any public utility or an arborist certifies that in his or her opinion a tree is impairing, interfering with, or presents a risk or hazard to the operation of sewers, drains, water lines, septic fields, electrical lines, poles or other similar equipment and appurtenances and that the impairment, interference or risk cannot be reduced or removed in any way other than the removal of the tree;
- (c) where the tree prevents the owner of the lot on which the tree is located from developing or using a lot in a manner permitted under the Zoning By-law, and the development or use cannot be modified to accommodate the tree without causing the owner undue hardship as determined by the General Manager;
- (d) where:
 - (i) the tree is situated within two (2) metres of an existing building foundation wall permitted pursuant to the Zoning By-law, as measured from the outer stem of the tree at 1.4 metres up the stem, to the foundation; or
 - (ii) a building permitted by the Zoning By-law is proposed and the building layout, location, or shape cannot be modified to accommodate the tree without causing the owner undue hardship as determined by the General Manager.
- (e) where the tree is situated on a lot within the Agricultural Land Reserve, which is zoned to permit agricultural use and the application is accompanied by a sworn declaration of the owner declaring that the tree is to be cut or removed to permit agricultural use, that the agricultural use cannot be located elsewhere on the lot so as to accommodate the tree, and that the owner agrees in writing that no application for subdivision, rezoning, or development of that lot will be accepted by the City for a period of five (5) years commencing on the date of issuance of the tree cutting permit; or
- (f) where the tree is situated on a lot outside the Agricultural Land Reserve, which is zoned to permit agricultural use and the application is accompanied by an arborist report and by a sworn declaration of the owner declaring that the tree is to be cut or removed to permit agricultural use, that the agricultural use cannot be located elsewhere on that lot so as to accommodate the tree, and where the owner enters into a restrictive covenant registered on the title of the lot documenting that the owner has agreed not to make application for development of the lot for a period of ten (10) years, and that full replacement trees and all other applicable provisions

of this Bylaw, as determined by the General Manager, will apply should the development application be considered for the lot within the ten (10) year period.

30. The General Manager may issue a tree cutting permit for the removal of a protected tree other than a significant tree where the owner submits an arborist report which documents that the protected tree, by virtue of its size and species, is inappropriate for its location and the reasons that it is deemed to be inappropriate for its location, all to the satisfaction of the General Manager. The General Manager shall determine the number, size, species and location of replacement trees and required securities.
31. Deleted.
32. The General Manager may, as a condition of any tree cutting permit:
 - (a) require that a tree survey, arborist report in accordance with the terms of the tree cutting permit application, or both, accompany the tree cutting permit application;
 - (b) require that preliminary lot grading and servicing plans accompany the tree cutting permit application;
 - (c) require that the cutting and removal of trees or specific trees be carried out under the supervision of an arborist;
 - (d) recommend the treatment of diseased trees as an alternative to the removal of a protected tree;
 - (e) determine the location, number, species and size of replacement trees required; and
 - (f) require that a replacement tree plan be submitted by an arborist.
33. The General Manager may revoke a tree cutting permit if the terms and conditions of the permit have been breached or the information supplied by the applicant in support of the permit is found by the General Manager to have been inaccurate, incomplete or erroneous.
34. The General Manager may retain the services of an independent arborist to review an arborist report submitted to the City under the provisions of this Bylaw, in support of an application for a tree cutting permit, in instances where the completeness or accuracy of the report are brought into question through a field inspection by the General Manager or any other person conducting a field inspection pursuant to this Bylaw. Where the original arborist report submitted to the City is shown to be incomplete or inaccurate, the cost of the independent arborist report shall be paid by the owner and collected by the City, prior to the adoption of the related rezoning or the subdivision approval or the issuance of the related tree cutting permit, whichever comes first.
35. The General Manager may refuse to grant a tree cutting permit for trees located within a riparian area.

**Part 8
Permit Fees**

36. Existing Lots Where No Subdivision is Proposed

On existing lots zones for residential use where no subdivision is proposed, as well as on the lots zoned for commercial, industrial, or institutional use where neither subdivision consolidation, nor any development requiring a development permit or development variance permit is proposed, the fee for tree cutting permit shall be a ONE HUNDRED and TWO (\$102.00) DOLLARS base fee plus THIRTY-NINE (\$39.00) DOLLARS for every protected tree removed.

37. Proposed Subdivisions for Small-Scale Multi-Unit Housing Residential Lots

The following table shall be used to calculate the fee for a tree cutting permit for proposed subdivisions involving small-scale multi-unit housing residential lots:

| Zone and Lot Size | Fees |
|----------------------|---------------------------|
| R-4, R5, R5-S and R6 | \$143.00 per proposed Lot |
| R3 | \$171.00 per proposed Lot |
| R1, R2 and R2-O | \$206.00 per proposed Lot |
| RA | \$650.00 per proposed Lot |

All fees are subject to applicable taxes.

38. **Proposed Multi-Family Residential Lots, Commercial, Industrial and Institutional Lots (Other than those described in Part 8, Section 36)**

The following table shall be used to calculate the fee for a tree cutting permit for sites proposed for multi-family residential, commercial, industrial and institutional use:

| Zone Designation | Fees |
|--|-------------------|
| RM-M, RM-10, RM-15 RM-30, RM-45 RM-70, RM-135 RMC-135, RMC-150, RMS-1, RMS-1A, RMS-2, R-F(D), R-F(m), R-T(1), RM-1, RM-2, RM-3, RM-4, P-P, C-4, C-5, C-8, C8A, C-8B, C-15, C-35, CHI, CG-1, CG- 2, CTA, CCR, CPR, CPG-, CPM, C-L, C-R(1), CR(2), C-R(3), C-S, C-C, C-H, I-S, C-G(1) C-G(2), C-T(1), C-T(2), P-P(1), P-R, P-D, IB, IL, IH, IS, IA, CD, I-1, I-P(2), I-G, I-T, I-W, I-H, I-W, I-L(S), I-A PC, PA-1, PA-2, PI | \$650.00 per acre |

All fees are subject to applicable taxes.

39. **Agricultural Lots**

The following table shall be used to calculate the fee for a tree cutting permit for sites zoned or proposed for agricultural use:

| Zone Designation | Fees |
|------------------------------|-------------------|
| A-1, A-2, A-3 | \$531.00 per acre |
| A-1, A-2, A-3 within the ALR | \$531.00 per acre |

All fees are subject to applicable taxes.

For the purposes of Part 8, Section 39, the number of acres is based on the area to be cleared and not on the area of the entire lot.

- 39.1 If a protected tree is cut, removed or damaged contrary to the provisions of this Bylaw and prior to the issuance of a tree cutting permit by the City for the protected tree that is cut removed or damaged, the applicable tree cutting permit fees set by this Bylaw shall be doubled to account for the additional administrative costs borne by the City.
40. Where a tree cutting permit must be amended to show a change in the number or location of trees to be retained or removed after the tree cutting permit has been issued, the permit holder will be required to pay a non-refundable permit amendment fee in the amount of ONE HUNDRED and SEVEN (\$107.00) DOLLARS plus applicable taxes.
41. For the purposes of determining the fees under Part 8, any lot against which a land use contract has been registered shall be deemed to have the zone underlying the applicable land use contract and lots zoned pursuant to Surrey Zoning Bylaw, 1979, No. 5942, as amended, shall be deemed to have the zoning which corresponds to the zone name in Zoning Bylaw, 1979, No. 5942, as amended.

Part 8A Securities

General

42. Where replacement trees or retention of existing trees are required as a condition of a tree cutting permit or as part of a consequence for cutting, removing or damaging protected trees without a tree cutting permit or cutting, removing or damaging trees in excess of the number allowed by the tree cutting permit, the owner or person responsible for the cutting, removal or damage shall provide to the City a security deposit in cash or letter of credit in the amount specified on applicable notice, for the period and on the terms specified in Part 8A of this Bylaw. No interest shall be paid by the City on security deposits.
43. Any letter of credit required to be provided under this Bylaw shall be a clean, unconditional and irrevocable letter of credit drawn from a Canadian financial institution acceptable to the City and in a form acceptable to the City. If, for any reason, the irrevocable letter of credit ceases to be effective security or becomes unenforceable so as to remove or reduce its purpose as full security for the due and proper performance of the requirements of this Bylaw, the owner shall replace it with a further letter of credit acceptable to the City within twenty-one (21) days prior to the expiry of the letter of credit then held by the City. If the owner fails to do so, the City will draw down on the current letter of credit without notice or restriction and hold the monies in lieu thereof.
44. If at any time an owner fails to comply with the provisions of this Bylaw relating to requirements for retention of existing trees or replacement trees and their maintenance, the City may by its employees or others under its direction enter upon the lands that are the subject of the requirements to plant replacement trees or maintain protected trees and for such purposes may draw upon the securities provided and expend the funds to cover all costs and expenses of so doing. Alternatively, the City may use the securities to plant trees elsewhere on any City-owned property.

Replacement Trees

45. The amount of the security for the provision, installation and maintenance of replacement trees, as may be required by this Bylaw, shall be as follows:
- a. FIVE HUNDRED AND FIFTY (\$550.00) DOLLARS, plus applicable taxes per replacement tree where the replacement tree required is a five (5) centimetre caliper deciduous tree or a three (3) metre tall conifer;
 - b. ONE THOUSAND ONE HUNDRED (\$1,100.00) DOLLARS, plus applicable taxes per replacement tree where the replacement tree required is an eight (8) centimetre caliper deciduous tree or a four (4) metre tall conifer;
 - c. as specified by the General Manager when the replacement tree is other than the sizes listed in 45(a) or 45(b); and
 - d. where the replacement trees are part of the overall landscaping required under a development permit, development variance permit or subdivision, the security is to be in the amount specified in the approved landscape cost estimate associated with the development permit, development variance permit or subdivision.

Retained Trees

46. The amount of security for the trees proposed to be retained as a requirement of a subdivision application, development permit, development variance permit, building permit or demolition permit shall be as follows:
- (a) TEN THOUSAND (\$10,000.00) DOLLARS per significant tree;
 - (b) FIVE THOUSAND (\$5,000.00) DOLLARS per specimen quality tree;
 - (c) THREE THOUSAND (\$3,000.00) DOLLARS per protected tree other than 46(a) and 46(b) above;
 - (d) The total amount of security required under this Section may not exceed FIFTEEN THOUSAND (\$15,000.00) DOLLARS for a single family dwelling on an existing lot of record; and
 - (e) The total amount of security deposited under this Section may not exceed ONE HUNDRED AND FIFTY THOUSAND (\$150,000.00) DOLLARS for each subdivision, development permit, development variance permit or re-zoning application.

Release of Securities for Retained Trees

- 46.1 The security provided to the City under Section 46 will be held by the City until the General Manager determines that they have not been damaged during construction.
- 46.2 The security provided to the City under Section 46 for retained trees will be eligible for an inspection by the General Manager if one of the following conditions are met:
 - (a) twelve (12) months after a Letter of Acceptance is issued by the City;
 - (b) two (2) years after Building Final has been issued; or
 - (c) at the discretion of the General Manager.

Release of Securities for Replacement Trees and Landscaping

- 47. The amount of security held by the City under Section 45 shall be released in stages as provided in Sections 48 and 49. It will be a condition of the release of any security provided under this Bylaw, that the General Manager be satisfied that the owner has complied with the tree replacement and maintenance requirements of this Bylaw and the tree cutting permit.
- 48. Subject to Section 47, a security deposit collected to cover the cost and maintenance of a replacement tree, shall be reduced as follows:
 - a. by fifty (50%) percent of the original amount after the planting of replacement trees has been approved by the City in accordance with the inspection requirements as set out in Part 11; and
 - b. by the balance of the deposit after one year from the date of the first reduction provided that the condition of the replacement trees has been approved by the City in accordance with the inspection requirements as set out in Part 11.
- 49. Subject to Section 47 a security deposit collected to cover the total costs of the required landscaping, including replacement trees, shall be reduced as follows:
 - a. by ninety (90%) percent of the original amount after the landscaping is completed and approved by the City in accordance with the inspection requirements set out in Part 11; and
 - b. by the balance of the deposit after three (3) months from the date of the first reduction provided that the landscaping is approved by the City in accordance with the inspection requirements set out in Part 11.

49.1 If the time in Section 49(b) has passed without completion of the required work, a strata corporation that owns the lands upon which the work is to be done may request that the balance of the deposit be paid to the strata corporation. Upon receipt of such request the City will provide written notice to the person who paid the deposit at the last contact address in the City's files. The person who paid the deposit may then:

- (a) carry out the required work; or
- (b) agree in writing to allow the City to pay the deposit to the strata corporation,

and if the person does not carry out the work or respond within the time specified in the notice, the City may pay all or part of the deposit to the strata corporation upon completion by the strata corporation of the required work. The General Manager may require copies of invoices paid by the strata corporation, or such other proof as may be determined necessary by the General Manager, prior to payment of all or part of the deposit to the strata corporation.

Forfeit of Securities

49.2 If replacement trees are not planted as required under a tree cutting permit issued independently of a building permit, development permit, subdivision or rezoning, the replacement tree securities will be forfeited to the City two (2) years from the date of issuance of the tree cutting permit.

49.3 If replacement trees are not planted as required under a tree cutting permit issued for a building permit, development permit, subdivision or rezoning, the replacement tree securities will be forfeited to the City two (2) years from the date the building receives final approval or a letter of acceptance has been issued for the project, whichever is earlier. If the replacement trees are not planted and the building does not receive final approval or a letter or acceptance has not been issued, then the replacement tree securities will be forfeited to the City five (5) years from the date the tree cutting permit was issued.

49.4 If required landscaping, including replacement trees, is not carried out, the securities described in Section 49 will be forfeited to the City ten (10) years from the date the securities were paid to the City.

Part 9 Replacement Trees

49.5 If an owner cuts, removes or damages a protected tree or suffers or permits a protected tree to be cut, removed, or damaged in contravention of this Bylaw, or in violation or in excess of any terms and conditions of a tree cutting permit issued pursuant to this Bylaw, the owner shall be required to plant replacement trees, and the size, number, species, and location of replacement trees and amount of securities required to ensure the planting and maintenance of replacement trees is to be determined by the General Manager, based on the size, condition, species, value, and location of the tree cut, removed, or damaged and the conditions of the lot where the replacement trees are to be planted.

- 49.6 If the tree cut, removed, or damaged pursuant to section 49.5 is identified in a tree preservation plan approved by the City as a tree to be retained or protected, the owner may be required by the General Manager to:
- (a) plant the replacement trees at the exact location as the tree that has been cut, removed, or damaged; or
 - (b) ensure that any building or structure not be located within the drip line of the replacement trees at full growth.
50. In circumstances other than those prescribed by section 49.5, replacement trees shall be required in accordance with this Bylaw for each lot from which any protected tree is cut, removed or damaged and must be of a species and size as determined by the General Manager or as specified in the tree cutting permit, at the discretion of the General Manager.
51. Deleted.
52. Replacement trees must be planted and maintained in accordance with the requirements of this Bylaw.
53. Replacement trees shall be planted, where possible, on the same lot as the trees that are cut or removed to the extent that the lot will accommodate such replacement trees so as not to cause damage to the replacement trees.
- 53.1 Replacement trees shall not be planted:
- (a) within 1 metre of any property line of a lot;
 - (b) within 3.5 metres of a permitted building or structure's foundation wall;
 - (c) within 1 metre of service lines including but not limited to sanitary, water, electrical, underground services;
 - (d) within 1 metre of any hardscape including but not limited to retaining walls, driveways, patios, walkways;
 - (e) within 3 metres of another tree; or
 - (f) within 3 metres of overhead powerlines.
- 53.2 Replacement trees may be planted in a space that will be appropriate for the mature height and size of the tree species planted. Appropriate tree species may be recommended by an arborist and must be accepted by the General Manager.
54. Where no construction or site disturbance is proposed that would affect the planting of replacement trees, the replacement trees must be planted within ninety (90) days of the date of issuance of the tree cutting permit.
55. Where a replacement tree is to be planted pursuant to section 49.5 of this Bylaw, it must be planted within ninety (90) days of written notice being delivered to the owner by the City.

- 55.1 If an owner fails or refuses to plant the required replacement trees pursuant to section 49.5 of this Bylaw in the specified location(s) within one hundred and twenty (120) days of receiving written direction from the General Manager to do so, the City may:
- (a) use the security collected pursuant to this Bylaw to either have the trees planted onto the owner's lot or use the securities to plant trees elsewhere on City-owned property; or
 - (b) by its employees or other persons, at reasonable times and in a reasonable manner, enter the owner's lot and fulfil the requirement by planting the replacement trees at the expense of the owner.
56. Where the planting of replacement trees would hinder proposed construction or where proposed construction would jeopardize the survival of replacement trees, the replacement trees must be planted within ninety (90) days of the final occupancy approval for the last building being constructed that would jeopardize the survival of the tree, but in any case, within three (3) years of the date of the issuance of the tree cutting permit when the date of construction completion is not known, except where an extension of time is granted in writing by the General Manager.
57. The number of replacement trees required under Section 50 shall be two (2) replacement trees for each one (1) protected tree that is cut, removed, or damaged except as follows:
- (a) if the protected tree is a red alder or black cottonwood, and the tree is not located within a riparian area, the number of replacement trees required shall be one (1) tree for each one (1) protected tree that is cut, removed, or damaged or;
 - (b) if, in the assessment of the General Manager, the lot cannot accommodate the number of replacement trees required pursuant to this Bylaw, due to a reasonable likelihood that the replacement trees or surrounding trees will sustain damage as a result of the planting of the replacement trees due to the size or other characteristics of the lot, as determined by the General Manager, then the number of replacement trees required may be reduced as determined by the General Manager.
 - (c) Deleted.
 - (d) Deleted.
- 57.1 If the number of replacement trees required is reduced under Section 57(b), the owner shall be required to pay cash-in-lieu to the City in the amount of FIVE HUNDRED AND FIFTY (\$550.00) DOLLARS plus applicable taxes for each replacement tree that cannot be accommodated.
58. The General Manager may reduce the number of replacement trees required in Section 57 and increase the size of the required replacement trees and increase the amount of securities from FIVE HUNDRED AND FIFTY (\$550.00) DOLLARS plus applicable taxes per tree to ONE THOUSAND ONE HUNDRED (\$1100.00) DOLLARS plus applicable taxes per tree where it is determined by the General Manager that upsizing is required.

59. The cash-in-lieu described in Section 57.1 shall not exceed FORTY-ONE THOUSAND TWO HUNDRED AND FIFTY (\$41,250.00) DOLLARS, plus applicable taxes per acre of land from which trees are removed.
60. The number of replacement trees to be planted on each lot in small-scale multi-unit housing subdivisions, based on the zoning designation of the lot being created, may not exceed the number as specified below, provided that the requirements of Sections 57, 58, and 59 are met:

| Size of Lot Being Created | No. of Replacement Trees Required Per New Lot |
|---|---|
| Lots smaller than 340 m ² | 0, unless otherwise determined by the General Manager |
| Lots 341 m ² to 460 m ² | 2 |
| Lots 461 m ² to 580 m ² | 3 |
| Lots 581 m ² to 700 m ² | 4 |
| Lots 701 m ² to 820 m ² | 5 |
| Lots larger than 821 m ² | To be determined by the General Manager |

61. Where the total number of replacement trees required for the subdivision is less than one-half of the total number of protected trees to be removed from the parent lots that are being subdivided, the General Manager may require that the size of the replacement trees be increased and the amount of securities be increased to reflect the larger size of the replacement trees.
62. Where a tree that is not a protected tree is proposed to be retained within a proposed subdivision, and where the tree is the same size or larger than the size of the required replacement tree, the retained tree may be considered as one (1) of the replacement trees required for that lot, provided that it is growing in a location that does not conflict with proposed buildings, driveways, services or the construction of those buildings, driveways or services. If the number of trees retained on one (1) lot exceeds the number of replacement trees required for that lot, the extra trees may be credited against other lots. However, this transfer of credits from one (1) lot to another will be limited to a maximum of one (1) credit per lot, provided that a minimum of one (1) tree is planted in the front yard of each new lot.

**Part 10
Tree Protection**

63. Where the trunk of any protected tree is within ten (10) metres of any excavation, demolition, construction, or engineering works, or as otherwise required by the General Manager, a tree protection barrier must be installed around the protected tree in accordance with Schedule "C".

64. No demolition permit, building permit or tree cutting permit shall be issued before the tree protection barrier has been installed and approved by the General Manager.
65. A tree protection barrier must remain in place and in accordance with Schedule "C" until the removal of the tree protection barrier is approved by the General Manager.
66. Site disturbance within the tree protection zone is prohibited including, but not limited to, site grading, deposition or storage of soil or any other any material, disposal of any toxic material, access by any vehicular traffic or heavy equipment, storage of construction equipment, excavation, or use of the area as an amenity space during construction.
67. Any work within a tree protection zone must be approved by the General Manager, prior to its commencement and the General Manager may refuse to allow the work or may specify conditions under which the work is to be undertaken.

Part 11
Inspection and Assessment

68. The General Manager, an arborist, or similarly qualified expert retained by the General Manager to provide technical advice to the General Manager, or any Bylaw Enforcement Officer of the City is authorized to enter at all reasonable times without the consent of the owner on any lot that is subject to the Bylaw to ascertain whether the regulations, prohibitions and requirements of this Bylaw or any tree cutting permit are being met or to assess or inspect any tree or tree remains on the lot.
69. Where a protected tree has been cut or damaged on a lot in violation of this Bylaw, without a tree cutting permit, or in excess of any permission or in violation of any terms and conditions of a tree cutting permit, the trunks, limbs, roots, and remains of the cut or damaged tree shall not be removed from the lot until an investigation and assessment by the General Manager is completed and the removal is expressly authorized by the General Manager.
70. In accordance with Part 8, Section 47, once all replacement trees required under a tree cutting permit have been planted, or once the landscaping requirements of a development permit or building permit have been substantially completed, the owner may either:
 - a. request that the General Manager conduct a field review to confirm that the replacement trees or landscaping have been provided and installed in accordance with this Bylaw and any related permits, and if a reduction or release of securities is in order; or
 - b. have a landscape architect registered with the British Columbia Society of Landscape Architects (BCSLA) submit to the City a sealed BCSLA Schedule C-L along with a field review, provided that the same landscape architect has previously submitted to the City a BCSLA Schedule L for the same project and work.

71. A TWO HUNDRED and TWENTY-EIGHT (\$228.00) DOLLARS plus applicable taxes Site Visit fee will be charged for every field review that has been requested and conducted after the first review for any project, where no reasonable attempt has been made by the owner to correct the deficiency(s) identified during the previous field review. No further field reviews will be conducted until the Site Visit fee has been paid in full.

Part 12
Right to Reconsideration

- 71.1 If a person is subject to a decision of the General Manager pursuant to this Bylaw and is dissatisfied with the decision, the person may apply to Council to have the matter reconsidered, which application shall be made in writing, delivered to the City Clerk within 30 calendar days of the person being made aware of the decision, and shall include:
- (a) the applicant's personal information and contact details;
 - (b) the address of the subject property;
 - (c) a description of the decision the applicant is seeking be reconsidered; and
 - (d) the reason(s) the applicant objects to the decision.

Part 12
General Provisions

72. Deleted.
73. All Schedules referred to herein are attached to and form part of this Bylaw.
74. The provisions of this Bylaw are several and the invalidity of any part of this Bylaw shall not affect the validity of the remainder of this Bylaw.
75. This Bylaw shall come into force on the date of final adoption hereof.

PASSED THREE READINGS on the 11th day of September, 2006.

RECONSIDERED AND FINALLY ADOPTED, signed by the Mayor and Clerk and sealed with the Corporate Seal on the 25th day of September, 2006.

_____ Mayor

_____ Clerk

SCHEDULE "A"
Deleted by Bylaw No. 20251.

SCHEDULE "B"
Significant Trees

| Tree No. | Tree Species | Location | Owner | Heritage Plaque Number (if applicable) |
|-----------------|---------------------|-------------------------|----------------|---|
| 1. | English Oak | King George Blvd - 1984 | City of Surrey | |
| 2. | English Oak | King George Blvd - 1985 | City of Surrey | |
| 3. | English Oak | King George Blvd - 2009 | City of Surrey | |
| 4. | English Oak | King George Blvd - 2015 | City of Surrey | |
| 5. | English Oak | King George Blvd - 2023 | City of Surrey | |
| 6. | English Oak | King George Blvd - 2050 | City of Surrey | |
| 7. | English Oak | King George Blvd - 2078 | City of Surrey | |
| 8. | English Oak | King George Blvd - 2120 | City of Surrey | |
| 9. | English Oak | King George Blvd - 2121 | City of Surrey | |
| 10. | English Oak | King George Blvd - 2130 | City of Surrey | |
| 11. | English Oak | King George Blvd - 2140 | City of Surrey | |
| 12. | English Oak | King George Blvd - 2150 | City of Surrey | |
| 13. | English Oak | King George Blvd - 2155 | City of Surrey | |
| 14. | English Oak | King George Blvd - 2195 | City of Surrey | |
| 15. | English Oak | King George Blvd - 2227 | City of Surrey | |
| 16. | English Oak | King George Blvd - 2511 | City of Surrey | |
| 17. | English Oak | King George Blvd - 2525 | City of Surrey | |
| 18. | English Oak | King George Blvd - 2567 | City of Surrey | |
| 19. | English Oak | King George Blvd - 2601 | City of Surrey | |
| 20. | English Oak | King George Blvd - 2619 | City of Surrey | |
| 21. | English Oak | King George Blvd - 2620 | City of Surrey | |
| 22. | English Oak | King George Blvd - 2646 | City of Surrey | |
| 23. | English Oak | King George Blvd - 2812 | City of Surrey | |
| 24. | English Oak | King George Blvd - 2825 | City of Surrey | |
| 25. | English Oak | King George Blvd - 2845 | City of Surrey | |
| 26. | English Oak | King George Blvd - 2855 | City of Surrey | |
| 27. | English Oak | King George Blvd - 2875 | City of Surrey | |
| 28. | English Oak | King George Blvd - 2885 | City of Surrey | |
| 29. | English Oak | King George Blvd - 2925 | City of Surrey | |
| 30. | English Oak | King George Blvd - 2952 | City of Surrey | |
| 31. | English Oak | King George Blvd - 2958 | City of Surrey | |
| 32. | English Oak | King George Blvd - 2962 | City of Surrey | |
| 33. | English Oak | King George Blvd - 2970 | City of Surrey | |
| 34. | English Oak | King George Blvd - 2986 | City of Surrey | |
| 35. | English Oak | King George Blvd - 3061 | City of Surrey | |
| 36. | English Oak | King George Blvd - 3155 | City of Surrey | |
| 37. | English Oak | King George Blvd - 3189 | City of Surrey | |
| 38. | English Oak | King George Blvd - 3237 | City of Surrey | |
| 39. | English Oak | King George Blvd - 3247 | City of Surrey | |
| 40. | English Oak | King George Blvd - 3269 | City of Surrey | |
| 41. | English Oak | King George Blvd - 3329 | City of Surrey | |

| Tree No. | Tree Species | Location | Owner | Heritage Plaque Number (if applicable) |
|----------|-----------------|---|---|--|
| 42. | English Oak | King George Blvd - 3331 | City of Surrey | |
| 43. | Various | Cloverdale Library 17671 - 56 Avenue | City of Surrey | |
| 44. | Various | St. Helen's Church 10787-128 Street | Synod of the Diocese of New Westminster | |
| 45. | Various | Christ Church and Cemetery 16631 Old McLellan Road | Synod of the Diocese of New Westminster | |
| 46. | Various | Elgin Hall 14250 Crescent Road | City of Surrey | |
| 47. | Various | Elgin Centre 3530-144 Street | City of Surrey | |
| 48. | Various | Pillath Hall/ House 1113-148 Street | City of Surrey | |
| 49. | Various | Crescent Road, which land was designated as a heritage area and is more particularly described in Section 2 of "Surrey Municipal Heritage Site Designation Bylaw, 1983, No. 7716" | City of Surrey | |
| 50. | Various | Steward House/Ward's Marina 13723 Crescent Road | City of Surrey | |
| 51. | Red Cedar Stump | 8920 Queen Mary Boulevard | City of Surrey | |
| 52. | Various | Old Anniedale School 9744-176 Street | Surrey School District No. 36 | |
| 53. | Royal Oak Tree | 16613 Old McLellan Road | City of Surrey | |
| 54. | Douglas Fir | Avenue of Trees 16613 Old McLellan Road | City of Surrey | |
| 55. | Various | 5418-184 Street Robert Dougal MacKenzie House | Private | 12 |
| 56. | English Oak | King George Blvd - 3333 | City of Surrey | |
| 57. | English Oak | King George Blvd - 3387 | City of Surrey | |
| 58. | English Oak | King George Blvd - 3389 | City of Surrey | |
| 59. | English Oak | King George Blvd - 3391 | City of Surrey | |
| 60. | English Oak | King George Blvd - 3393 | City of Surrey | |
| 61. | English Oak | King George Blvd - 3395 | City of Surrey | |
| 68. | English Oak | King George Blvd - 1195 | City of Surrey | |
| 69. | English Oak | King George Blvd - 1201 | City of Surrey | |
| 70. | English Oak | King George Blvd - 1210 | City of Surrey | |
| 71. | English Oak | King George Blvd - 1211 | City of Surrey | |
| 72. | English Oak | King George Blvd - 1221 | City of Surrey | |
| 73. | English Oak | King George Blvd - 1231 | City of Surrey | |
| 74. | English Oak | King George Blvd - 1250 | City of Surrey | |
| 75. | English Oak | King George Blvd - 1251 | City of Surrey | |
| 76. | English Oak | King George Blvd - 1255 | City of Surrey | |

| Tree No. | Tree Species | Location | Owner | Heritage Plaque Number (if applicable) |
|----------|--------------------------------|---------------------------------|----------------|--|
| 77. | English Oak | King George Blvd - 1259 | City of Surrey | |
| 78. | English Oak | King George Blvd - 1265 | City of Surrey | |
| 79. | English Oak | King George Blvd - 1269 | City of Surrey | |
| 80. | English Oak | King George Blvd - 1272 | City of Surrey | |
| 81. | English Oak | King George Blvd - 1275 | City of Surrey | |
| 82. | English Oak | King George Blvd - 1276 | City of Surrey | |
| 83. | English Oak | King George Blvd - 1279 | City of Surrey | |
| 84. | English Oak | King George Blvd - 1280 | City of Surrey | |
| 85. | English Oak | King George Blvd - 1284 | City of Surrey | |
| 86. | English Oak | King George Blvd - 1288 | City of Surrey | |
| 87. | English Oak | King George Blvd - 1289 | City of Surrey | |
| 88. | English Oak | King George Blvd - 1292 | City of Surrey | |
| 89. | English Oak | King George Blvd - 1293 | City of Surrey | |
| 90. | English Oak | King George Blvd - 1296 | City of Surrey | |
| 91. | English Oak | King George Blvd - 1299 | City of Surrey | |
| 92. | English Oak | King George Blvd - 1300 | City of Surrey | |
| 93. | Douglas Fir | 5804 Kilkee Drive (Kilkee Park) | City of Surrey | 2 |
| 94. | Butternut/White Walnut | 6272-152 Street (Sullivan Park) | City of Surrey | 1 |
| 95. | Douglas Fir | 15100-22 Avenue | City of Surrey | 3 |
| 96. | Canadian/Japanese Walnut Cross | 1660-168 Street (Darts Hill) | City of Surrey | 4 |
| 98. | Douglas Fir | 1990-134 Street | Private | 16 |
| 99. | Douglas Fir | 9016-164 Street | Private | 5 |
| 100. | Douglas Fir | 19587-0 Avenue | Private | 6 |
| 101. | Weeping Willow | 2865 - 164 Street | Private | 15 |
| 102. | Sitka Spruce | 13398-Vine Maple Drive | Private | 7 |
| 103. | English Oak | 9353-160 Street | City of Surrey | 8 |
| 104. | Scotch Elm | 4100 - 152 Street | Private | Group 10 |
| 105. | Nordmann Fir | 1660-168 Street (Darts Hill) | City of Surrey | Group 1 |
| 106. | Spanish Fir | 1660-168 Street (Darts Hill) | City of Surrey | Group 1 |
| 107. | Incense Cedar (3 Trees) | 1660-168 Street (Darts Hill) | City of Surrey | Group 1 |
| 108. | Corkscrew Hazel | 1660-168 Street (Darts Hill) | City of Surrey | Group 1 |
| 109. | Sekkan Sugi Japanese Cedar | 1660-168 Street (Darts Hill) | City of Surrey | Group 1 |
| 110. | Sweet Chestnut | 1660-168 Street (Darts Hill) | City of Surrey | Group 1 |
| 111. | White Mulberry | 1660-168 Street (Darts Hill) | City of Surrey | Group 1 |
| 112. | Bigleaf Magnolia | 1660-168 Street (Darts Hill) | City of Surrey | Group 1 |
| 113. | Medlar | 1660-168 Street (Darts Hill) | City of Surrey | Group 1 |
| 114. | Antarctic Beech | 1660-168 Street (Darts Hill) | City of Surrey | Group 1 |
| 115. | Ironwood | 1660-168 Street (Darts Hill) | City of Surrey | Group 1 |
| 116. | Empress Tree | 1660-168 Street (Darts Hill) | City of Surrey | Group 1 |

| Tree No. | Tree Species | Location | Owner | Heritage Plaque Number (if applicable) |
|-----------------|---------------------------|---|-------------------------------|---|
| 117. | Oriental Spruce | 1660-168 Street (Darts Hill) | City of Surrey | Group 1 |
| 118. | Chinese Elm | 1660-168 Street (Darts Hill) | City of Surrey | Group 1 |
| 119. | Variegated Hiba Arborv. | 1660-168 Street (Darts Hill) | City of Surrey | Group 1 |
| 120. | California Bay Tree | 1660-168 Street (Darts Hill) | City of Surrey | Group 1 |
| 121. | China Fir | 1660-168 Street (Darts Hill) | City of Surrey | Group 1 |
| 122. | Weep. Giant Sequoia | 1660-168 Street (Darts Hill) | City of Surrey | Group 1 |
| 123. | Western Red Cedar | 10648-127 Street | City of Surrey | |
| 124. | Douglas Fir | 19016- 96 Avenue (St. Oswalds) | City of Surrey | Group 2 |
| 125. | Douglas Fir | 19016-96 Avenue (St. Oswalds) | City of Surrey | Group 2 |
| 126. | Douglas Fir | 19016-96 Avenue (St. Oswalds) | City of Surrey | Group 2 |
| 127. | Douglas Fir | 19016-96 Avenue (St. Oswalds) | City of Surrey | Group 2 |
| 128. | English Oak | 19016-96 Avenue (St. Oswalds Church) | City of Surrey | 31 |
| 129. | Western Red Cedar | 19587-0 Avenue | Private | 9 |
| 130. | European Beech | Peace Arch Park | Province of BC | Group 3 |
| 131. | Western White Pine | Peace Arch Park | Province of BC | Group 3 |
| 134. | Red Japanese Maple | Peace Arch Park | Province of BC | Group 3 |
| 135. | Atlas Cedar | Peace Arch Park | Province of BC | Group 3 |
| 136. | Crimson King Maple | Peace Arch Park | Province of BC | Group 3 |
| 137. | Maidenhair Tree | Peace Arch Park | Province of BC | Group 3 |
| 138. | Lawson's Cypress | Peace Arch Park | Province of BC | Group 3 |
| 139. | Horse Chestnut (15 Trees) | 17857-56 Avenue (Cloverdale Elementary) | Surrey School District No. 36 | Group 4 |
| 140. | Incense Cedar | 17900-20 Avenue (Redwood Park) | City of Surrey | Group 5 |
| 141. | Sweet Chestnut | 17900-20 Avenue (Redwood Park) | City of Surrey | Group 5 |
| 142. | Golden Lawson's Cypress | 17900-20 Avenue (Redwood Park) | City of Surrey | Group 5 |
| 143. | English Walnut | 17900-20 Avenue (Redwood Park) | City of Surrey | Group 5 |
| 144. | Dawn Redwood | 17900-20 Avenue (Redwood Park) | City of Surrey | Group 5 |
| 145. | Red Oak | 17900-20 Avenue (Redwood Park) | City of Surrey | Group 5 |
| 146. | Giant Sequoia | 17900-20 Avenue (Redwood Park) | City of Surrey | Group 5 |

| Tree No. | Tree Species | Location | Owner | Heritage Plaque Number (if applicable) |
|----------|---------------------------|--|----------------|--|
| 147. | Hiba Arborvitae (2 trees) | 17900-20 Avenue (Redwood Park) | City of Surrey | Group 5 |
| 148. | Siberian Elm | 17900-20 Avenue (Redwood Park) | City of Surrey | Group 5 |
| 149. | Golden Locust | 14239 Melrose | Private | |
| 150. | English Oak Grove | 140 Street and 96 Avenue (Green Timbers) | City of Surrey | Group 6 |
| 151. | Douglas Fir | 5480-184A Street | City of Surrey | 21 |
| 152. | Oriental Plane | 4117-152 Street | Private | 10 |
| 155. | English Oak | 16671 Old McLellan Road | City of Surrey | 19 |
| 156. | Western Red Cedar | 168 Street and 50 Avenue (Mound Farm) | City of Surrey | Group 7 |
| 157. | Western Red Cedar | 168 Street and 50 Avenue (Mound Farm) | City of Surrey | Group 7 |
| 158. | Douglas Fir | 168 Street and 50 Avenue (Mound Farm) | City of Surrey | Group 7 |
| 159. | Douglas Fir | 168 Street and 50 Avenue (Mound Farm) | City of Surrey | Group 7 |
| 160. | Douglas Fir | 168 Street and 50 Avenue (Mound Farm) | City of Surrey | Group 7 |
| 161. | Weep. Norway Spruce | 561-172 Street (The Glades) | City of Surrey | Group 8 |
| 162. | Kobus Magnolia | 561-172 Street (The Glades) | City of Surrey | Group 8 |
| 163. | Dove Tree | 561-172 Street (The Glades) | City of Surrey | Group 8 |
| 164. | Dawn Redwood | 561-172 Street (The Glades) | City of Surrey | Group 8 |
| 166. | California Bay St | 561-172 Street (The Glades) | City of Surrey | Group 8 |
| 167. | Mirbeck's Oak | 561-172 Street (The Glades) | City of Surrey | Group 8 |
| 169. | Western Red Cedar | 561-172 Street (The Glades) | City of Surrey | Group 8 |
| 170. | Various Arboretum | 9800-140 Street (Green Timbers) | City of Surrey | Group 9 |
| 171. | English Oak | 13997-90 Avenue (on 140 Street) | Private | 11 |
| 172. | Butternut | 6091-181A Street | City of Surrey | 28 |
| 174. | Sitka Spruce | Tynehead Regional Park | GVRD | |
| 175. | Sitka Spruce | Tynehead Regional Park | GVRD | |
| 176. | Common Apple | 18029 Highway 10 | Private | |
| 177. | Horse Chestnut | 18029 Highway 10 | Private | |
| 178. | English Walnut | 18029 Highway 10 | Private | |

| Tree No. | Tree Species | Location | Owner | Heritage Plaque Number (if applicable) |
|----------|------------------------------|---|------------------|--|
| 179. | English Walnut | 18029 Highway 10 | Private | |
| 180. | Black Walnut | 18029 Highway 10 | Private | |
| 181. | Black Walnut | 18029 Highway 10 | Private | |
| 183. | Douglas Fir | 18 Avenue and 136 Street (Bell Park) | City of Surrey | Group 11 |
| 184. | Douglas Fir | 18 Avenue and 136 Street (Bell Park) | City of Surrey | Group 11 |
| 185. | Coulter Pine | 12649-25 Avenue | Private | |
| 186. | English Oak | 13722-56 Avenue | Private | |
| 187. | Douglas Fir | 13600-55A Avenue | City of Surrey | 29 |
| 188. | Tulip Tree | 12976-Old Yale Road | City of Surrey | 20 |
| 189. | English Walnut | 19251-76 Avenue | Private | 23 |
| 190. | Beech | 12691-14 Avenue | Private | |
| 191. | Dead Douglas Fir | South Side of Highway #1 East of 176 Street | Province of B.C. | |
| 193. | Douglas Fir | 14158 Hyland Road | City of Surrey | 24 |
| 194. | Bigleaf Maple | 19184-16 Avenue | City of Surrey | 25 |
| 195. | Brewer's Weeping Spruce | 12731 Becket Road | Private | 26 |
| 196. | Purple Beech | 13275 Colebrook Road | City of Surrey | Group 12 |
| 197. | Purple Beech | 13275 Colebrook Road | City of Surrey | Group 12 |
| 198. | Purple Beech | 13275 Colebrook Road | City of Surrey | Group 12 |
| 199. | Weeping Linden | 13275 Colebrook Road | City of Surrey | Group 12 |
| 200. | English Oak | 13275 Colebrook Road | City of Surrey | Group 12 |
| 201. | Rock Tree | 12237 - 91A Avenue | Private | |
| 202. | All trees on Semiahmoo Trail | Various lots (see Schedule B1 for details) | City of Surrey | |
| 203. | Common Beech | 19340-88 Avenue (Port Kells Park) | City of Surrey | Group 14 |
| 204. | Common Beech | 19340-88 Avenue (Port Kells Park) | City of Surrey | Group 14 |
| 205. | English Oak | 19340-88 Avenue (Port Kells Park) | City of Surrey | Group 14 |
| 206. | English Oak | 19340-88 Avenue (Port Kells Park) | City of Surrey | Group 14 |
| 207. | English Oak | 19340-88 Avenue (Port Kells Park) | City of Surrey | Group 14 |
| 208. | English Oak | 19340-88 Avenue (Port Kells Park) | City of Surrey | Group 14 |
| 209. | English Oak | 19340-88 Avenue (Port Kells Park) | City of Surrey | Group 14 |
| 210. | Hedge Maple | 19340-88 Avenue (Port Kells Park) | City of Surrey | Group 14 |

| Tree No. | Tree Species | Location | Owner | Heritage Plaque Number (if applicable) |
|-----------------|---------------------|-----------------------------------|----------------|---|
| 211. | English Oak | 19340-88 Avenue (Port Kells Park) | City of Surrey | Group 14 |
| 212. | English Oak | 19340-88 Avenue (Port Kells Park) | City of Surrey | Group 14 |
| 213. | Hedge Maple | 19340-88 Avenue (Port Kells Park) | City of Surrey | Group 14 |
| 214. | English Oak | 19340-88 Avenue (Port Kells Park) | City of Surrey | Group 14 |
| 215. | Hedge Maple | 19340-88 Avenue (Port Kells Park) | City of Surrey | Group 14 |
| 216. | English Oak | 19340-88 Avenue (Port Kells Park) | City of Surrey | Group 14 |
| 217. | Hedge Maple | 19340-88 Avenue (Port Kells Park) | City of Surrey | Group 14 |
| 218. | English Oak | 19340-88 Avenue (Port Kells Park) | City of Surrey | Group 14 |
| 219. | English Oak | 19340-88 Avenue (Port Kells Park) | City of Surrey | Group 14 |
| 220. | Hedge Maple | 19340-88 Avenue (Port Kells Park) | City of Surrey | Group 14 |
| 221. | Common Beech | 19340-88 Avenue (Port Kells Park) | City of Surrey | Group 14 |
| 222. | English Oak | 19340-88 Avenue (Port Kells Park) | City of Surrey | Group 14 |
| 223. | English Oak | 19340-88 Avenue (Port Kells Park) | City of Surrey | Group 14 |
| 224. | English Oak | 19340-88 Avenue (Port Kells Park) | City of Surrey | Group 14 |
| 225. | English Oak | 19340-88 Avenue (Port Kells Park) | City of Surrey | Group 14 |
| 226. | Common Beech | 19340-88 Avenue (Port Kells Park) | City of Surrey | Group 14 |
| 227. | English Oak | 19340-88 Avenue (Port Kells Park) | City of Surrey | Group 14 |
| 228. | Common Beech | 19340-88 Avenue (Port Kells Park) | City of Surrey | Group 14 |
| 229. | English Oak | 19340-88 Avenue (Port Kells Park) | City of Surrey | Group 14 |
| 230. | English Oak | 19340-88 Avenue (Port Kells Park) | City of Surrey | Group 14 |
| 231. | Common Beech | 19340-88 Avenue (Port Kells Park) | City of Surrey | Group 14 |
| 232. | English Oak | 19340-88 Avenue (Port Kells Park) | City of Surrey | Group 14 |

| Tree No. | Tree Species | Location | Owner | Heritage Plaque Number (if applicable) |
|-----------------|---------------------------|---|----------------------------------|---|
| 233. | Sitka Spruce | 19340-88 Avenue (Port Kells Park) | City of Surrey | Group 14 |
| 234. | Sitka Spruce | 19340-88 Avenue (Port Kells Park) | City of Surrey | Group 14 |
| 235. | Douglas Fir | 19340-88 Avenue (Port Kells Park) | City of Surrey | Group 14 |
| 236. | Douglas Fir | 19340-88 Avenue (Port Kells Park) | City of Surrey | Group 14 |
| 237. | Douglas Fir | 19340-88 Avenue (Port Kells Park) | City of Surrey | Group 14 |
| 238. | Douglas Fir | 18918-88 Avenue (Port Kells Community Hall) | City of Surrey | Group 15 |
| 239. | Douglas Fir | 18918-88 Avenue (Port Kells Community Hall) | City of Surrey | Group 15 |
| 240. | Douglas Fir | 18918-88 Avenue (Port Kells Community Hall) | City of Surrey | Group 15 |
| 241. | Douglas Fir | 18918-88 Avenue (Port Kells Community Hall) | City of Surrey | Group 15 |
| 242. | Douglas Fir | 18918-88 Avenue (Port Kells Community Hall) | City of Surrey | Group 15 |
| 243. | Douglas Fir | 18809-88 Avenue (Port Kells Library) | City of Surrey | 30 |
| 244. | Douglas Fir | 19076-88 Avenue (Port Kells Elementary School) | Surrey School District No. 36 | Group 16 |
| 245. | Douglas Fir | 19076-88 Avenue (Port Kells Elementary School) | Surrey School District No. 36 | Group 16 |
| 246. | Douglas Fir | 19076-88 Avenue (Port Kells Elementary School) | Surrey School District No. 36 | Group 16 |
| 247. | Sugar Maple (12 trees) | 8261-188 Street | City of Surrey | Group 17 |
| 249. | Douglas Fir | 8850 Harvie Road | Private | Group 18 |
| 250. | Douglas Fir | 8850 Harvie Road | Private | Group 18 |
| 251. | White Ash | 18385 - 80 Avenue | Private | 34 |
| 252. | English Oak | 9012 - 160 Street | City of Surrey | 32 |
| 253. | Sugar Maples (2 Trees) | 8495 - 144 Street | City of Surrey | Group 13 |
| 254. | Silver maple | Surrey Nature Centre at Green Timbers | City of Surrey | Group 9 |
| 255. | Norway Maple | Surrey Nature Centre at Green Timbers | City of Surrey | Group 9 |
| 256. | Hedge Maple | Surrey Nature Centre at Green Timbers | City of Surrey | Group 9 |
| 257. | Whitebeam Mountain Ash | Surrey Nature Centre at Green Timbers | City of Surrey | Group 9 |

| Tree No. | Tree Species | Location | Owner | Heritage Plaque Number (if applicable) |
|-----------------|-------------------------|---------------------------------------|----------------|---|
| 258. | Weeping American Elm | Surrey Nature Centre at Green Timbers | City of Surrey | Group 9 |
| 259. | Thornless Honeylocust | Surrey Nature Centre at Green Timbers | City of Surrey | Group 9 |
| 260. | Sawara False Cypress | Surrey Nature Centre at Green Timbers | City of Surrey | Group 9 |
| 261. | European Beech | Surrey Nature Centre at Green Timbers | City of Surrey | Group 9 |
| 262. | Weeping cut-leaf Birch | Surrey Nature Centre at Green Timbers | City of Surrey | Group 9 |
| 263. | European Mountain Ash | Surrey Nature Centre at Green Timbers | City of Surrey | Group 9 |
| 264. | Dawn Redwood | Surrey Nature Centre at Green Timbers | City of Surrey | Group 9 |
| 265. | Golden Atlas Cedar | Surrey Nature Centre at Green Timbers | City of Surrey | Group 9 |
| 266. | Sawara False Cypress | Surrey Nature Centre at Green Timbers | City of Surrey | Group 9 |
| 267. | Weeping White Mulberry | Surrey Nature Centre at Green Timbers | City of Surrey | Group 9 |
| 268. | American Elm | Green Timbers Way | Province of BC | Group 9 |
| 269. | Northern Red Oak | Green Timbers Way | Province of BC | Group 9 |
| 270. | White Hawthorn | Green Timbers Way | Province of BC | Group 9 |
| 271. | Common Horse Chestnut | Green Timbers Way | Province of BC | Group 9 |
| 272. | Northern Red Oak | Green Timbers Way | Province of BC | Group 9 |
| 273. | Black Locust | Green Timbers Way | Province of BC | Group 9 |
| 274. | Western Catalpa | Green Timbers Way | Province of BC | Group 9 |
| 275. | Red Maple | Green Timbers Way | Province of BC | Group 9 |
| 276. | Purple Leaf English Oak | Green Timbers Way | Province of BC | Group 9 |
| 277. | Northern Red Oak | Green Timbers Way | Province of BC | Group 9 |
| 278. | Northern Red Oak | Green Timbers Way | Province of BC | Group 9 |
| 279. | Northern Red Oak | Green Timbers Way | Province of BC | Group 9 |
| 280. | Tulip Poplar | Green Timbers Way | Province of BC | Group 9 |
| 281. | Norway Maple | Green Timbers Way | Province of BC | Group 9 |
| 282. | Black Locust | Green Timbers Way | Province of BC | Group 9 |
| 283. | Atlas cedar | Green Timbers Block H | Province of BC | Group 9 |
| 284. | Deodar Cedar | Green Timbers Block H | Province of BC | Group 9 |
| 285. | Colorado Blue Spruce | Green Timbers Block H | Province of BC | Group 9 |
| 286. | Weeping Giant Sequoia | Green Timbers Block H | Province of BC | Group 9 |

| Tree No. | Tree Species | Location | Owner | Heritage Plaque Number (if applicable) |
|----------|-------------------|---|----------------|--|
| 287. | Sugar Maple | Green Timbers RCMP E Division | Federal | Group 9 |
| 288. | European Ash | Green Timbers RCMP E Division | Federal | Group 9 |
| 289. | Sugar Maple | Green Timbers RCMP E Division | Federal | Group 9 |
| 290. | European Ash | Green Timbers RCMP E Division | Federal | Group 9 |
| 291. | American elm | Green Timbers RCMP E Division | Federal | Group 9 |
| 292. | Red Maple | Green Timbers RCMP E Division | Federal | Group 9 |
| 293. | London Plane | Green Timbers RCMP E Division | Federal | Group 9 |
| 294. | Sugar Maple | Green Timbers RCMP E Division | Federal | Group 9 |
| 295. | Weeping Willow | 8375 - 168 Street | City of Surrey | |
| 296. | American Elm | 8135 - 132 Street | City of Surrey | |
| 297. | White Spruce | Elgin Heritage Park, 13723 Crescent Rd. | City of Surrey | |
| 298. | Western Red Cedar | Royal Kwantlen Park, 13079 - 104 Avenue | City of Surrey | |
| 299. | Giant Sequoia | Enver Creek Park, 8170 - 146 Street | City of Surrey | |
| 300. | Yellow Buckeye | Sullivan Park, 6272 - 152 Street | City of Surrey | |
| 301. | Giant Sequoia | Larond Park, 1806 - 130 Street | City of Surrey | |
| 302. | Douglas-fir | Cloverdale Athletic Park | City of Surrey | |
| 303. | Lavalle hawthorn | 19083-68B Avenue | City of Surrey | |
| 304. | Coskspur Thorn | Green Timbers Nature Centre | City of Surrey | |
| 305. | Dawn Redwood | Hjorth Road Park | City of Surrey | |
| 306. | Giant Sequoia | Unwin Park, 13313 68 Ave | City of Surrey | |
| 307. | Jeffrey pine | Hillcrest- maple leaf day 2008 | City of Surrey | |
| 308. | Western Red Cedar | 13124 - 14A Avenue | Private | 35 |
| 309. | English Oak | King George Blvd - 2200 | City of Surrey | |
| 310. | English Oak | King George Blvd - 2202 | City of Surrey | |
| 311. | English Oak | King George Blvd - 2204 | City of Surrey | |
| 312. | English Oak | King George Blvd - 2206 | City of Surrey | |
| 313. | English Oak | King George Blvd - 2208 | City of Surrey | |
| 314. | English Oak | King George Blvd - 2225 | City of Surrey | |
| 315. | English Oak | King George Blvd - 2227 | City of Surrey | |
| 316. | English Oak | King George Blvd - 2251 | City of Surrey | |
| 317. | English Oak | King George Blvd - 2255 | City of Surrey | |
| 318. | English Oak | King George Blvd - 2281 | City of Surrey | |
| 319. | English Oak | King George Blvd - 2293 | City of Surrey | |

| Tree No. | Tree Species | Location | Owner | Heritage Plaque Number (if applicable) |
|-----------------|---------------------|-------------------------|----------------|---|
| 320. | English Oak | King George Blvd - 2297 | City of Surrey | |
| 321. | English Oak | King George Blvd - 2300 | City of Surrey | |
| 322. | English Oak | King George Blvd - 2301 | City of Surrey | |
| 323. | English Oak | King George Blvd - 2302 | City of Surrey | |
| 324. | English Oak | King George Blvd - 2304 | City of Surrey | |
| 325. | English Oak | King George Blvd - 2306 | City of Surrey | |
| 326. | English Oak | King George Blvd - 2308 | City of Surrey | |
| 327. | English Oak | King George Blvd - 2310 | City of Surrey | |
| 328. | English Oak | King George Blvd - 2315 | City of Surrey | |
| 329. | English Oak | King George Blvd - 2320 | City of Surrey | |
| 330. | English Oak | King George Blvd - 2336 | City of Surrey | |
| 331. | English Oak | King George Blvd - 2337 | City of Surrey | |
| 332. | English Oak | King George Blvd - 2355 | City of Surrey | |
| 333. | English Oak | King George Blvd - 2377 | City of Surrey | |
| 334. | English Oak | King George Blvd - 2381 | City of Surrey | |
| 335. | English Oak | King George Blvd - 2423 | City of Surrey | |
| 336. | English Oak | King George Blvd - 2428 | City of Surrey | |
| 337. | English Oak | King George Blvd - 2430 | City of Surrey | |
| 338. | English Oak | King George Blvd - 2451 | City of Surrey | |
| 339. | English Oak | King George Blvd - 2460 | City of Surrey | |
| 340. | English Oak | King George Blvd - 2461 | City of Surrey | |
| 341. | English Oak | King George Blvd - 2466 | City of Surrey | |
| 342. | English Oak | King George Blvd - 2471 | City of Surrey | |
| 343. | English Oak | King George Blvd - 2480 | City of Surrey | |
| 344. | English Oak | King George Blvd - 2491 | City of Surrey | |
| 345. | English Oak | King George Blvd - 2498 | City of Surrey | |
| 346. | English Oak | King George Blvd - 2500 | City of Surrey | |
| 347. | English Oak | King George Blvd - 2524 | City of Surrey | |
| 348. | English Oak | King George Blvd - 2530 | City of Surrey | |
| 349. | English Oak | King George Blvd - 2536 | City of Surrey | |
| 350. | English Oak | King George Blvd - 2546 | City of Surrey | |
| 351. | English Oak | King George Blvd - 2569 | City of Surrey | |
| 352. | English Oak | King George Blvd - 2570 | City of Surrey | |
| 353. | English Oak | King George Blvd - 2571 | City of Surrey | |
| 354. | English Oak | King George Blvd - 2601 | City of Surrey | |
| 355. | English Oak | King George Blvd - 2641 | City of Surrey | |
| 356. | English Oak | King George Blvd - 2645 | City of Surrey | |
| 357. | English Oak | King George Blvd - 2649 | City of Surrey | |
| 358. | English Oak | King George Blvd - 2650 | City of Surrey | |
| 359. | English Oak | King George Blvd - 2651 | City of Surrey | |
| 360. | English Oak | King George Blvd - 2655 | City of Surrey | |
| 361. | English Oak | King George Blvd - 2660 | City of Surrey | |
| 362. | English Oak | King George Blvd - 2670 | City of Surrey | |

| Tree No. | Tree Species | Location | Owner | Heritage Plaque Number (if applicable) |
|-----------------|-----------------------|-------------------------|----------------|---|
| 363. | English Oak | King George Blvd - 2675 | City of Surrey | |
| 364. | English Oak | King George Blvd - 2680 | City of Surrey | |
| 365. | English Oak | King George Blvd - 2690 | City of Surrey | |
| 366. | English Oak | King George Blvd - 2700 | City of Surrey | |
| 367. | English Oak | King George Blvd - 2710 | City of Surrey | |
| 368. | English Oak | King George Blvd - 2713 | City of Surrey | |
| 369. | English Oak | King George Blvd - 2751 | City of Surrey | |
| 370. | English Oak | King George Blvd - 2755 | City of Surrey | |
| 371. | English Oak | King George Blvd - 2759 | City of Surrey | |
| 372. | English Oak | King George Blvd - 2763 | City of Surrey | |
| 373. | English Oak | King George Blvd - 2765 | City of Surrey | |
| 374. | English Oak | King George Blvd - 2769 | City of Surrey | |
| 375. | English Oak | King George Blvd - 2770 | City of Surrey | |
| 376. | English Oak | King George Blvd - 2780 | City of Surrey | |
| 377. | English Oak | King George Blvd - 2790 | City of Surrey | |
| 378. | English Oak | King George Blvd - 2800 | City of Surrey | |
| 379. | Common Horse Chestnut | 12645 - 14B Avenue | City of Surrey | |
| 380. | Giant Sequoia | 9700 Block - 168 Street | City of Surrey | |
| 381. | Black Walnut | 10871 - 139A Street | Private | |
| 382. | Douglas Fir | 9631 - 161A Street | Private | |

SCHEDULE "B1" Semiahmo Trail



SCHEDULE "B1" Semiahmoo Trail

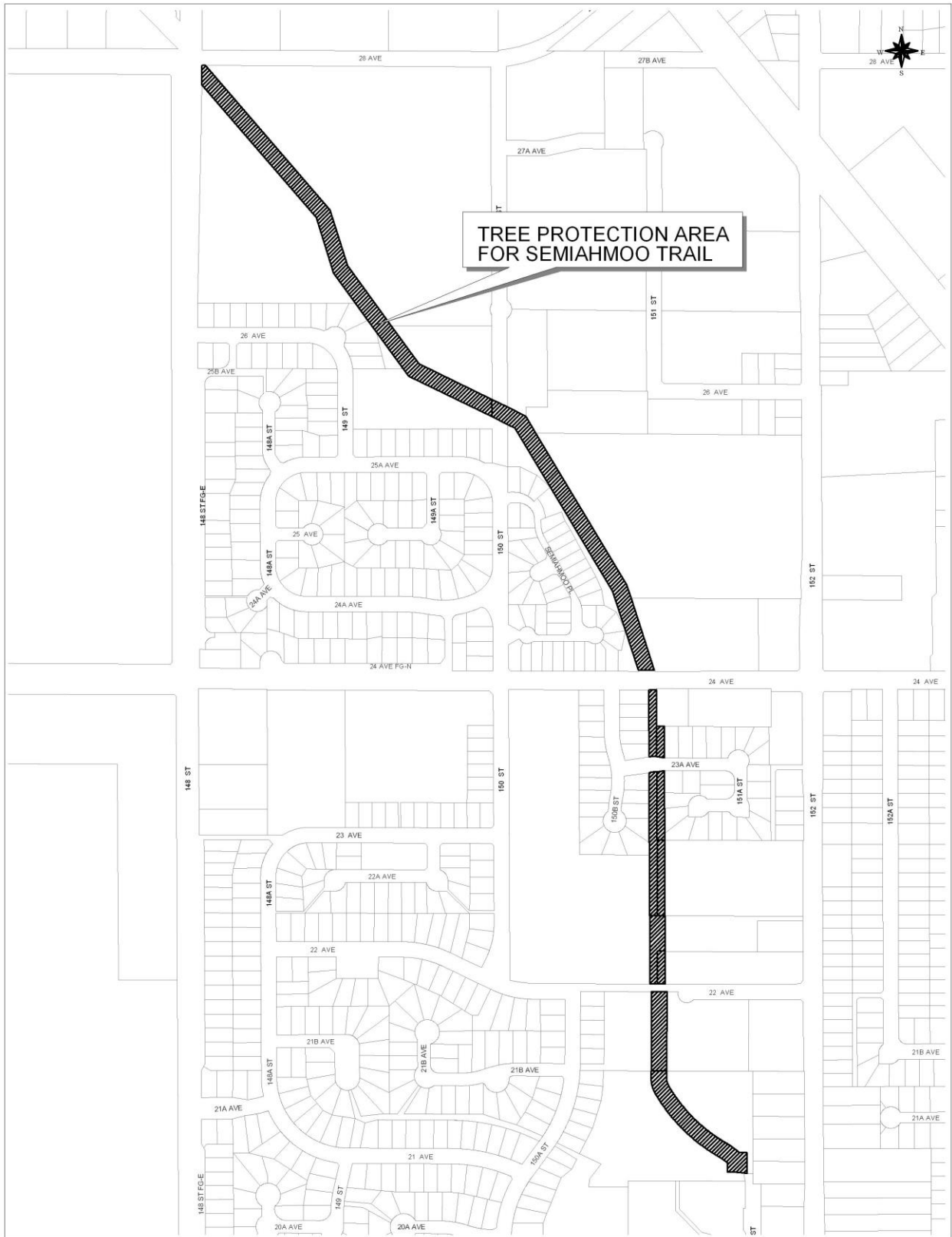

SCHEDULE "C"

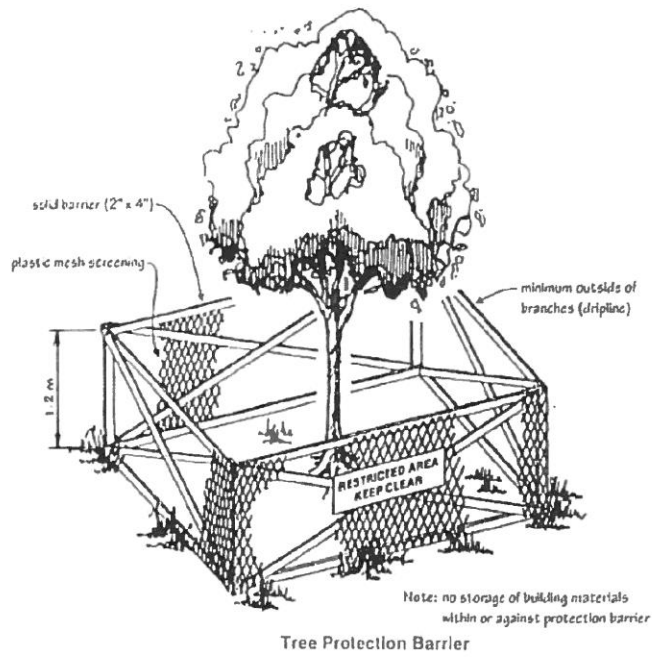

Tree Protection Distance Table

| Trunk Diameter (cm) | Minimum Protection Req'd Around Tree (distance from trunk in metres) |
|---------------------|--|
| 20 | 1.2 |
| 25 | 1.5 |
| 30 | 1.8 |
| 35 | 2.1 |
| 40 | 2.4 |
| 45 | 2.7 |
| 50 | 3 |
| 55 | 3.3 |
| 60 | 3.6 |
| 75 | 4.5 |
| 90 | 5.4 |
| 100 | 6.0 |

Tree Protection Barrier Detail