



PURCHASING SECTION
13450 – 104 Avenue, Surrey BC V3T 1V8
Tel: 604-590-7274
E-mail: purchasing@surrey.ca
ADDENDUM #1

REQUEST FOR QUOTATIONS (RFQ) NO.:	1220-040-2017-001
TITLE:	SECURITY AND PARKING ATTENDANT SERVICES: SURREY MAJOR FESTIVALS
ADDENDUM ISSUE DATE:	January 24, 2017
CLOSING DATE:	prefer to receive Quotations on or before: February 2, 2017

INFORMATION FOR CONTRACTORS

This Addendum is issued to provide additional information to the RFQ for the above named project, to the extent referenced and shall become a part thereof. No consideration will be allowed for extras due to the Contractor not being familiar with this Addendum. This Addendum No. 1 contains seven (7) pages in total.

QUESTIONS AND ANSWERS:

Q1: Can you outline the training or certification requirements for the Parking Attendants. For example do they need to be licensed security, do they to be fully certified traffic control personnel?

A1: The Contractor should provide Parking Attendants with adequate training that will allow them to be able to deliver the Services. The Parking Attendants do not need to be licensed security. Certified traffic control personnel are not required.

Q2: Can you please provide Site open and close times for all events?

A2: The following is the open and close times for all events:

Party for the Planet – Open: 10:00 a.m.; Close: 6:00 p.m.
Canada Day – Open: 10:00 a.m.; Close: 11:00 p.m.
Fusion Festival – Open: 11:00 a.m.; Close: 10:00 p.m.
Tree Lighting Festival – Open: 12:00 p.m.; Close: 7:00 p.m.

Q3: Can you please provide estimated number of security staff for event days, show call only.

A3: The estimated number of hours are listed in Section B-2 – Fees and Payment.

Q4: Can you advise which events will have a liquor license and if so capacity for each liquor area?

A4: The only event that has a licensed liquor area is the Fusion Festival. In 2016, the security personnel required in the licensed liquor area was one (1) supervisor and two (2) security guards.

Q5: Can you please provide event maps?

A5: Event maps are provided in Attachment #1 to this Addendum #1.

END OF ADDENDUM #1

All Addenda will become part of the RFQ Documents.



ATTACHMENT #1

to

ADDENDUM #1

EVENT MAPS

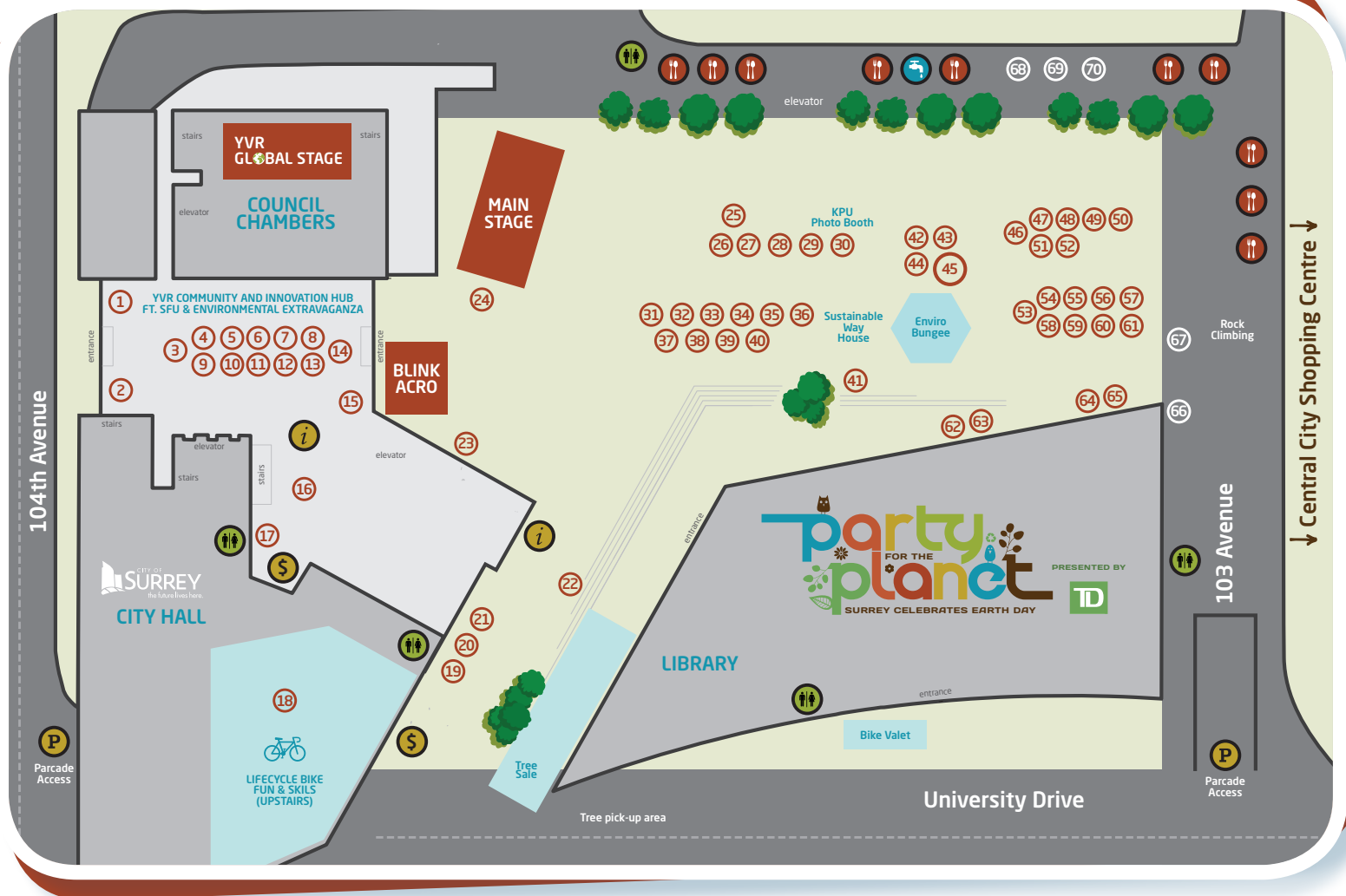

1. Surrey, A Place of Refuge
2. Reptile Exhibit
3. YVR Activation
4. Metro Van Parks
5. Pacific Stream Keepers
6. Surrey Environmental Partners
7. Green Timbers Heritage
8. Environmental Extravaganza
9. Freshwater
10. Village Surrey
11. Coastal Turtle Project
12. Nature Kids BC
13. Naturalists
14. SFU
15. City Speaks
16. GIS Engineering
17. Raptors Birds of Prey
18. Lifecycle Bike Fun & Skills
19. First Aid

20. Security
21. RCMP (Lost Child)
22. Safeway Bike Smoothie Stop
23. Salmon in the City
24. Fortis BC Energy Champions with the BC Lions
25. BC Plant Health Care Inc.
26. TD
27. Toddler Town
28. Downtown Surrey BIA Kids World
29. CUPE 402
30. Ride 2 Survive
31. CTV
32. Regional Recycling
33. 102.7 The Peak/93.7 JRFM
34. Regeneration
35. Encorp Pacific Return
36. Surrey Doors Open
37. Virgin Radio 94.5

38. Heritage Services
39. Landscape Operations & Park Partnerships
40. Surrey Youth Street Squad
41. Artist Merchandise Tent
42. Surrey's Urban Forest
43. Kids Gallery @ Surrey Museum
44. Nature Play
45. Eco Dome ft. The Ta Da Lady
46. Rethink Waste
47. Surrey Int'l Children's Festival
48. Sophie's Place
49. Costco
50. Concord Pacific Photo Booth
51. COS Transportation Tent
52. Light Rail for Surrey
53. Science World On The Road
54. Environmental Art
55. Impulse Chiropractic & Massage Therapy

56. Cindy's Suitcase
57. Marie's Guilt-Free Bakery
58. Surrey Art Gallery
59. Honey Bee Centre
60. Kettle Corn
61. Surrey's Urban Farmers Market
62. HUB Cycling
63. Surrey Food Bank
64. Emotive Car
65. Surrey Fire Services
66. Fire Truck
67. Surrey Fire Services Truck
68. CNG Truck
69. Progressive Waste Solutions
70. Z 95.3/LG 104.3





SURREY FUSION FESTIVAL

Presented By: coastcapital SAVINGS



INFORMATION



TICKETS



BANK MACHINE



WASHROOMS



BIKE LOCKUP



FIRST AID/RCMP



EATING AREA



WATER STATIONS



NEW FOR 2016

1. SURREY HEARING CARE
2. COAST CAPITAL SAVINGS
3. RETURN IT KICK 'N' SORT
4. SFU
6. CONCORD 360 VIRTUAL EXPERIENCE
7. FLIGHT CENTRE
10. INSIGHTS WEST
15. VANCOUVER AQUARIUM AQUA VAN
16. 104.9 KISS FM
17. SURREY FOOD BANK
18. CBC
19. SUPER WHY
20. AGE FRIENDLY COMMUNITY ENGAGEMENT
21. PARKS REC & CULTURE
22. TIMESHARE EXIT TEAM
23. BCAA

24. FLY OVER CANADA
25. PORT OF VANCOUVER
28. SURREY HONDA - CAR GIVEAWAY
30. SOPHIE'S PLACE
31. 93.7 JRFM
32. BC ATHLETICS
33. SURREY WHITE ROCK RINGETTE
34. TODDLER TOWN
35. SNAP
36. SURREY'S TREE TEAM
37. WATER TABLE
40. STORYVILLE
41. DOWNTOWN SURREY BIA KIDS CRAFT ZONE
42. I AM GAME
43. BC GOLF
45. CANADA 150 KICK-OFF
46. PARKS DISPLAY
50. PUBLIC SERVICE ALLIANCE OF CANADA
51. KPU + PHOTO BOOTH
52. IMPULSE CHIROPRACTIC
53. YVR
54. 102.7 THE PEAK
55. METRO VANCOUVER WATER TABLE
58. SURREY FIRE SERVICES



SITE MAP



- | | | | |
|------------------------------------------|---------------------------|------------------------------|---------------------------|
| 2. KPU | 15. Disney's Finding Dory | 28. Age Friendly Community | 41. Berry Go Round |
| 3. KPU Santa Photos | 16. Safeway Treat Zone | 29. Urban Forestry | 42. Vintage Fire Truck |
| 4. Toddler Town | 17. CTV | 30. Surrey Parks | 43. Fire Truck |
| 5. Downtown Surrey BIA Winter Craft Zone | 18. QM/FM | 31. Heritage Hangout | 44. Fire Services |
| 6. Surrey Art Gallery | 19. Encorp Return It | 32. Whalley Little League | 45. Ferris Wheel |
| 7. Artist Check-in | 20. Concord Pacific | 33. Tim Hortons | 46. Toy Drive |
| 8. Snow Globe | 21. Fit for Women Gym | 34. Honeybee Centre | 47. Z 95.3/LG 104.3 |
| 9. Kettle Corn | 22. Sophie's Place | 35. 93.7 JRFM/102.7 The Peak | 48. Surrey Hearing Centre |
| 10. Tim Hortons | 23. The Pulse | 36. SHARP | 49. Triple O's |
| 11. YVR | 24. Canada 150 | 37. Remax Realtor | 50. Taters |
| 12. Coast Capital Savings | 25. Storytime Igloo | 38. Surrey Food Bank | 51. Bobbi's Food Truck |
| 13. Impulse Chiropractor | 26. Christmas Marketplace | 39. Ice Carver | 52. Cannoli King |
| 14. The Surrey Christmas Bureau | 27. Eating Shelter | 40. Road Hockey | 53. Mac & Cheese |
| | | | 54. Wings |
| | | | 55. Grilled Cheese |
| | | | 56. Tin Lizzy Donuts |