



Splash

Michael Krondl



Photo by Michael Krondl

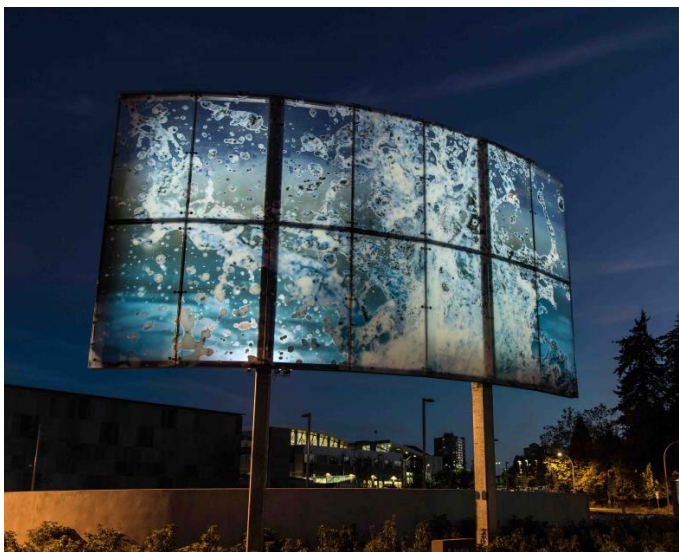

Photo by Michael Krondl

Guildford Recreation and Aquatic Centre, 15105 – 105 Avenue

Splash captures the dynamic moment after someone has just dived or jumped into a pool. This digitally manipulated photograph responds to the neighbourhood of Guildford as the source of the Serpentine River and recalls the history of fountains as the social heart of a city. Krondl says, “I see *Splash* as a modern day equivalent of old world fountains that marked gathering spots where people would come for water but linger to build community.” It also references the family-friendly and sporting activities within the Guildford Aquatic Centre. Unveiled 2014.





Splash

Michael Krondl



Printing of glass panel at Diamond Sea Glazing



Printed glass panels with artist



Installation of the last panel of glass

About the Artist

Michael Krondl specializes in large-scale, site-specific installations that are derived from photographs. He has exhibited widely in North America and Europe.

Artwork Details

The overall artwork measures 5.5 m high X 10.5 m wide. The 14 glass panels each measure 2.65 m x 1.45 m x 25mm and weigh about 2277 kg (500 lbs). The pre-drilled glass panel was “point fixed” to the frame by six stainless steel brackets. The galvanized steel frame was fabricated by Absolute Fabrication Ltd. in three sections and assembled on site. Fast + Epp engineers designed the artwork’s supporting framework, the foundations, and attachment. Lighting was by EOS Lightmedia

Artwork Fabrication

The large photographic transparencies were permanently printed with ceramic pigments by *Diamond Sea Glazing* using a printer specially designed for printing directly onto glass. The printer’s technology is very similar to that used in the standard inkjet. The digitally printed ceramic inks are then fired, much like the glazes on pottery, during the glass tempering process.

Constructed from three laminated pieces of glass, the sheets are printed on two surfaces separated by a clear middle layer. To create a subtle 3D effect, the artist printed the whole image on the front layer but only the splash image on the back layer. The white pigment’s opacity, used to print the foam of the splash, also adds to the 3D effect.

The artist uses a range of transparency to blend perceived real and virtual backgrounds. The image’s blue background transitions to being partially transparent at the top. Depending on the angle and the light, the Guildford Aquatic Centre or the sky are visible through the upper panels.

